



Jordan fishwick

MANCHESTER
Upper Moss Lane



**Upper Moss Lane, Manchester
M15 5JG**
Price £215,000



The Property

Video viewing available - <https://www.youtube.com/watch?v=2dwwkCg2x1IU>

Jordan Fishwick are pleased to offer for sale this well presented THREE BEDROOM semi detached property in Hulme. The property is about 20 minutes walk from Manchester City centre amenities as well as having Hulme high street on your door step. The property briefly comprises: entrance hall with downstairs W/C, living room, kitchen/diner, access to rear garden and storage shed. To the first floor, it has been slightly reconfigured to suit the current owner to offer master bedroom, then second bedroom with office area/walk in wardrobe, which was originally the third bedroom. There is a secure allocated parking spot to the rear. Ample loft

storage.

Directions

Upper Moss Street is located just a short walk away from Stretford Road and offers easy access to Manchester City Centre.

- Three Bedroom Semi-Detached
- Well Presented
- Modern Build
- Nice West Facing Garden
- Secure Allocated Parking
- On Street Parking Available
- Leasehold

Postcode - M15 5JG

EPC Rating - C

Floor Area - sq ft

Local Authority - Manchester Council

Council Tax - Band B



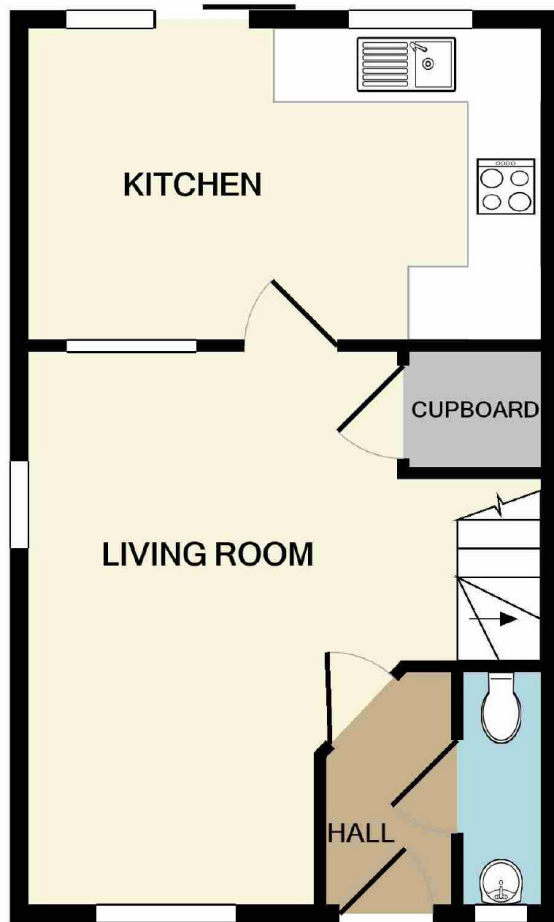

GROUND FLOOR

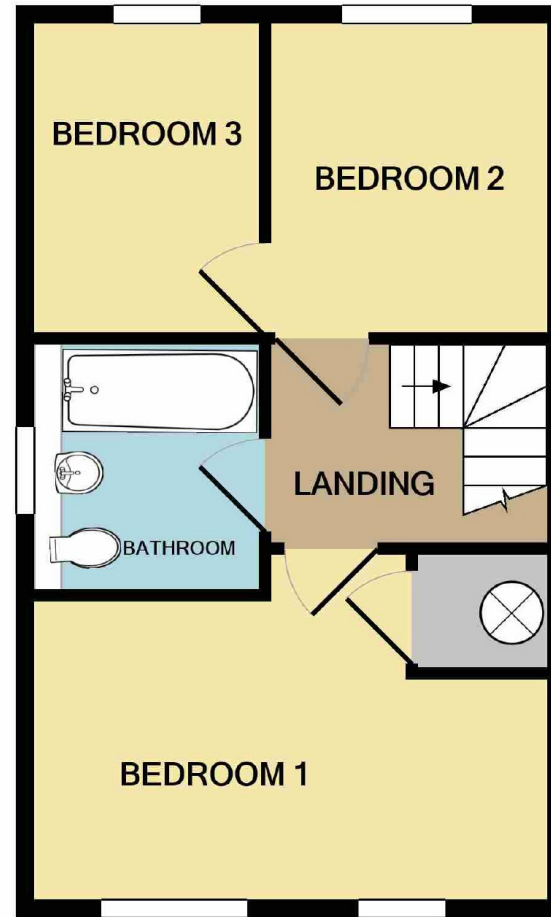

1ST FLOOR

Measurements are approximate. Not to scale. Illustrative purposes only
Made with Metropix ©2020