

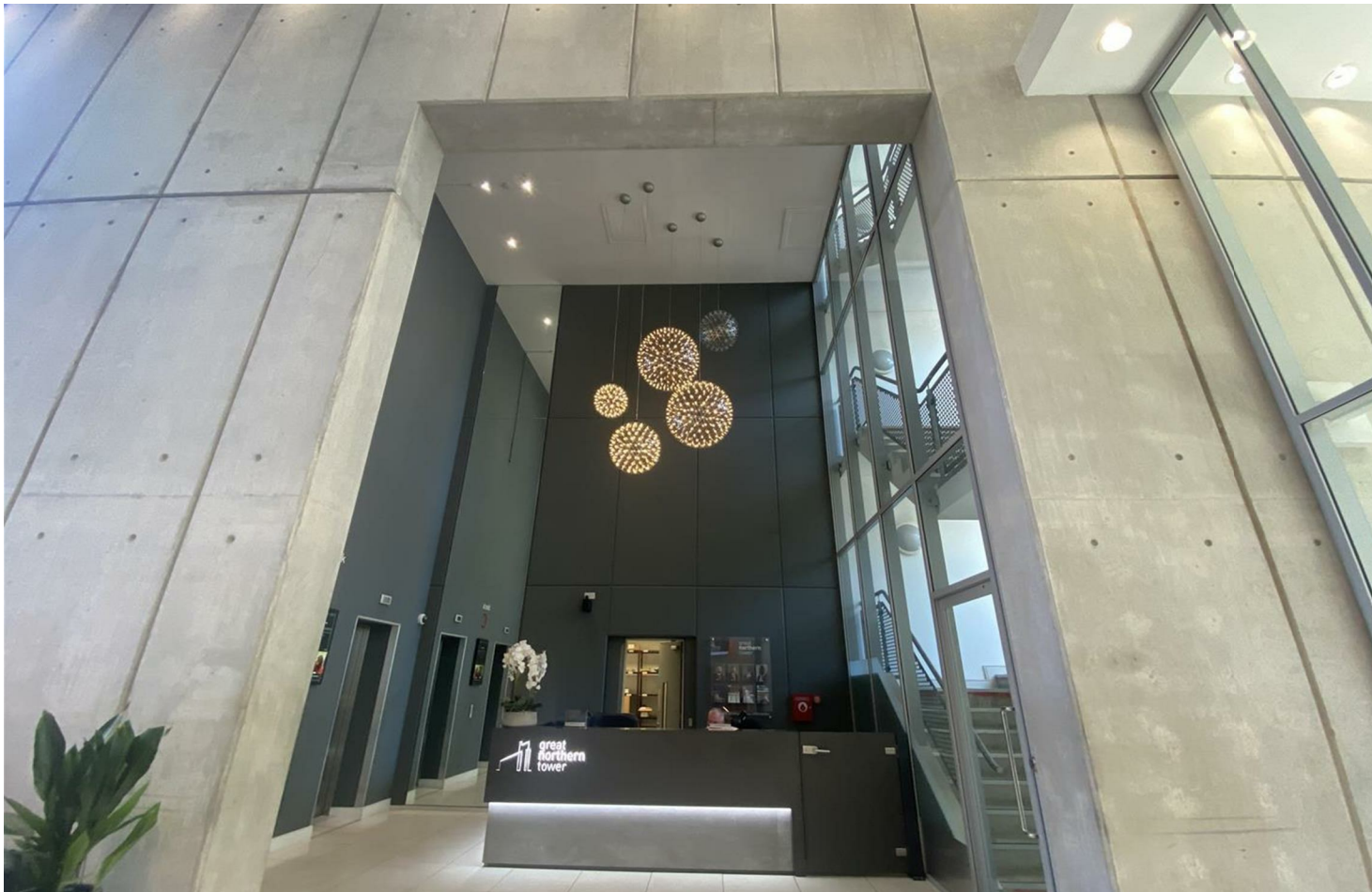

*jordan fishwick*

Apt AP08 Great Northern Tower, 1 Watson  
Guide Price £1,075 Per Calendar Month



## Great Northern Tower Manchester M3 4EE

£1,075 Per Calendar Month



### The Property

Available Late July. This one bed podium level apartment is in the popular Great Northern Tower development, being one of the most central developments in the city centre with a 24 hour concierge. The property is located Entrance hall with deep storage, living/kitchen with laminate flooring, fitted kitchen with appliances, large double bedroom and attractive shower room with double shower. Furnished. EPC Rating C. No pets. 12 MONTH CONTRACT MINIMUM. Tax Band C.

\*PHOTO/VIDEO OFFERS NOT ACCEPTED - PLEASE CALL TO BOOK A VIEWING\*

- Available Late July
- Central Location, just off Deansgate
- 24 Hour Concierge On Site
- Fully Furnished
- No Parking
- EPC Rating C
- Council Tax Band C
- Close to City Centre
- Great for Professionals



Energy Efficiency Rating		
	Current	Potential
Very energy efficient - lower running costs		
(92 plus) A		
(81-91) B		
(69-80) C	76	83
(55-68) D		
(39-54) E		
(21-38) F		
(1-20) G		
Not energy efficient - higher running costs		
England & Wales	EU Directive 2002/91/EC	





These particulars are believed to be accurate but they are not guaranteed and do not form a contract. Neither Jordan Fishwick nor the vendor or lessor accept any responsibility in respect of these particulars, which are not intended to be statements or representations of fact and any intending purchaser or lessee must satisfy himself by inspection or otherwise as to the correctness of each of the statements contained in these particulars. Any floorplans on this brochure are for illustrative purposes only and are not necessarily to scale.

Offices at: Chorlton, Didsbury, Disley, Hale, Glossop, Macclesfield, Manchester Deansgate, Manchester Whitworth Street, New Mills, Sale, Wilmslow and Withington