



Apt 202 Advent House 2, 1 Isaac Way, New Islington, Manchester, M4 7EF

EWS1 IN PLACE

Jordan Fishwick are pleased to offer for sale this 5th floor apartment at Advent 2 in New Islington, which is a short distance from Piccadilly Station. The apartment comprises of entrance hall with laminate flooring, living room with sliding patio doors opening to the Juliet balcony, open with kitchen, two double bedrooms, master benefitting from en-suite wet room. There is also a main three piece bathroom suite with shower over the bath and tiled walls and floor. The apartment has been rented for many years and requires some minor renovation. NO ONWARD CHAIN.

Offers In Excess Of £180,000

Viewing arrangements

Viewing strictly by appointment through the agent

245 Deansgate, Manchester, M3 4EN 0161 833 9499 opt 3

Entrance Hall

Wooden flooring. Spotlights. Access to all rooms.

Living Room/Kitchen

23'9" x 22'9"

Range of wall and base units with worktops over. Integrated fridge/freezer, cooker with hob and extractor over. Sink with mixer tap. Wall mounted heater. Spotlights. TV and telephone points. Juliet balcony. Storage cupboard.

Bedroom One

11'5" x 8'5"

Fitted carpet. Wall mounted heater. Wall and spotlights.

En-suite

Tiled wet room. Low level w/c. Sink with mixer tap. Rainhead shower.

Bedroom Two

13'4" x 8'1"

Fitted carpet. Wall mounted heater. Wall and spotlights.

Bathroom

Low level w/c. Bath with mixer tap. Sink with mixer tap. Heated towel rail.

Externally

Lifts to all floors.

Additional Information

Ground rent - £150 per annum

Service charges - £2,633.44 per annum

Lease - 250 years from 1 January 2003

Council Tax Band C

Management company - Urban Bubble

Agent Note

To be able to purchase a property in the United Kingdom all agents have a legal requirement to conduct Identity checks on all customers involved in the transaction to fulfil their obligations under Anti Money Laundering regulations. We outsource this check to a third party and a charge will apply. Ask the branch for further details.

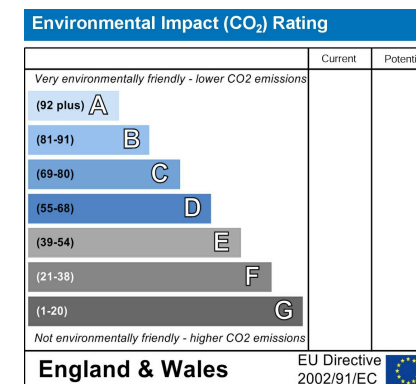
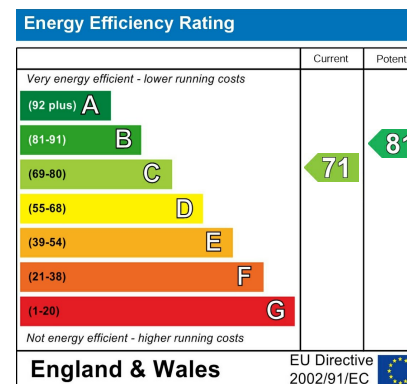



5TH FLOOR

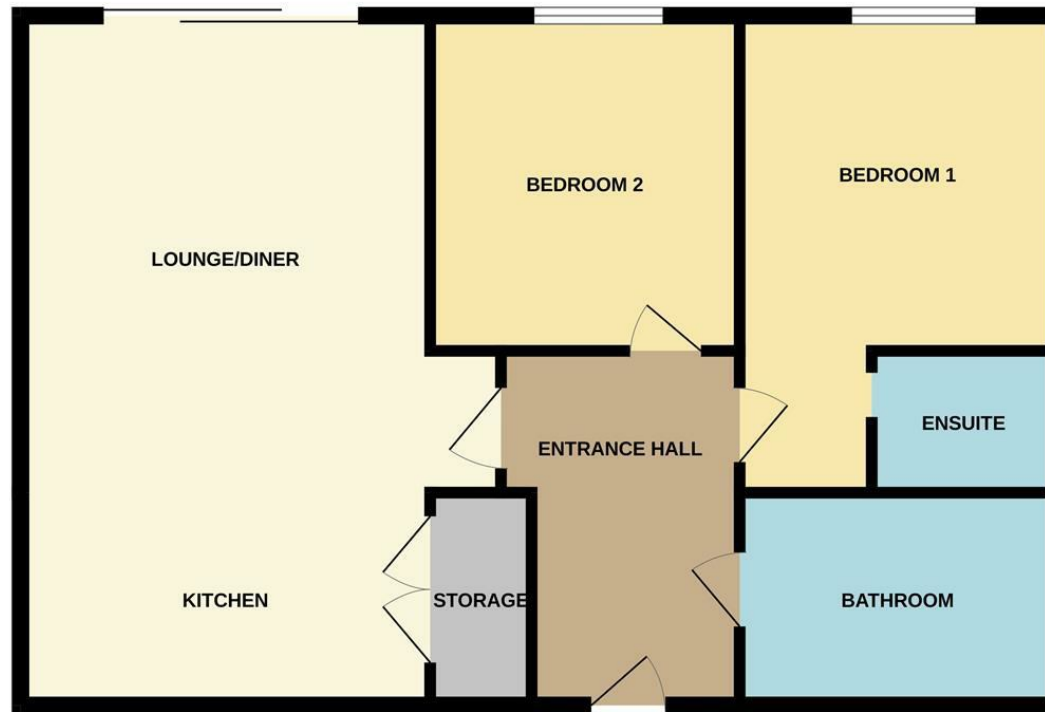

Measurements are approximate. Not to scale. Illustrative purposes only
Made with Metropix ©2023



These particulars are believed to be accurate but they are not guaranteed and do not form a contract. Neither Jordan Fishwick nor the vendor or lessor accept any responsibility in respect of these particulars, which are not intended to be statements or representations of fact and any intending purchaser or lessee must satisfy himself by inspection or otherwise as to the correctness of each of the statements contained in these particulars. Any floorplans on this brochure are for illustrative purposes only and are not necessarily to scale.

Offices at: Chorlton, Didsbury, Disley, Hale, Glossop, Macclesfield, Manchester Deansgate, Manchester Whitworth Street, New Mills, Sale, Wilmslow and Withington

245 Deansgate, Manchester, M3 4EN

0161 833 9499 opt 3

manchester@jordanfishwick.co.uk

www.jordanfishwick.co.uk

