



Apt 5 New Little Mill, Radium Street, Ancoats, Manchester, M4 6GH

Jordan Fishwick are pleased to offer for sale this charming ground floor apartment located in the vibrant area of Ancoats. This delightful property boasts a spacious layout, featuring a generously sized open plan kitchen/reception room and a comfortable bedroom with fitted wardrobes, making it an ideal choice for individuals or couples seeking a stylish urban retreat.

As you enter, you will be greeted by the characterful exposed brickwork that adds a touch of warmth and sophistication to the living space. The large living area provides ample room for relaxation and entertaining, allowing you to create a welcoming atmosphere for friends and family. The bedroom is equally spacious, ensuring a restful haven at the end of a busy day and also offers access to the Jack and Jill shower room.

Situated in a great central location, this apartment offers easy access to a variety of local amenities, including shops, cafes, and restaurants, all within a short stroll. Ancoats is known for its rich history and vibrant community, making it a sought-after area for those looking to immerse themselves in city life.

This property presents an excellent opportunity for anyone looking to enjoy the convenience of apartment living in a lively neighbourhood. With its unique features and prime location, this apartment is not to be missed. Come and experience the charm of New Little Mill for yourself.

Offers In Excess Of £240,000

Viewing arrangements

Viewing strictly by appointment through the agent

245 Deansgate, Manchester, M3 4EN 0161 833 9499 opt 3

Living Room/Kitchen

25'8" x 12'8"

Range of wall and base units with complimentary worktops over. Sink with mixer tap. Integrated fridge/freezer and dishwasher. Cooker and hob with extractor over. Solid wood flooring. Wall mounted electric heater. TV and telephone point. Spotlights. Cupboard housing washing machine.

Bedroom

17'1" x 9'3"

Fitted carpet. Spotlights. Wall mounted heater. Fitted wardrobes. Door leading to shower room.

Shower Room

Partially tiled shower suite. Low level w/c. Sink with mixer

tap. Shower cubical with mixer shower. Shaver point. Heated towel rail.

Externally

Bike store. Concierge available Mon - Sat 8am - 5pm. Lifts to all floors. Gated community.

Additional Information

250 year lease from September 2020

Service Charge: £2831 per annum

Ground Rent: £200 per annum

Managing agents - Zenith

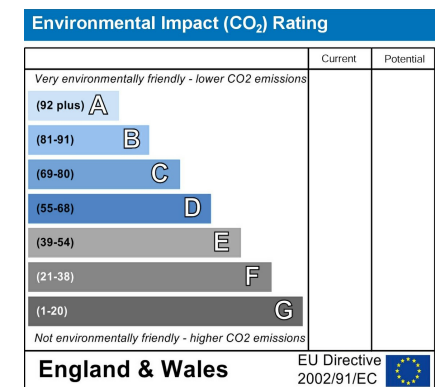
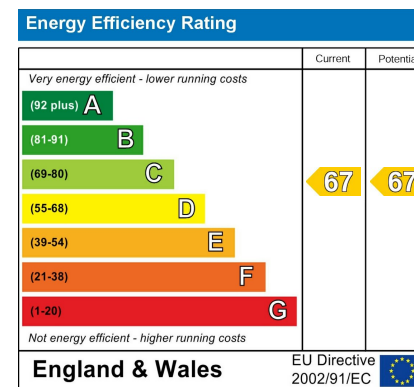



GROUND FLOOR

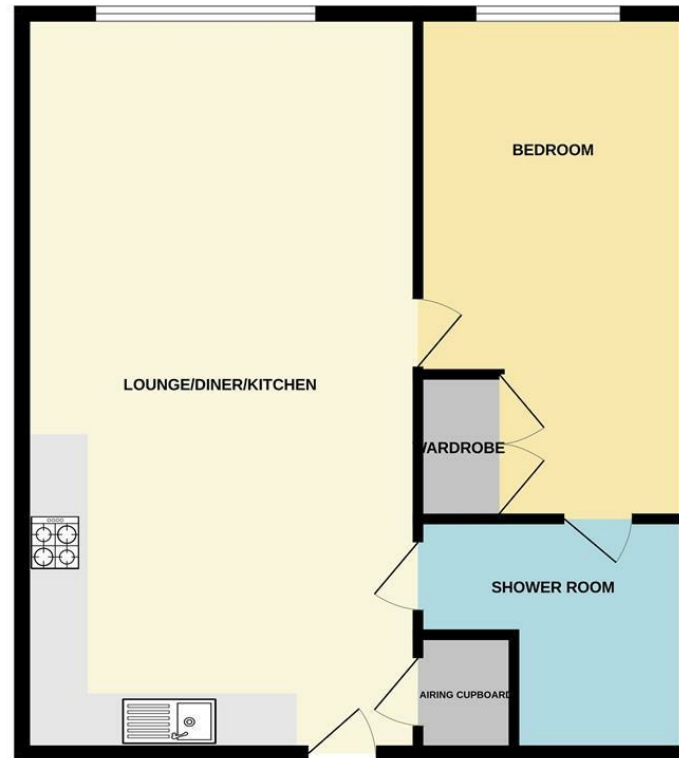

Measurements are approximate. Not to scale. Illustrative purposes only.
Made with Metropix ©2025



These particulars are believed to be accurate but they are not guaranteed and do not form a contract. Neither Jordan Fishwick nor the vendor or lessor accept any responsibility in respect of these particulars, which are not intended to be statements or representations of fact and any intending purchaser or lessee must satisfy himself by inspection or otherwise as to the correctness of each of the statements contained in these particulars. Any floorplans on this brochure are for illustrative purposes only and are not necessarily to scale.

Offices at: Chorlton, Didsbury, Disley, Hale, Glossop, Macclesfield, Manchester Deansgate, Manchester Whitworth Street, New Mills, Sale, Wilmslow and Withington

245 Deansgate, Manchester, M3 4EN

0161 833 9499 opt 3

manchester@jordanfishwick.co.uk

www.jordanfishwick.co.uk

