



*jordan fishwick*



# 14 Bothwell Road, Manchester, M40 7PA

Welcome to Bothwell Road, Manchester - a charming location for this stunning four-bedroom semi-detached house. This modern build property boasts a spacious reception room, perfect for entertaining guests or relaxing with family along with a kitchen diner. With two bathrooms plus downstairs toilet, there will be no more queuing in the morning rush.

The property features a lovely green park to the front, providing a picturesque view and a peaceful atmosphere. The convenience of a driveway ensures parking is never an issue, with space for one vehicle.

This house is ideal for those looking for a comfortable and contemporary living space. The four well-proportioned bedrooms offer plenty of room for a growing family or for guests to stay over. The two bathrooms add a touch of luxury and practicality to everyday living.

Don't miss the opportunity to make this house your home. Contact us today to arrange a viewing and experience the charm of Bothwell Road for yourself.

## Price £425,000

### Viewing arrangements

Viewing strictly by appointment through the agent  
245 Deansgate, Manchester, M3 4EN 0161 833 9499 opt 3

#### Entrance Hall

Amtico flooring. Access to all ground floor rooms. Storage cupboard.

#### Lounge

16'4" x 12'7"

Amtico flooring. Door leading to garden. Ceiling light. TV point. Radiator.

#### Kitchen/Diner

14'7" x 9'1"

Range of wall and base units with worktops over. Integrated appliances including fridge/freezer, dishwasher. Space and plumbing for washing machine. Oven with hob over and extractor fan. Sink with mixer tap. Amtico flooring. Spotlights. Radiator.

#### W/C

Amtico flooring. Low level W/C. Sink with mixer tap. Window.

#### Bedroom One

17'9" x 12'5"

Fitted carpet. Ceiling light. Radiator. Built in cupboard.

#### Dressing Area

9'4" x 8'10"

Space for wardrobes and dressing table.

#### En-suite

Tiled en-suite with low level W/C, sink with mixer tap, shower cubical with mixer shower. Heated towel rail. Window.

## Bedroom Two

13'8" x 8'10"

Fitted carpet. Ceiling light. Radiator.

## Bedroom Three

13'5" x 7'1"

Fitted carpet. Ceiling light. Radiator.

## Bedroom Four

9'4" x 8'8"

Fitted carpet. Ceiling light. Radiator.

## Bathroom

Tiled bathroom suite with low level W/C, sink with mixer tap, bath with mixer shower over. Vanity cupboard with mirror. Shaver point. Heated towel rail. Window.

## Externally

Enclosed rear garden. Driveway to rear.

## Additional Information

Service Charge: None payable

Ground Rent: £200 per annum

Lease: : 250 years from January 2017

Developer - Lovell

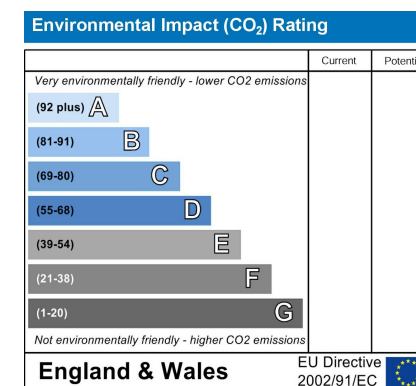
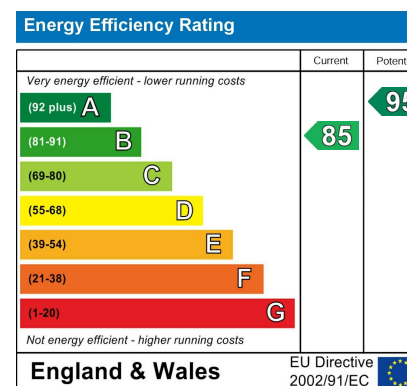





GROUND FLOOR

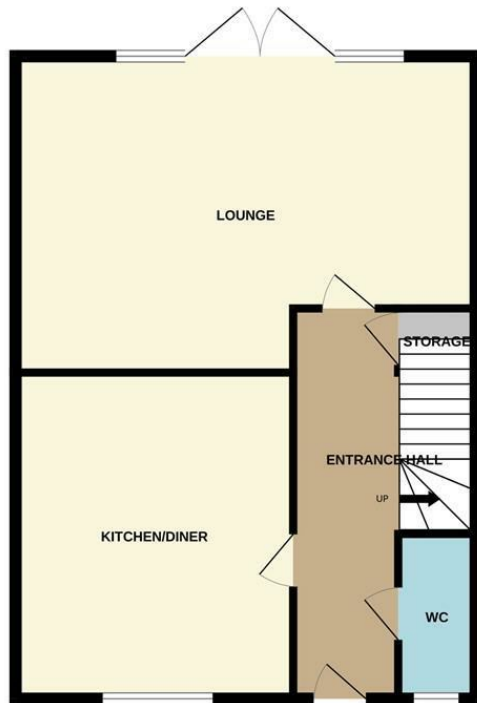

1ST FLOOR



2ND FLOOR



Measurements are approximate. Not to scale. Illustrative purposes only  
Made with Metropix ©2024



These particulars are believed to be accurate but they are not guaranteed and do not form a contract. Neither Jordan Fishwick nor the vendor or lessor accept any responsibility in respect of these particulars, which are not intended to be statements or representations of fact and any intending purchaser or lessee must satisfy himself by inspection or otherwise as to the correctness of each of the statements contained in these particulars. Any floorplans on this brochure are for illustrative purposes only and are not necessarily to scale.

Offices at: Chorlton, Didsbury, Disley, Hale, Glossop, Macclesfield, Manchester Deansgate, Manchester Whitworth Street, New Mills, Sale, Wilmslow and Withington

245 Deansgate, Manchester, M3 4EN

0161 833 9499 opt 3

[manchester@jordanfishwick.co.uk](mailto:manchester@jordanfishwick.co.uk)

[www.jordanfishwick.co.uk](http://www.jordanfishwick.co.uk)

