



Apt 307 The Lock Building, 41 Whitworth Street West, Manchester, M1 5BD

** CASH BUYING INVESTORS ONLY - WE AWAIT THE START DATE FOR CLADDING WORKS AND THE PROPERTY IS TENANTED UNTIL MAY 2025 **

Jordan Fishwick are pleased to offer for sale this large THREE BEDROOM apartment located in the heart of Central Manchester, just a 2 minute walk from Oxford Rd. The apartment is located on the third floor of the development and boasts water views from the balcony, lifts to all floors and a 24 hour concierge. The apartment briefly comprises of: entrance hall with utility room, open plan living room/kitchen leading to balcony, 2 double bedrooms, master with en-suite, small double room, and a well appointed bathroom. NO ONWARD CHAIN. NO PARKING. Rented for £1700pcm.

The cladding remediation works are fully funded by the developer, Dandara. We are inviting mortgage buyers due to the most recent announcement by the 6 big lenders advising they are starting to lend on buildings over 18m without and EWS1. Please take advice from mortgage lender or speak to branch to discuss.

Price £280,000

Viewing arrangements

Viewing strictly by appointment through the agent
245 Deansgate, Manchester, M3 4EN 0161 833 9499 opt 3

Entrance Hall

Wooden flooring. Intercom system. Spotlights. Utility room housing washing machine. Wall mounted heater.

Living Room/Kitchen

28'3" x 8'5"

Range of wall and base units with complimentary worktops over. Integrated dishwasher, cooker with hob and extractor over. Freestanding fridge/freezer. Spotlights. Laminate flooring. Wall mounted heater.

Bedroom One

10'10" x 10'1"

Fitted carpet. Spotlights. Wall mounted heater.

En-suite

Low level w/c. Sink with mixer tap. Shower with mixer shower. Mirror. Spotlight.

Bedroom Two

26'5" x 8'5"

Wooden flooring. Spotlights. Wall mounted heater.

Bedroom Three

9'3" x 5'11"

Fitted carpet. Spotlights.

Bathroom

Low level w/c. Sink with mixer tap. Bath with mixer shower. Mirror. Spotlights. Heated towel rail.

Externally

Balcony with water views. Lifts to all floors. 24 hour concierge. NO PARKING.

Additional Information

Ground rent - £350 per annum

Service Charges - £5156 per annum

Lease - 125 years from 2002

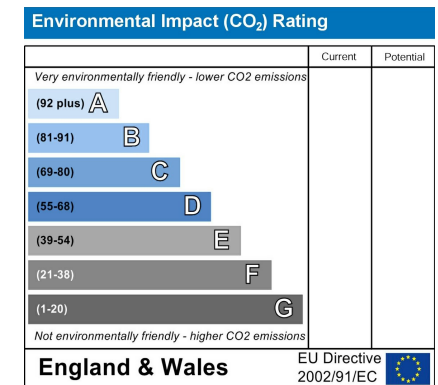
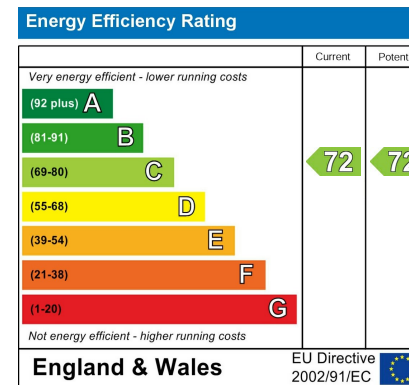

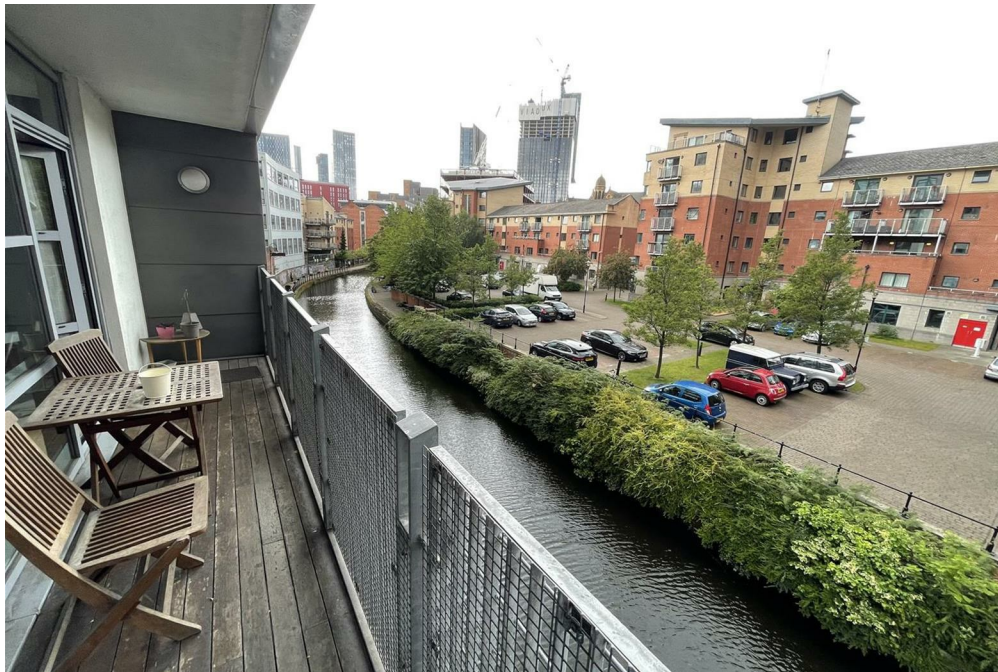

THIRD FLOOR

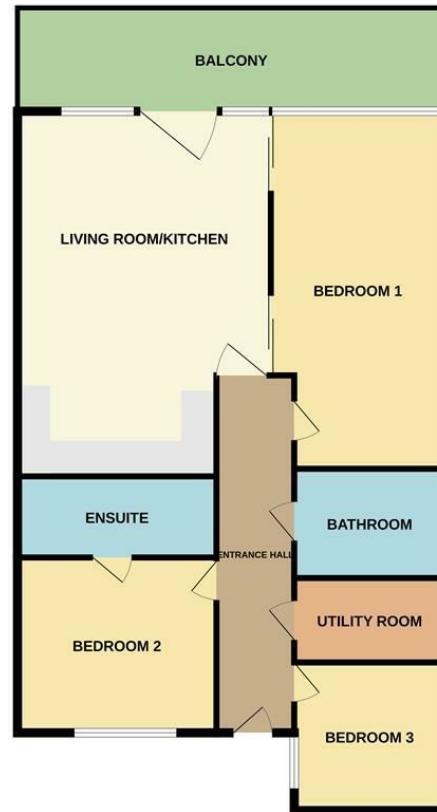

Measurements are approximate. Not to scale. Illustrative purposes only.
Made with Metropix ©2023



These particulars are believed to be accurate but they are not guaranteed and do not form a contract. Neither Jordan Fishwick nor the vendor or lessor accept any responsibility in respect of these particulars, which are not intended to be statements or representations of fact and any intending purchaser or lessee must satisfy himself by inspection or otherwise as to the correctness of each of the statements contained in these particulars. Any floorplans on this brochure are for illustrative purposes only and are not necessarily to scale.

Offices at: Chorlton, Didsbury, Disley, Hale, Glossop, Macclesfield, Manchester Deansgate, Manchester Whitworth Street, New Mills, Sale, Wilmslow and Withington

245 Deansgate, Manchester, M3 4EN

0161 833 9499 opt 3

manchester@jordanfishwick.co.uk

www.jordanfishwick.co.uk

