

HARWOOD

THE ESTATE AGENT

01952 881010

Potters Cottage, The Mines, Benthall TF12 5QY



£ 2 0 8 , 0 0 0 region

This charming two-bedroom end-of-terrace home is nestled within a small, semi-rural development, offering a peaceful setting while still being conveniently close to local amenities. Ideal for first-time buyers, downsizers, or investors, the property combines modern comfort with a touch of countryside charm. The well-presented accommodation comprises a welcoming lounge, a spacious kitchen/diner with ample storage and space for entertaining, two good-sized bedrooms, and a stylish family bathroom. Neutral décor throughout provides a warm and inviting feel, with plenty of natural light enhancing the living spaces. Externally, the property benefits from two allocated parking spaces and a private, low-maintenance rear garden—perfect for relaxing or enjoying a spot of outdoor dining. The garden is securely enclosed, making it suitable for children or pets. Situated on the edge of Broseley, the home is well-placed for access to a wide range of local amenities including shops, cafés, pubs, and schools. For those who enjoy the outdoors, there are numerous scenic country walks nearby, offering the perfect balance between town convenience and rural tranquillity.

Energy Efficiency Rating

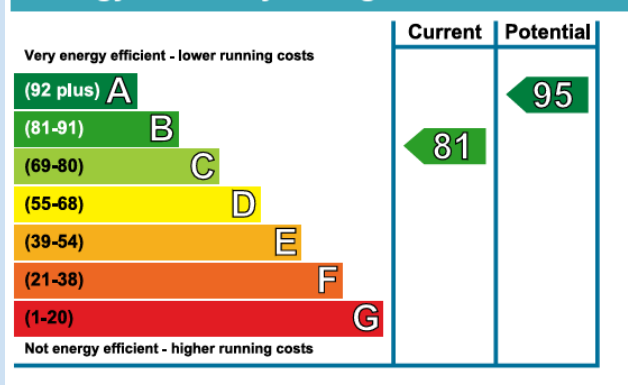





Ground Floor: 28.3 m² = 304.62 ft²

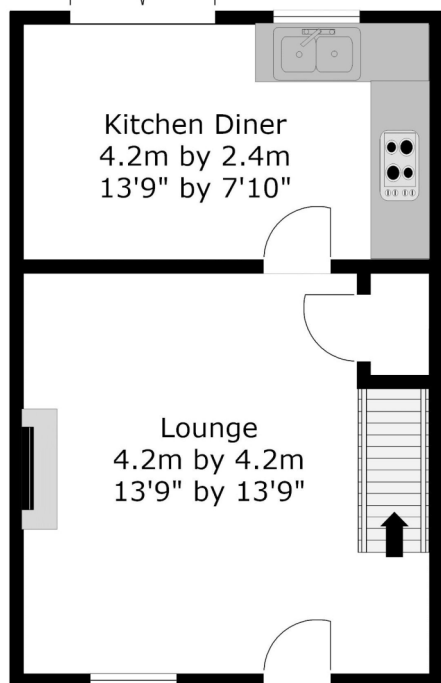

First Floor: 28.3 m² = 304.62 ft²

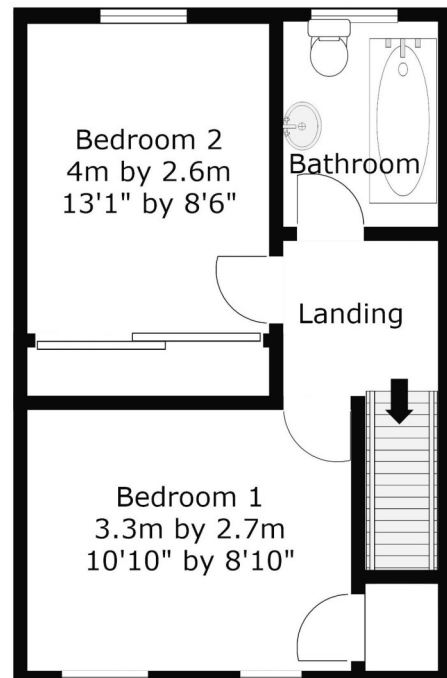

Tenure Freehold

Council tax Band B

Fixtures & Fittings Where specifically mentioned in these sales particulars are included in the sale price.

N.B Please note, that none of the services, heating systems or any appliances at this property have been tested, therefore no warranty can be given or implied as to their working order. These particulars do not constitute or form a part of any contract. Whilst Harwood Estate Agents and their employees take every care in the preparation of these particulars they hereby state both on behalf of themselves and the vendor that no intending purchaser should rely on any of the statements of representation of fact and the intending purchaser should make his/her own inspection and enquiries in order to satisfy himself/herself of their authenticity and no responsibility is accepted for any error or omission herein.

Details prepared : 22nd April 2025