

HARWOOD

THE ESTATE AGENT

01952 881010

15 Windsor Crescent, Broseley TF12 5PG



£ 1 7 9, 9 5 0 region

This two bedroom semi detached property offers easy access to local schooling and amenities and is located in a well established residential area.

The accommodation includes a well proportioned living room, and a kitchen/diner with adjacent utility. The first floor features two bedrooms and a shower room. Externally there is driveway parking to the front, and a generous garden to the rear with patio area, lawn and useful garden shed.

Score	Energy rating	Current	Potential
92+	A		
81-91	B		90 B
69-80	C		
55-68	D	66 D	
39-54	E		
21-38	F		
1-20	G		





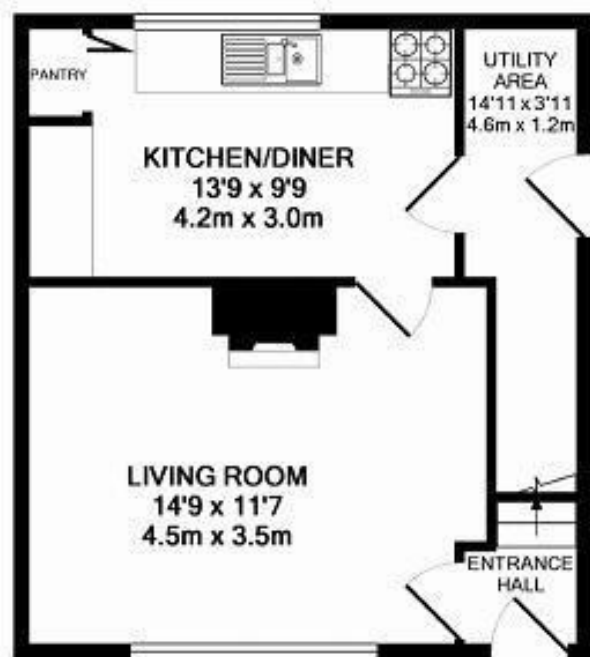

GROUND FLOOR
APPROX. FLOOR
AREA 351 SQ.FT.
(32.6 SQ.M.)

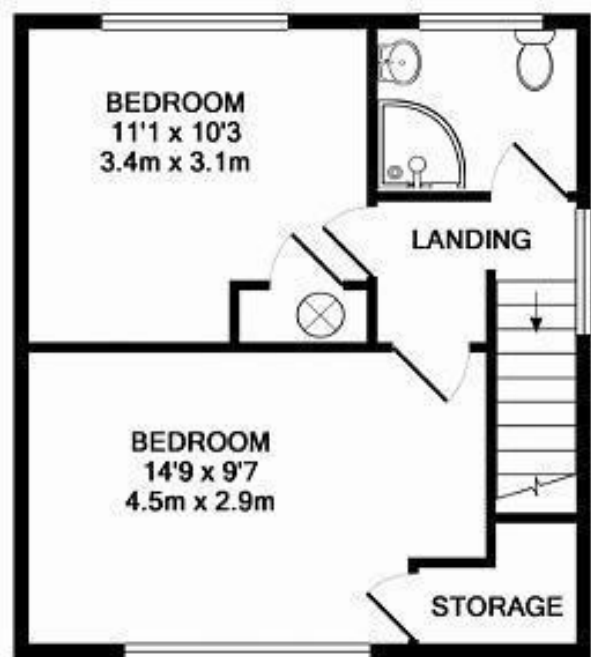

1ST FLOOR
APPROX. FLOOR
AREA 351 SQ.FT.
(32.6 SQ.M.)

TOTAL APPROX. FLOOR AREA 702 SQ.FT. (65.2 SQ.M.)

Whilst every attempt has been made to ensure the accuracy of the floor plan contained here, measurements of doors, windows, rooms and any other items are approximate and no responsibility is taken for any error, omission, or mis-statement. This plan is for illustrative purposes only and should be used as such by any prospective purchaser. The services, systems and appliances shown have not been tested and no guarantee as to their operability or efficiency can be given.

Made with Metropix ©2016

Tenure Freehold **Council tax** A

Fixtures & Fittings Where specifically mentioned in these sales particulars are included in the sale price.

N.B Please note, that none of the services, heating systems or any appliances at this property have been tested, therefore no warranty can be given or implied as to their working order. These particulars do not constitute or form a part of any contract. Whilst Harwood Estate Agents and their employees take every care in the preparation of these particulars they hereby state both on behalf of themselves and the vendor that no intending purchaser should rely on any of the statements of representation of fact and the intending purchaser should make his/her own inspection and enquiries in order to satisfy himself/herself of their authenticity and no responsibility is accepted for any error or omission herein.

Details prepared : 16th July 2024