

Oakdene Road

Hillingdon • Middlesex • UB10 0SQ

Offers In Excess Of: £425,000



coopers
est 1986

Oakdene Road

Hillingdon • Middlesex • UB10 0SQ

A three bedroom, mid-terraced house situated on Oakdene Road, a sought after road within the Oak Farm offering access to a number of local amenities. Hillingdon's Metropolitan/Piccadilly line train station and a number of highly regarded schools. The A40/ M40 with its links to London and the Home Counties are a short drive away along with Uxbridge town centre. The ground floor of the property comprises 12ft living room and 10ft kitchen and family bathroom. To the first floor is the 15ft main bedroom with fitted storage, 9ft second bedroom and 6ft third bedroom. Outside, there is off street parking and an landscaped private rear garden

Three bedroom house

Mid terrace

Oak Farm

Potential to extend (S.T.P)

No onward chain

12ft living room

10ft kitchen

15ft main bedroom with fitted storage

Private rear garden

Off street parking

These particulars are intended as a guide and must not be relied upon as statements of fact. Your attention is drawn to the Important Notice on the last page.





GROUND FLOOR
312 sq.ft. (29.0 sq.m.) approx.

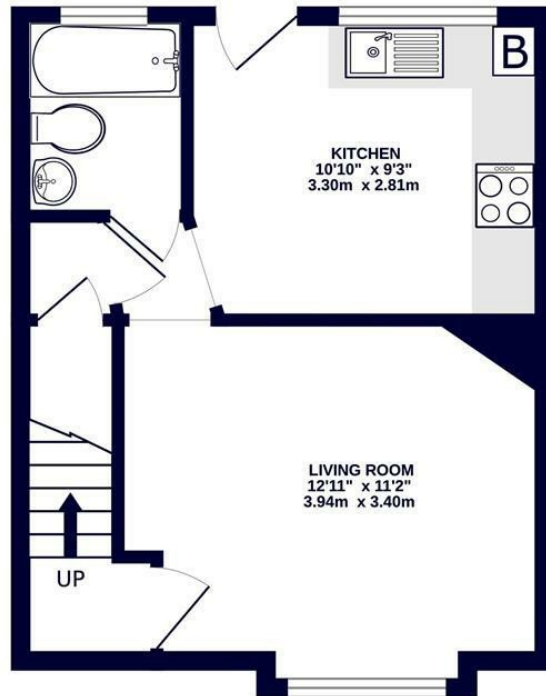

1ST FLOOR
308 sq.ft. (28.6 sq.m.) approx.

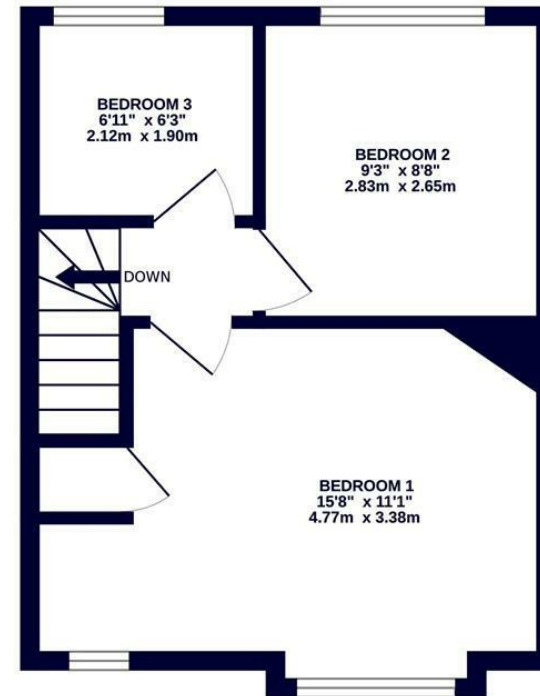

coopers
est 1986

TOTAL FLOOR AREA : 620 sq.ft. (57.6 sq.m.) approx.

Whilst every attempt has been made to ensure the accuracy of the floorplan contained here, measurements of doors, windows, rooms and any other items are approximate and no responsibility is taken for any error, omission or mis-statement. This plan is for illustrative purposes only and should be used as such by any prospective purchaser. The services, systems and appliances shown have not been tested and no guarantee as to their operability or efficiency can be given.
Made with Metropix ©2025



coopers
est 1986

**109 Hillingdon Hill, Hillingdon Village,
Middlesex, UB10 0JQ**
hillingdon@coopersresidential.co.uk

CoopersResidential.co.uk

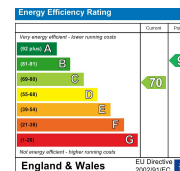

Important Notice: These particulars, whilst believed to be accurate are set out as a general outline only for guidance and do not constitute any part of an offer or contract. Intending purchasers should not rely on them as statements or representation of fact, but must satisfy themselves by inspection or otherwise has the authority to make or give any representation or warranty in respect of the property.