

Oak Point Court, Sutton Court

Hillingdon • Middlesex • UB10 9HR
Offers In Excess Of: £285,000



coopers
est 1986

Oak Point Court, Sutton Court

Hillingdon • Middlesex • UB10 9HR

A luxury one bedroom first floor apartment situated within the contemporary Oak Point Court development built by Clearview Homes in 2018 which is conveniently situated off Long Lane within walking distance of Hillingdon tube, bus/road links and a number of amenities. The property is accessed via a communal entryphone system that leads into a stylish entrance lobby with both stairs and lifts to the first floor. Once inside the immaculately maintained property there is a spacious hallway that leads into the 28ft kitchen/living/dining area with a door leading onto the balcony, 12ft bedroom with fitted wardrobes and family bathroom. Outside there are well kept communal gardens and a parking space.

One bedroom apartment

First floor

Immaculately kept

Convenient location

Metropolitan and Piccadilly line

28ft kitchen/living/dining area

12ft master bedroom

Communal garden and allocated parking

Balcony

513 sq ft

These particulars are intended as a guide and must not be relied upon as statements of fact. Your attention is drawn to the Important Notice on the last page.





Directions

From leaving our office on Hillingdon Hill proceed left to the second set of traffic lights and turn left onto Long Lane. Take the fifth turning on your right onto Sutton Court Road.

Situation

Oak Point is situated just off Long Lane with its multitude of facilities close at hand. Hillingdon tube station with its Metropolitan and Piccadilly lines offers direct access to Baker Street in approx. 36 minutes and is less than a mile away with buses from close by. Hillingdon's location just off the A437 means easy access to the M40, M4 and M25 with London Heathrow Airport only six miles away. For everyday convenience, Oak Point excels. Sutton Court Road has a parade of useful shops including a newsagent and pharmacy. There is a library within walking distance, four GP practices and two dentists within about a mile, while Hillingdon Hospital (with A&E) and Uxbridge Town centre with its multitude of bars, restaurants and shopping centres are just over a mile away. There are a number of sought after schools for all ages within walking distance.

Description

A luxury one bedroom first floor apartment situated within the contemporary Oak Point Court development built by Clearview Homes in 2018. The property is accessed via a communal entryphone system that leads into a stylish entrance lobby with both stairs and lifts to the first floor. Once inside the immaculately maintained property there is a spacious hallway that leads into the 28ft kitchen/living/dining area with a door leading onto the balcony, 12ft bedroom with fitted wardrobes and family bathroom.

Outside

There is a communal garden along with an allocated parking space.



Schools:

Swakeleys Senior School for Girls 0.2 miles
St Bernadette Catholic Primary School 0.2 miles
Oak Farm Infant and Junior Schools 0.3 miles



Train:

Hillingdon 0.9 miles
Uxbridge 1.3 miles
Ickenham 1.5 miles



Car:

M4, A40, M25, M40



Council Tax Band:

D

(Distances are straight line measurements from centre of postcode)



GROUND FLOOR
513 sq.ft. (47.7 sq.m.) approx.

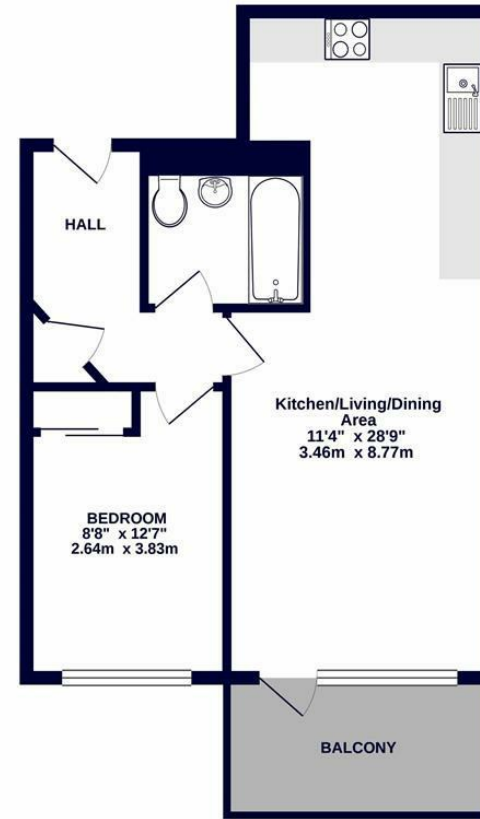

TOTAL FLOOR AREA: 513 sq.ft. (47.7 sq.m.) approx.

Whilst every attempt has been made to ensure the accuracy of the floorplan contained here, measurements of doors, windows, rooms and any other items are approximate and no responsibility is taken for any error, omission or mis-statement. This plan is for illustrative purposes only and should be used as such by any prospective purchaser. The services, systems and appliances shown have not been tested and no guarantee as to their operability or efficiency can be given.
Made with Metrepro ©2021.



01895 230 103
109 Hillingdon Hill, Hillingdon Village,
Middlesex, UB10 0JQ
hillingdon@coopersresidential.co.uk

CoopersResidential.co.uk

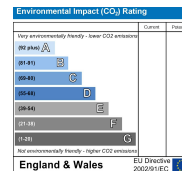
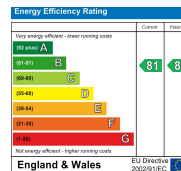

Important Notice: These particulars, whilst believed to be accurate are set out as a general outline only for guidance and do not constitute any part of an offer or contract. Intending purchasers should not rely on them as statements or representation of fact, but must satisfy themselves by inspection or otherwise has the authority to make or give any representation or warranty in respect of the property.