



Symonds
& Sampson

Hibernia Place
Bridport, Dorset

Hibernia Place

Bridport
Dorset
DT6 5FP

Beautifully presented four bedroom five year old townhouse a walk to the town centre.



- Walking distance of the town centre
- 2018 build with building guarantee
 - Beautifully presented
 - Gardens
 - Two allocated parking spaces

Guide Price £400,000
Freehold

Bridport Sales
01308 422092
bridport@symondsandsampson.co.uk



DWELLING

2 Hibernia Place forms part of an attractive terrace of houses that were built in 2018. The property is in excellent decorative order, has all the cost saving and insulation advantages one would expect of a contemporary property. It provides off street parking and is just a short walk to Bridport town centre.

ACCOMMODATION

The property is conventionally arranged around a hallway to the front with a cloakroom off. To the front of the house there is an attractive sitting room with a bay window to one end. To the rear there is a kitchen/dining room with a kitchen area to one side fitted with a comprehensive range of floor and wall mounted units and cupboards with an integrated ceramic hob and electric oven. To the other end there is substantial dining area with double opening doors onto the gardens behind. All of the downstairs, with the exception of the sitting room, is laid with Karndean LVT (Karndean Luxury Flooring) planks with underfloor heating.

Upstairs, there is a spacious landing off which there are four good bedrooms, the principal of which has an ensuite shower room and a built-in double wardrobe with the three remaining bedrooms sharing a family bathroom with a shower over the bath. The property is in excellent decorative order throughout, has UPVC double glazing and gas fired central heating.

OUTSIDE

To the front, there are two designated parking spaces for the property with to one corner a bin store for the development. There is a small wall and fence enclosed garden to the front laid to gravel and bisected by a path that leads up to the front door. The gardens to the rear are south and west facing with a paved terrace immediately to the rear of the property, giving way to an area of lawn enclosed by timber fencing. The bank above the garden is also owned by the house and is left wild for the most part.

SERVICES AND LOCAL AUTHORITY

Mains gas, electricity, water and drainage. Gas fired central heating.

Broadband - Superfast broadband is available.

Mobile phone coverage - Network coverage is mostly good outdoors but limited indoors.

Dorset Council 01305 251010.

Council tax band D.

EPC: B.

AGENTS NOTE

The communal parts of the property to the front of the house taking in the driveway, the bin store and the parking are owned by all 6 properties and there is a monthly service charge of £30.

DIRECTIONS

What3Words///caressing.crowbar.pasting



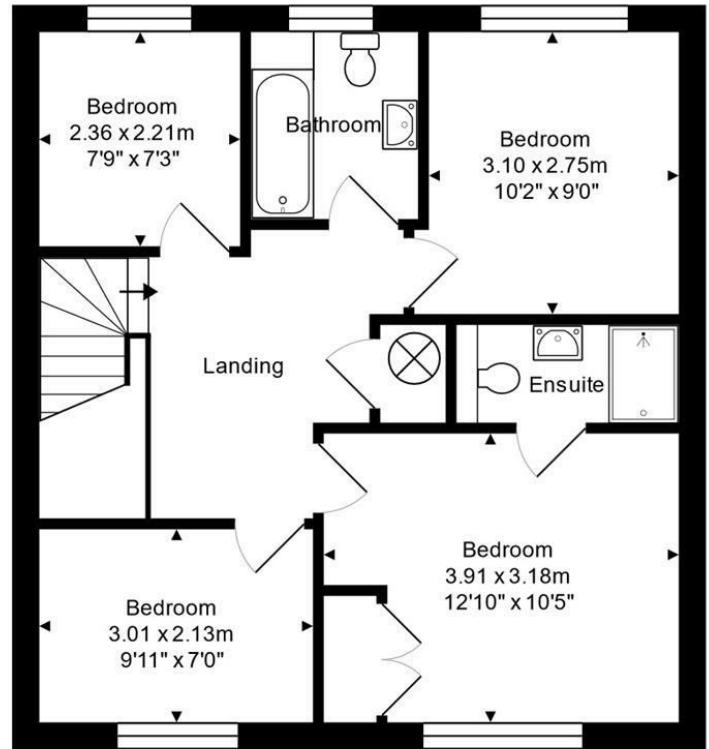
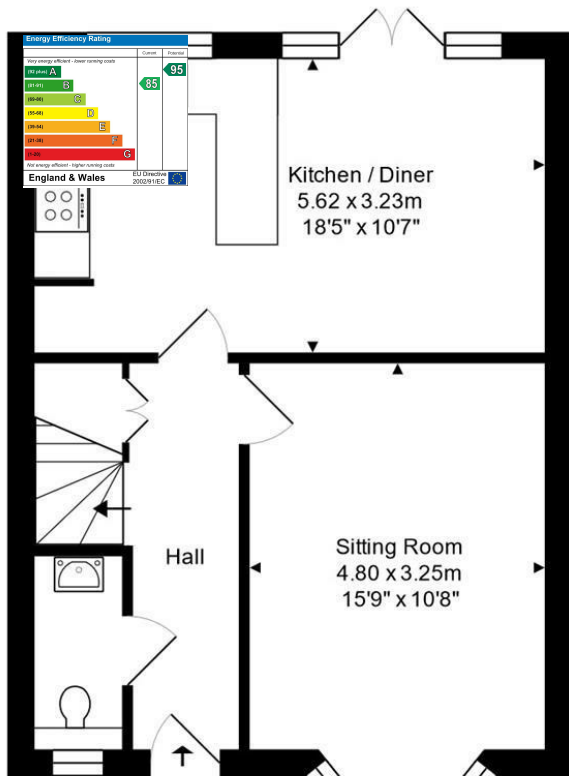

Ground Floor

First Floor



Total Area: 97.0 m² ... 1044 ft²
 Not to scale. Measurements are approximate and for guidance only.

Bridport/SA/130225/REV



01308 422092

bridport@symondsandsampson.co.uk
 Symonds & Sampson LLP
 23, South Street,
 Bridport, Dorset DT6 3NU



Important Notice: Symonds & Sampson LLP and their Clients give notice that: 1. They have no authority to make or give any representations or warranties in relation to the property. These particulars do not form part of any offer or contract and must not be relied upon as statements or representations of fact. 2. Any areas, measurements or distances are approximate. The text, photographs and plans are for guidance only and are not necessarily comprehensive. It should not be assumed that the properties have all necessary planning, building regulation or other consents and Symonds and Sampson LLP have not tested any services, equipment of facilities. 3. We have not made any investigation into the existence or otherwise of any issues concerning pollution of the land, air or water contamination and the purchaser is responsible for making his/her own enquiries in this regard. 4. The property is sold subject to and with the benefit of all existing wayleaves, easements and rights of way whether public or private, specifically mentioned or not. The vendors shall not be required to define any such rights, privileges or advantages.

SALES | LETTINGS | AUCTIONS | FARMS & LAND | COMMERCIAL | NEW HOMES | PLANNING & DEVELOPMENT