



Howard Road, Bothenhampton, Bridport

A beautifully presented two bedroom mid-terrace house in a sought after edge of town location with parking and on offer with no forward chain.

Guide Price
£289,000
Freehold

**Symonds
& Sampson**
ESTABLISHED 1858

**Howard Road,
Bothenhampton, Bridport,
DT6 4SG**

- Two bedrooms
- Plenty of parking
 - Rear garden
- Excellent condition
- No forward chain

Viewing strictly by appointment
Symonds & Sampson
01308 422092





The Property

This two bedroom mid-terrace house has been improved and upgraded under the current ownership, and now presents in excellent order throughout. Situated in a popular location on the edge of Bridport town, the property benefits from plenty of parking, a pretty rear garden, and is offered for sale with no onward chain.

The property is conventionally arranged around a central hallway, with the bright and spacious sitting room to the right hand side stretching the full depth of the property, with sliding doors onto the rear garden. The kitchen is to the rear overlooking the garden, and has been tastefully updated with a modern shaker-style kitchen with a Quartz worktop. The kitchen is fitted with a comprehensive range of wall and base units with an integrated oven and hob and space for a fridge/freezer. There is a large downstairs cloakroom which doubles up as a utility space, with space for a washing machine.

On the first floor, there are two double bedrooms and a

contemporary family bathroom fitted with a white suite. The principal bedroom is located to the rear of the property and the second bedroom is a generous double, and currently utilised as a home office with a large wardrobe.

Outside

Like the rest of the property, the garden is beautifully presented with a decked area immediately adjoining the sitting room. It is an ideal sitting space with room for a BBQ. There are raised flower beds and steps up to an area of lawn. There is space for a shed at the rear of the garden and a gate providing rear pedestrian access. There is space to park several cars to one end of the path, with an additional parking space to the other end, and parking in the area is generally very easy to obtain, for further information please see the title plan.

Situation

The property is situated on the edge of the bustling and vibrant market town of Bridport. Bridport has a history of rope-making and is now a gateway to the Jurassic, World

Heritage coastline at nearby West Bay. It has a variety of independent shops, supermarkets, public houses and restaurants catering for a range of tastes and excellent arts and music events. Bridport is conveniently placed for Dorchester and Weymouth to the east and Axminster to the west. Walking, water sports and riding opportunities are plentiful in the area, with many walks starting from the town itself. Communication links are good with road links along the A35 and mainline stations at Maiden Newton, Dorchester, Axminster and Crewkerne.

Services

Mains water, electricity, gas and drainage.

Gas fired central heating.

Broadband speed: Superfast broadband is available.

Mobile phone coverage: Network coverage is good both indoors and out.

Local Authority

Dorset Council: 01305 251010

Council Tax Band: B

EPC: C

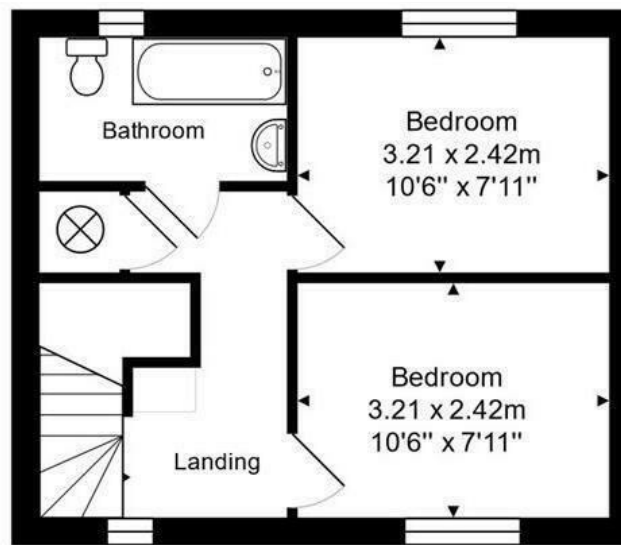

First Floor



Ground Floor

Directions

From our offices proceed up to the square, turning right at the traffic lights into East Road. Proceed to the roundabout and take the second turning towards Dorchester into East Street. Continue to the top of the hill and take the first major turning on the right hand side into Howard Road. The property can be found on the left hand side, identified by a For Sale board.

What3Words///straying.unleashed.courts

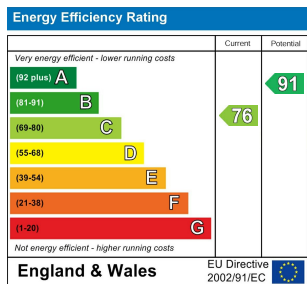

Bridport/DME/16.05.2024

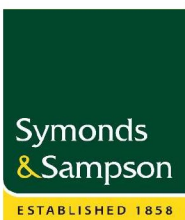

01308 422092
 Symonds & Sampson 23 South Street
 Bridport
 Dorset
 DT6 3NU
 bridport@symondsandsampson.co.uk

IMPORTANT NOTICE: Symonds & Sampson LLP and their Clients give notice that:

1. They have no authority to make or give any representations or warranties in relation to the property. These particulars do not form part of any offer or contract and must not be relied upon as statements or representations of fact. 2. Any areas, measurements or distances are approximate. The text, photographs and plans are for guidance only and are not necessarily comprehensive. It should not be assumed that the property has all necessary Planning, Building Regulation or other consents, and Symonds & Sampson have not tested any services, equipment, or facilities.

