



Down End Court, Crock Lane, Bridport

A well presented two bedroom terraced house with a garage, within easy reach of Bridport town centre.

Guide Price
£259,950
Leasehold

DOWN END COURT
Nos. 1 - 7
RESIDENTS PARKING ONLY
PRIVATE FORECOURT
NO LIABILITY ACCEPTED

Symonds & Sampson
ESTABLISHED 1858

Down End Court, Crock Lane, Bridport, DT6 4HZ

- No Onward Chain
- Residents Parking & Garage
- Views Over Town to Countryside Beyond
- Within Easy Reach of Town Centre & Jurassic Coast
 - Countryside Walks on the Doorstep

Viewing strictly by appointment through
Symonds & Sampson Bridport Sales Office
on 01308 422092





The Property

This well presented two bedroom terraced house is conveniently located along the popular Crock Lane, within easy reach of the town centre and with countryside walks on the doorstep. Having been redecorated over recent years, the property is now presented in excellent order and offers bright and spacious accommodation.

Internally, a useful inner porch opens into the modern fitted kitchen with a range of wall and base units and an integrated electric oven and hob, with space for other appliances. A large fitted dresser and display unit spans one wall, providing plenty of storage. The spacious living room is to the rear, with a window overlooking the garden and a door providing access to the garden and garage beyond. Upstairs, there are two good sized double bedrooms, both enjoying distant country views, and a family bathroom fitted with a white suite comprising a bath, wc, sink and heated towel rail.

Outside

The property is approached over a pretty communal front garden, with a shared path leading up to the front door. There is a small seating area to the rear and a further area of lawn. The property has the immense benefit of residents parking and a garage.

Situation

Crock Lane is a popular residential road within easy walking distance of Bridport Town centre, nearby bus links and supermarkets. Also close by are a good choice of walks including Asker Meadows (which also makes a pleasant route into town) and Bothenhampton Hill. Bridport is situated by the River Brit and is a busy, active market town and popular holiday area, designated as being in an Area of Outstanding Natural Beauty, where street markets are held twice weekly. The town provides a comprehensive range of shopping and professional facilities, primary and secondary schools, recreational and social amenities. The pretty harbour at West Bay, with lovely beaches is close by and the area provides the opportunity for enjoying the Jurassic Coast, a World Heritage Site.

Tenure

Leasehold. 999 year lease from June 1985. There is a service charge of £734 per annum to include maintenance of the communal areas and building insurance. Ground rent of £27.

It is understood that the property can be used for Assured Shorthold Tenancies. Holiday letting and pets are not permitted.

Services

Mains electricity, water and drainage. Electric night storage heating.
Broadband - Superfast broadband is available.
Mobile phone coverage - Network coverage is good both indoors and out.

Council Tax Band B.

Local Authority

Dorset Council Tel: 01305 251010.

Directions

From our South Street office, proceed towards the centre of town and turn right at the traffic lights. Continue down East Street and take the second exit at the roundabout into East Road. Take the next right into Asker Mead and follow the road around to the right into Crock Lane. The house will be found shortly after on the left hand side, denoted by a For Sale board.

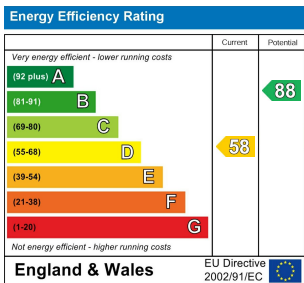

Bridport/IRU/301123 Rev 030424

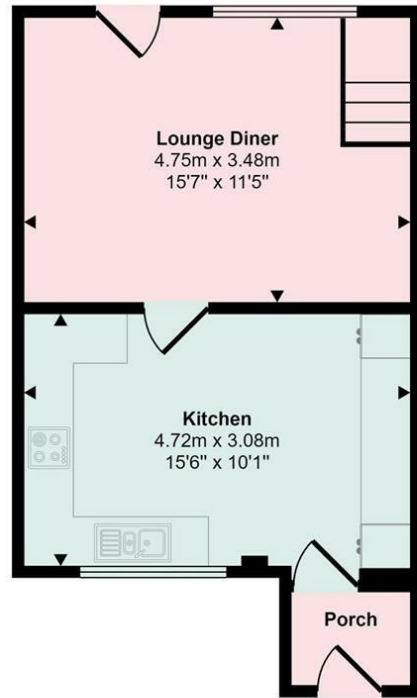

Ground Floor

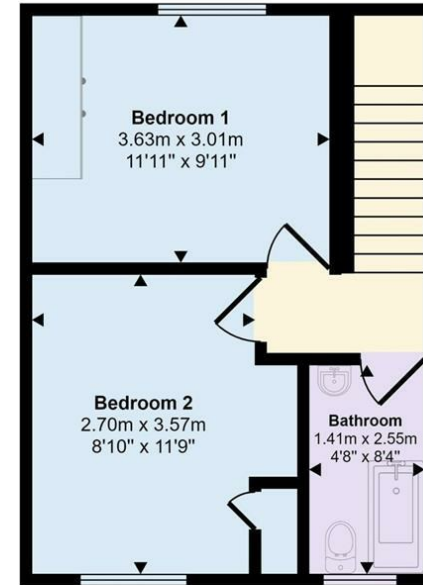

First Floor

This floorplan is only for illustrative purposes and is not to scale. Measurements of rooms, doors, windows, and any items are approximate and no responsibility is taken for any error, omission or mis-statement. Icons of items such as bathroom suites are representations only and may not look like the real items. Made with Made Snappy 360.

01308 422092
Symonds & Sampson LLP
 Symonds & Sampson 23 South Street, Bridport, Dorset, DT6 3NU

Symonds & Sampson
 ESTABLISHED 1858

bridport@symondsandsampson.co.uk
 www.symondsandsampson.co.uk

IMPORTANT NOTICE: Symonds & Sampson LLP and their Clients give notice that:

1. They have no authority to make or give any representations or warranties in relation to the property. These particulars do not form part of any offer or contract and must not be relied upon as statements or representations of fact. 2. Any areas, measurements or distances are approximate. The text, photographs and plans are for guidance only and are not necessarily comprehensive. It should not be assumed that the property has all necessary Planning, Building Regulation or other consents, and Symonds & Sampson have not tested any services, equipment, or facilities.

