





📍 3 Beaufort Brewery, Royal Wootton Bassett, Wiltshire, SN4 7GD

🔗 £1,000 PCM

- Large Loft Style 2nd Floor Apartment
- Situated in Converted Building
- Modern with Character Features
- Two Double Bedrooms
- En-suite Shower Room to Master
- Open plan Living/Dining/Kitchen
- Built in Appliances
- Allocated Parking
- Council Tax Band: C
- £1000pcm



🏠 EPC Rating D



Large loft style apartment (top floor) with character features and beamed ceilings situated in a popular location within the sought after town of Royal Wootton Bassett. One of only three apartments in this converted building, the accommodation comprises of secure entrance, good size entrance hall with storage cupboard, open plan living/dining/kitchen with built in appliances of cooker, fridge/freezer, washing machine and dishwasher, the master bedroom has an en suite shower room, second double bedroom & bathroom. Gas fired central heating. Allocated parking. Available now. Unfurnished. Sorry No Pets. £1000pcm.



## Ground Floor

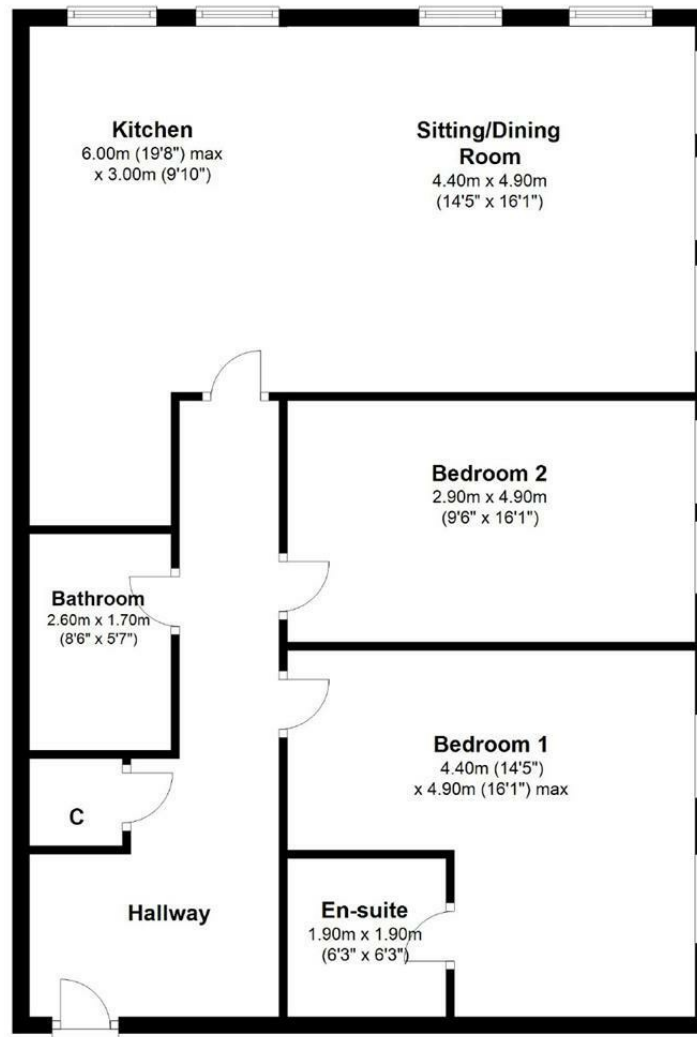

Disclaimer: These particulars, whilst believed to be accurate are set out as a general outline only for guidance and do not constitute any part of an offer or contract. Intending purchasers should not rely on them as statements of representation of fact, but must satisfy themselves by inspection or otherwise as to their accuracy. No person in this firm's employment has the authority to make or give any representation or warranty in respect of the property. All measurements and distances are approximate only. Your home is at risk if you do not keep up repayments on a mortgage or other loan secured on it.