



📍 Ivy Cottage, 114 St. Ediths Marsh, Bromham, Chippenham, Wiltshire, SN15 2DE

🔗 £2,000 Per Calendar Month

- Substantial Detached Period Home
- Private Gardens To All Sides
- 4 Bedrooms
- 3 Reception Rooms + 2 Attic Rooms
- Stylish Modern Kitchen + Utility
- Double Garage & Ample Parking
- Unfurnished
- Available 13th September



🏠 EPC Rating D



A superb detached period home set in the popular hamlet of St Ediths Marsh on the edge of the thriving village of Bromham. A generous and flexible layout consists of 4 bedrooms plus a study, complemented by 3 excellent reception rooms and a stylish modern kitchen.

'Ivy Cottage' is approached up a private driveway providing ample parking and leading to a detached double garage. Inside the house, there are three good sized reception rooms; a characterful dining room with engineered oak flooring and an impressive Inglenook with an inset log burning stove, a dual aspect family room, and a 23ft dual aspect sitting room with French doors out to the rear garden. From the dining room an opening leads into the beautiful modernised kitchen with tiled flooring and a range of fitted oak cupboards with granite effect worktops. There is an integrated dishwasher, and an American style fridge/freezer and Range style cooker. A useful utility room and a downstairs cloakroom completes the ground floor layout. On the first floor there are four bedrooms plus a study. The principal bedroom benefits from fitted wardrobes (as does bedroom 3 and the study) and a refitted en suite shower room. A further contemporary family bathroom is complemented by a separate WC. Two informal attic rooms could be utilised further as hobby areas.

Outside the well tended lawned gardens enjoy a great amount of privacy and run to all sides of the cottage, with patio seating areas and planted shrubbed borders.

Gas central heating and mains utilities. Available now, unfurnished, £2000pcm. Pets will be considered.

Property Information

Local Authority- Wiltshire Council

Council Tax - Band F

EPC Rating: D

Services - Mains water, electricity and drainage, gas central heating. New boiler installed 2018 / 19



St. Ediths Marsh, Chippenham, SN15

Approximate Area = 2764 sq ft / 256.8 sq m

Limited Use Area(s) = 222 sq ft / 20.6 sq m

Garage = 465 sq ft / 43.2 sq m

Attic = 88 sq ft / 8.2 sq m

Total = 3540 sq ft / 328.8 sq m

For identification only - Not to scale

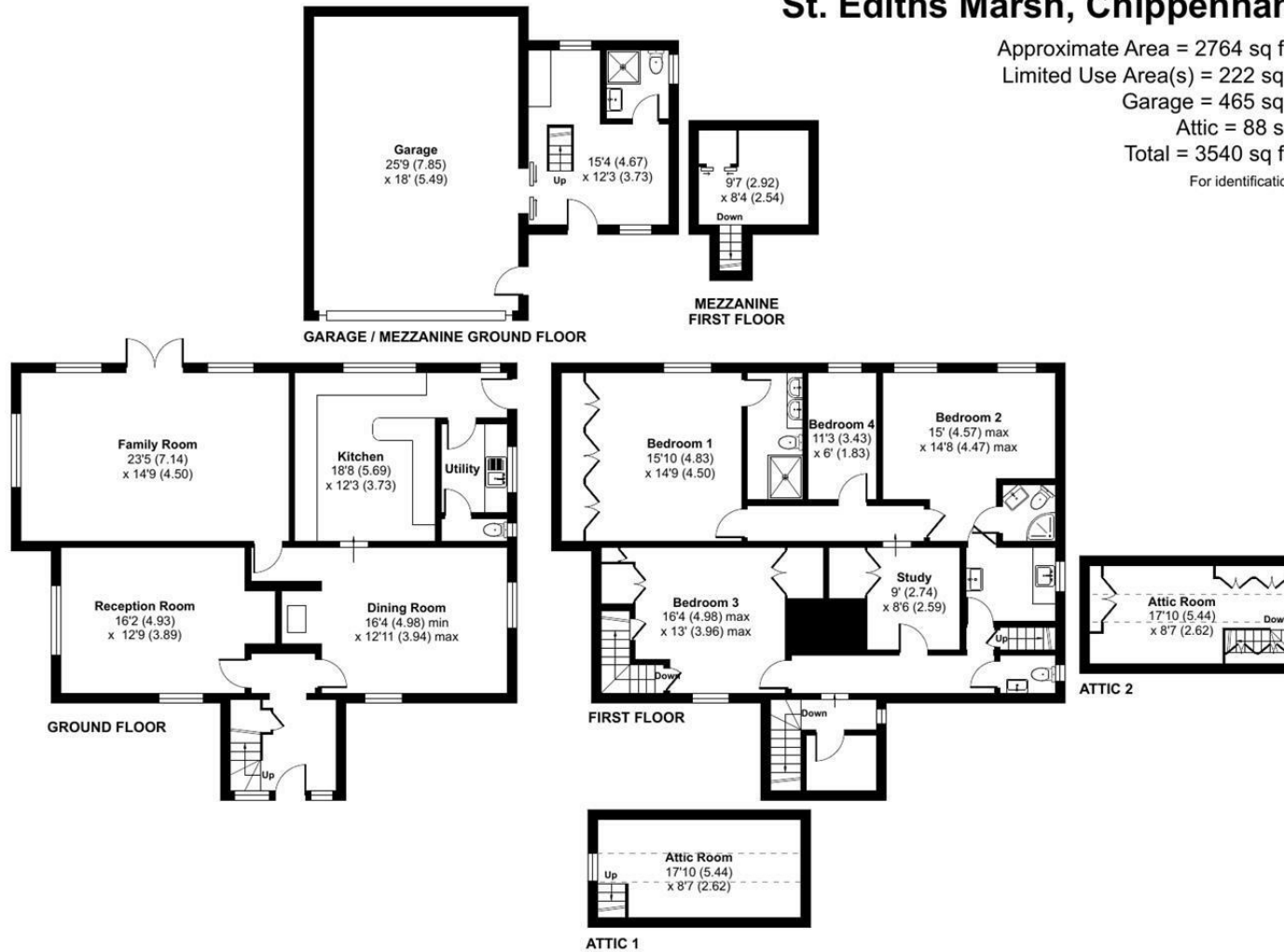

Floor plan produced in accordance with RICS Property Measurement Standards incorporating International Property Measurement Standards (IPMS2 Residential). © nitchecom 2024. Produced for Strakers. REF: 1140702

Disclaimer These particulars, whilst believed to be accurate are set out as a general outline only for guidance and do not constitute any part of an offer or contract. Intending purchasers should not rely on them as statements of representation of fact, but must satisfy themselves by inspection or otherwise as to their accuracy. No person in this firm's employment has the authority to make or give any representation or warranty in respect of the property. All measurements and distances are approximate only. Your home is at risk if you do not keep up repayments on a mortgage or other loan secured on it.