



📍 185 Oxford Road, Calne, Wiltshire, SN11 8AL

🔗 £1,300 PCM

A lovely three bedroom Victorian terraced house with a great size garden situated on the edge of the town of Calne. Available April, unfurnished, £1300pcm (pets considered).

- TO LET
- LOVELY VICTORIAN HOUSE
- WELL PRESENTED
- THREE BEDROOMS
- GOOD ACCESS TO LOCAL AMENITIES
- GOOD SIZE REA GARDEN
- COUNCIL TAX BAND D
- ON STREET PARKING AVAILABLE
- UNFURNISHED
- AVAILABLE APRIL



🏠 EPC Rating D



A lovely three bedroom Victorian terraced house with a great size garden situated on the edge of the town of Calne. Available April, unfurnished, £1300pcm (pets considered).

Accommodation comprises entrance porch, a cosy living area with original stripped floorboards, tiling and feature fireplace with wood burner. The living area leads in to a wonderful contemporary style fitted kitchen/diner with original period tiled flooring plus gas hob and electric oven. Just off the kitchen/diner is a very useful utility area with space for appliances together with a separate utility cupboard with water softener and space for another appliance. Also situated on the ground floor is a fantastic modern shower room with heated towel rail.

Situated to the first floor are bedrooms one and three both having fitted wardrobes. There is also a w/c. Situated to the second floor is bedroom two with stairway storage and large fitted wardrobes.

Externally the rear garden is an excellent size that is split into two sections. Section one offers a nice decked seating area and lawn with artificial grass for easy maintenance. Section two has a good size timber storage shed and is very low maintenance with timber planters for vegetable growing. The property is situated within easy reach of local amenities together with great access to the A4 and B4069.

A minimum contract for this property is 12 months.



GROUND FLOOR
437 sq.ft. (40.6 sq.m.) approx.

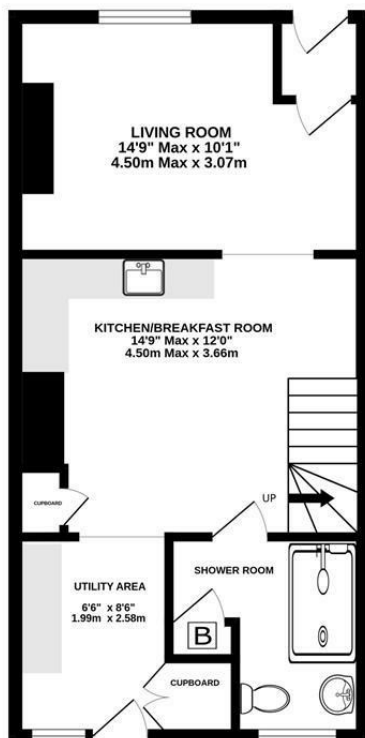

1ST FLOOR
288 sq.ft. (26.8 sq.m.) approx.

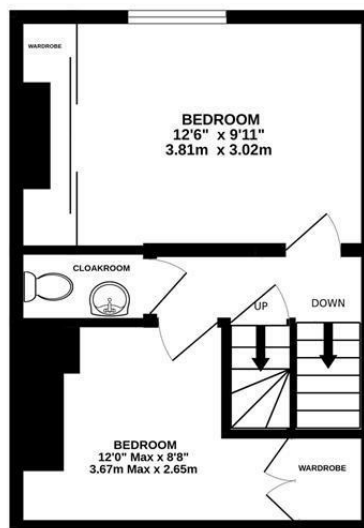

2ND FLOOR
224 sq.ft. (20.8 sq.m.) approx.

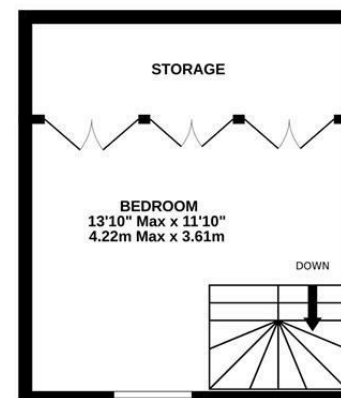

TOTAL FLOOR AREA : 950 sq.ft. (88.2 sq.m.) approx.

Schematic Diagram only - Not to scale
Made with Metropix ©2023

Disclaimer These particulars, whilst believed to be accurate are set out as a general outline only for guidance and do not constitute any part of an offer or contract. Intending purchasers should not rely on them as statements of representation of fact, but must satisfy themselves by inspection or otherwise as to their accuracy. No person in this firm's employment has the authority to make or give any representation or warranty in respect of the property. All measurements and distances are approximate only. Your home is at risk if you do not keep up repayments on a mortgage or other loan secured on it.