



11 Manville Court, Horsham Road, Shalford GU4 8EL







Property Description

- Two bedrooms, both with fitted wardrobes
- Double aspect sitting/dining room
- All main rooms overlooking the communal gardens
- Parking space and garage in a block
- Council Tax band D
- Tenure – Leasehold

A lovely ground floor 2 bedroom flat with a garage, set in the most glorious position, to the rear of the main Manville Court building, with all the main rooms overlooking the communal gardens.

The flat is accessed via a security door to a carpeted entrance hall. The door to the flat then opens into a corridor which provides access to all the rooms. The bathroom, separate toilet and airing cupboard can be found on the left hand side, with all the other rooms overlooking the gardens.

There are two bedrooms, both with fitted wardrobes (bedroom 2 is currently being used as a dining room). The double aspect sitting/dining room has double doors opening onto the gardens and also provides access into the kitchen.

Outside, the communal gardens are well kept and there is parking and a garage in the block.

Annual service charge: £1,800

Lease – 999 year lease from June 1981

Manville Court, Shalford

Approximate Gross Internal Area :- 62.0 sq mt / 667 sq ft

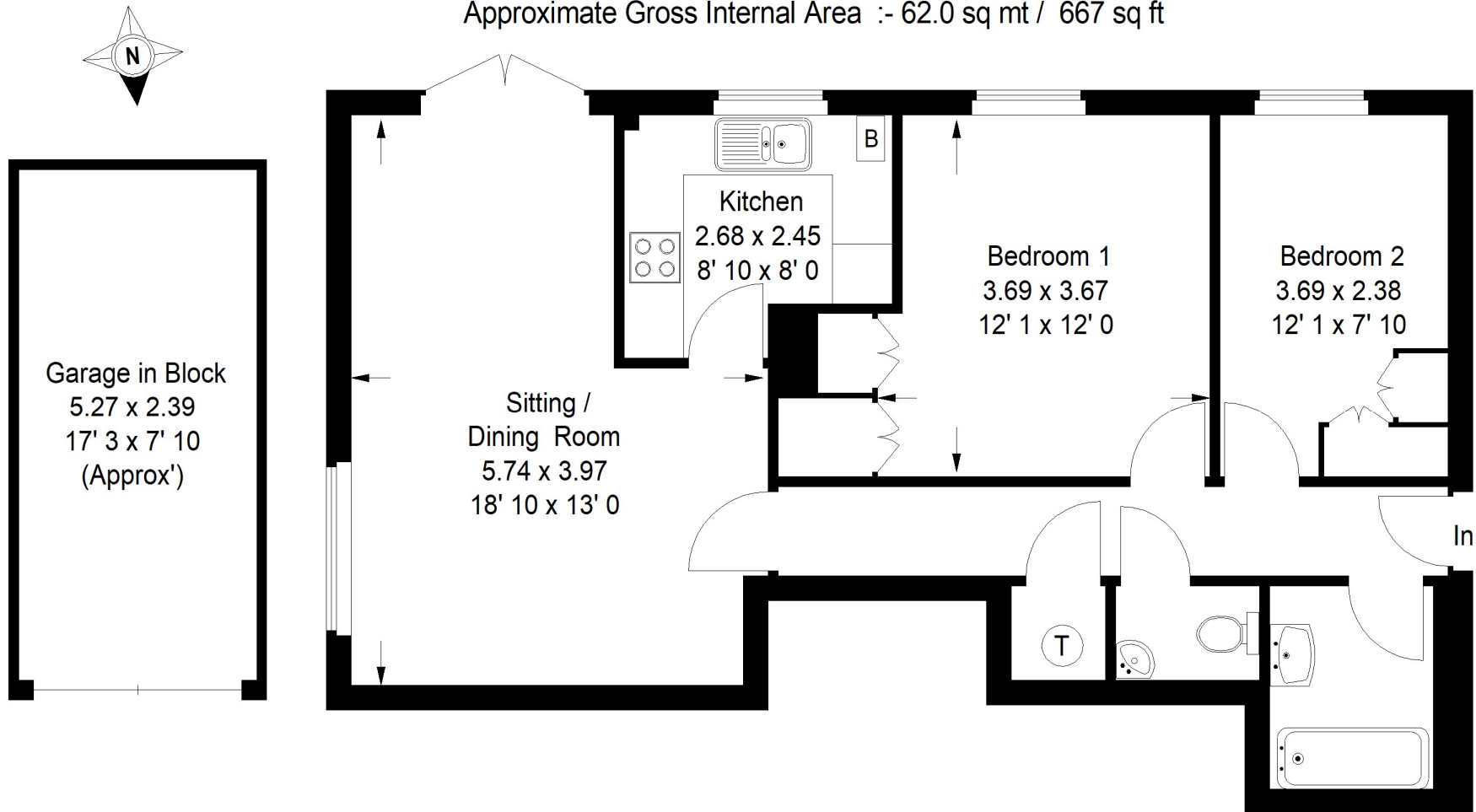

Guildford Sales 01483 405222
guildford@chantriesandpewleys.com

Merrow Sales 01483 347100
merrow@chantriesandpewleys.com

Shalford Sales 01483 304344
shalford@chantriesandpewleys.com

Lettings 01483 405222
lettings@chantriesandpewleys.com



Agents Note: Whilst every care has been taken to prepare these sales particulars, they are for guidance purposes only and should not be relied upon. Potential buyers are advised to recheck the measurements. Items known as fixtures and fittings, whether mentioned or not in these sales particulars, are excluded from the sale but may be available by separate negotiation.