

FOR SALE



Roman Road, Wheatley

2 Bedrooms, 1 Bathroom, Apartment

Guide Price £275,000

MARTIN&CO



Score	Energy rating	Current	Potential
92+	A		
81-91	B	82 B	82 B
69-80	C		
55-68	D		
39-54	E		
21-38	F		
1-20	G		



Key Notes:

- Chain Complete
- Vacant Possession
- Open Plan Kitchen Living Space
- Cul De Sac Location
- Off Road Parking
- Council Tax Band: B
- Ground Rent: £200.00 PA
- Service Charge: £1,000.00 PA
- Built in 2018 with Modern Finish
- Shared Garden



Martin & Co are delighted to welcome this lovely Two Bed Apartment located on Roman Road in Wheatley. The apartment will be sold Vacant and the Chain is complete with the Owners Onward being a No Onward Chain.

Built in 2018, the Main Entrance to the apartment is on the ground floor of the building which is shared between the two first floor apartments. Upon entering the apartment itself you are greeted by an entrance hall, from here, on the left, there are the Two Double Bedrooms, further to this, on the right, is the Family Bathroom.

Ahead of you is the Spacious Living and Dining Room which is open to a Modern Integrated Kitchen. The apartment is finished to a high standard throughout with solid wood floors, ample built in storage, its own combination boiler and gas central heating. It also benefits from having Communal Gardens with views overlooking the fields to the back.

Viewings are Highly Recommended and any questions please contact Martin & Co Oxford.



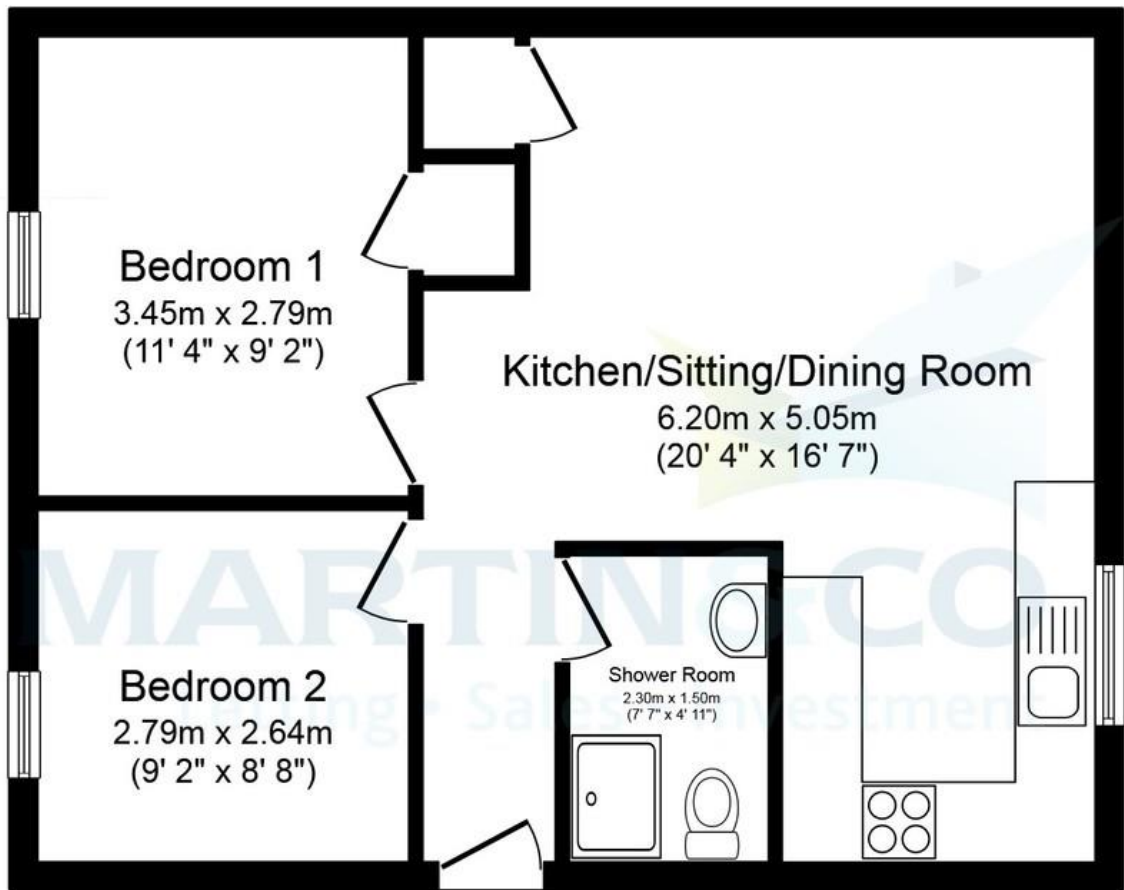

Floor Plan

Total floor area 49.1 m² (529 sq.ft.) approx

This plan is for illustration purposes only and may not be representative of the property. Plan not to scale. Powered by PropertyBox

Martin & Co Oxford

31 Woodins Way • Paradise Street • • OX1 1HD
T: 01865 812110 • E: oxford@martinco.com

01865 812110
<http://www.martinco.com>



Accuracy: References to the Tenure of a Property are based on information supplied by the Seller. The Agent has not had sight of the title documents. A Buyer is advised to obtain verification from their Solicitor. Items shown in photographs including but not limited to carpets, fixtures and fittings are not included unless specifically mentioned within the sales particulars. They may however be available by separate negotiation. Buyers must check the availability of any property and make an appointment to view before embarking on any journey to see a property. No person in the employment of the agent has any authority to make any representation about the property, and accordingly any information given is entirely without responsibility on the part of the agents, sellers(s) or lessors(s). Any property particulars are not an offer or contract, nor form part of one. **Sonic / laser Tape:** Measurements taken using a sonic / laser tape measure may be subject to a small margin of error. **All Measurements:** All Measurements are Approximate. **Services Not tested:** The Agent has not tested any apparatus, equipment, fixtures and fittings or services and so cannot verify that they are in working order or fit for the purpose. A Buyer is advised to obtain verification from their Solicitor or Surveyor.