

DARLAN ROAD, SW6

Approx. gross internal area 639 Sq Ft. / 59.4 Sq M

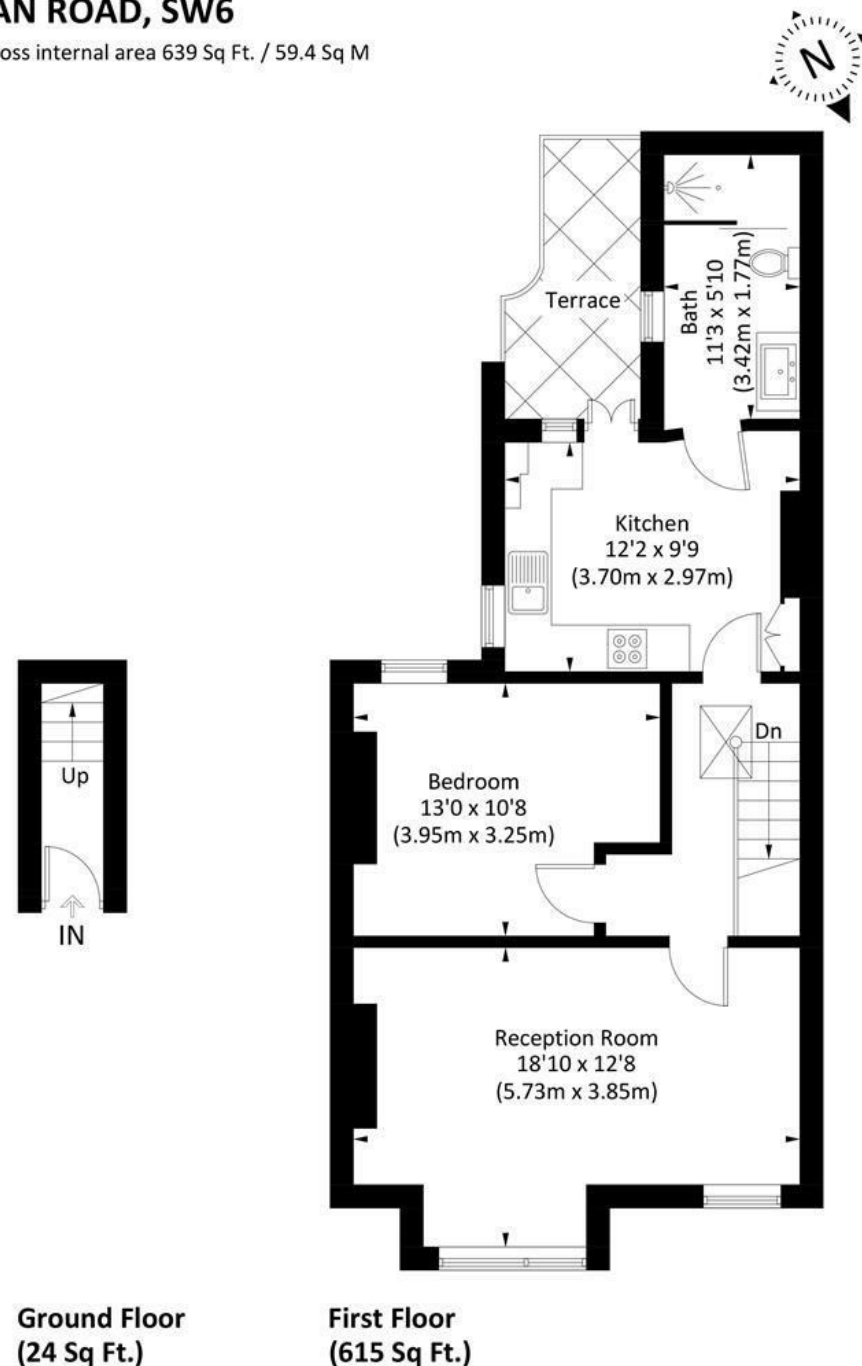

Illustration for identification purposes only, measurements are approximate, not to scale. Fourlabs.co © 2025 (ID1188498)

DISCLAIMER•These particulars are intended to give a fair and substantially correct overall description for the guidance of intending purchasers and do not constitute an offer or part of a contract. Prospective purchasers and/or lessees ought to seek their own professional advice.

•All descriptions, dimensions, areas, references to condition and necessary permissions for use and occupation and other details are given in good faith and are believed to be correct, but any intending purchasers should not rely on them as statements or representations of fact, but must satisfy themselves by inspection or otherwise as to the correctness of each of them.
•All measurements are approximate.



Darlan Road, London, SW6

A lovely one bedroom flat with private terrace located on the first/top floor of this converted period house in the heart of Fulham. Offered on an unfurnished basis and benefiting from its own front door, the accommodation comprises a bright and spacious reception room, fully fitted kitchen with access to the terrace, double bedroom and smart shower room. Darlan Road is ideally located for all the amenities and transport at Fulham Broadway as well as Putney Bridge underground. The open spaces of Bishops Park and the river are a short walk away.

Available from the 30th June 2025.



- ONE BEDROOM FLAT
- FITTED KITCHEN
- SHOWER ROOM
- PRIME LOCATION
- COUNCIL TAX BAND D
- RECEPTION ROOM
- DOUBLE BEDROOM
- PRIVATE TERRACE
- EPC E

Per Month
£1,850 Per Month

