

Somerville House, Putney, SW15

A bright and spacious (1,068 SQ FT) three double bedroom apartment set within Putney's most prestigious 1930's built mansion block development. The apartment is located on the first floor (with lift) of Somerville House with fabulous westerly views over the manicured lawns. The flat further benefits from a family bathroom as well as a guest W.C. Of particular note is the good-sized main bedroom benefitting from a dual aspect. Residents of Manor Fields benefit from eleven acres of beautifully cultivated and landscaped communal grounds, off street parking, porterage and 24 hour security. Set back from Putney Hill, Manor Fields offers easy access to the varied amenities of Putney High Street and its excellent rail and road transport links into Central London. The property is being sold with no onward chain.



- 1,068 SQ FT
- SPLENDID WEST FACING VIEWS
- FAMILY BATHROOM WITH WC
- 11 ACRES OF COMMUNAL GARDENS
- CHAIN FREE
- THREE BEDROOMS
- RECEPTION ROOM AND DINING ROOM
- SECOND WC
- RESIDENTS OFF STREET PARKING
- EPC RATING: D

Guide Price

£800,000

Available

Manor Fields, SW15 3LX

Approx Gross Internal Area = 99.22 sq m / 1068 sq ft

Eaves Storage = 4.40 sq m / 47 sq ft

Total = 103.62 sq m / 1115 sq ft

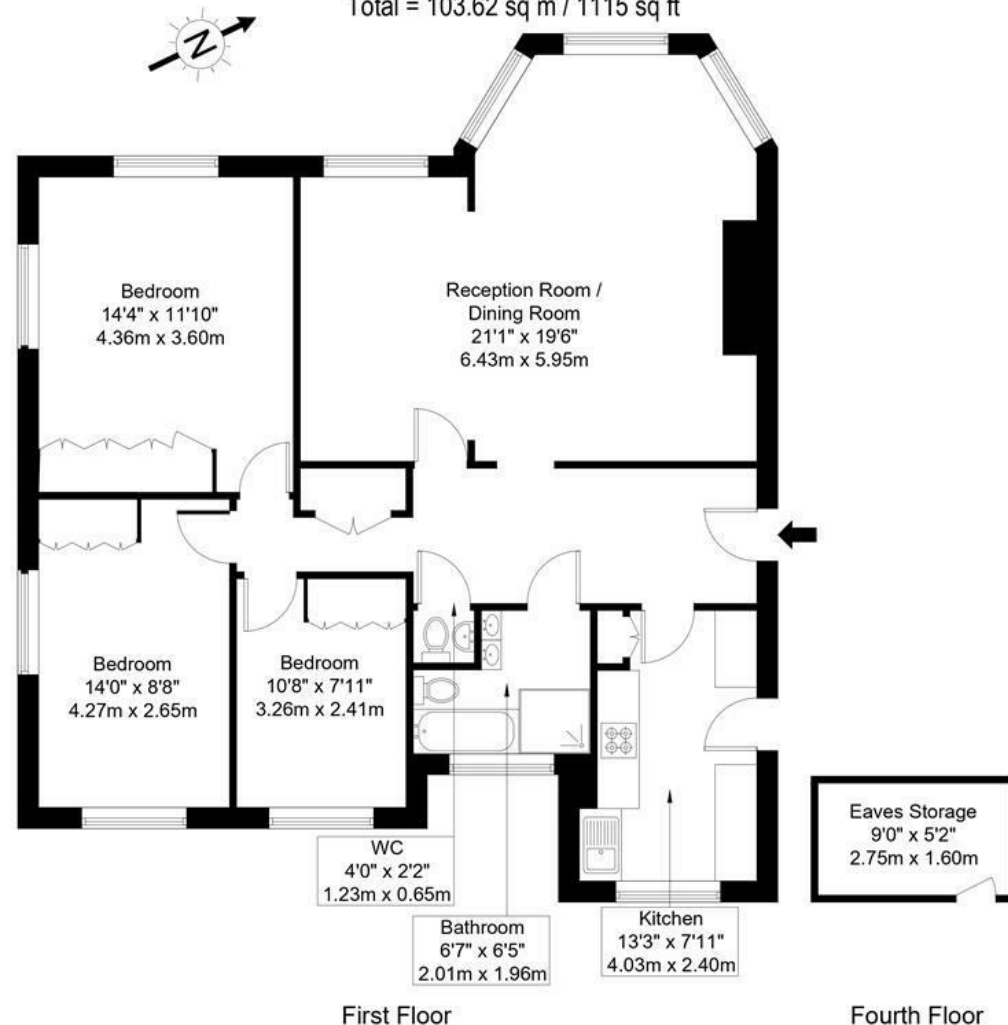

Ref :

Copyright **BLEU PLAN**

The Floor plan is not to scale and measurements and areas shown are approximate and therefore should be used for illustrative purposes only. The plan has been prepared in accordance with the RICS code of Measuring Practice and whilst we have confidence in the information produced it must not be relied on. Maximum lengths and widths are represented on the floor plan. If there is any aspect of particular importance, you should carry out or commission your own inspection of the property.
Copyright © BleuPlan

DISCLAIMER•These particulars are intended to give a fair and substantially correct overall description for the guidance of intending purchasers and do not constitute an offer or part of a contract. Prospective purchasers and/or lessees ought to seek their own professional advice.

•All descriptions, dimensions, areas, references to condition and necessary permissions for use and occupation and other details are given in good faith and are believed to be correct, but any intending purchasers should not rely on them as statements or representations of fact, but must satisfy themselves by inspection or otherwise as to the correctness of each of them.

•All measurements are approximate.



