

# WARREN

The Putney Estate Agent

**6 ROSELANDS HOUSE  
PUTNEY  
LONDON SW15**  
APPROXIMATE INTERNAL FLOOR AREA  
**653 SQ.FT / 60.6 SQ.M.**

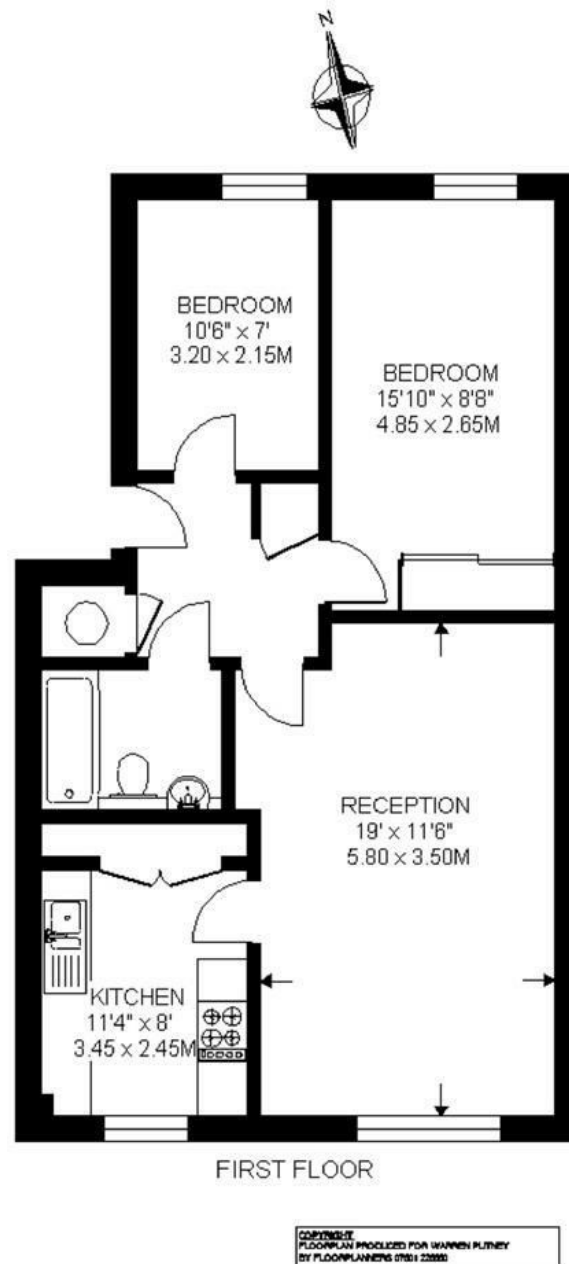

**DISCLAIMER**•These particulars are intended to give a fair and substantially correct overall description for the guidance of intending purchasers and do not constitute an offer or part of a contract. Prospective purchasers and/or lessees ought to seek their own professional advice.  
•All descriptions, dimensions, areas, references to condition and necessary permissions for use and occupation and other details are given in good faith and are believed to be correct, but any intending purchasers should not rely on them as statements or representations of fact, but must satisfy themselves by inspection or otherwise as to the correctness of each of them.  
•All measurements are approximate.



# WARREN

The Putney Estate Agent

## Roseland House, Putney, SW15

A superbly located and newly redecorated two bedroom flat on the first floor of this small private development moments from the high street. Offered on an unfurnished basis and benefiting from communal gardens and allocated off-street parking, the accommodation comprises an entrance hallway, bright reception room with dining area, fitted kitchen, principal bedroom with fitted wardrobe, further bedroom/study and brand new bathroom with shower over the bath. Weimar Street is perfectly located just off the high street and within a short walk of the mainline and underground stations. Available now.



- RECEPTION ROOM
- TWO BEDROOMS
- COMMUNAL GARDENS
- CLOSE TO HIGH STREET
- COUNCIL TAX BAND D
- FITTED KITCHEN
- BRAND NEW BATHROOM
- ALLOCATED PARKING
- EPC C

Per Calendar Month  
**£2,000 Per Calendar Month**



