

Percy Laurie House, Putney, SW15

Measuring in excess of 1200sq ft this stunning two double bedroom apartment on the raised ground floor of this popular modern development in central Putney. Set behind secure gates and benefiting from a concierge service, private balcony, underground parking and storage cage, this property comprises an entrance hallway, stunning reception room with open plan kitchen and doors to the balcony, master bedroom with en suite shower room, further double bedroom and further bathroom.

Percy Laurie House is ideally located and is just a few minutes walk from Putney High Street and therefore close to all major transport links. This property is offered with no onward chain.

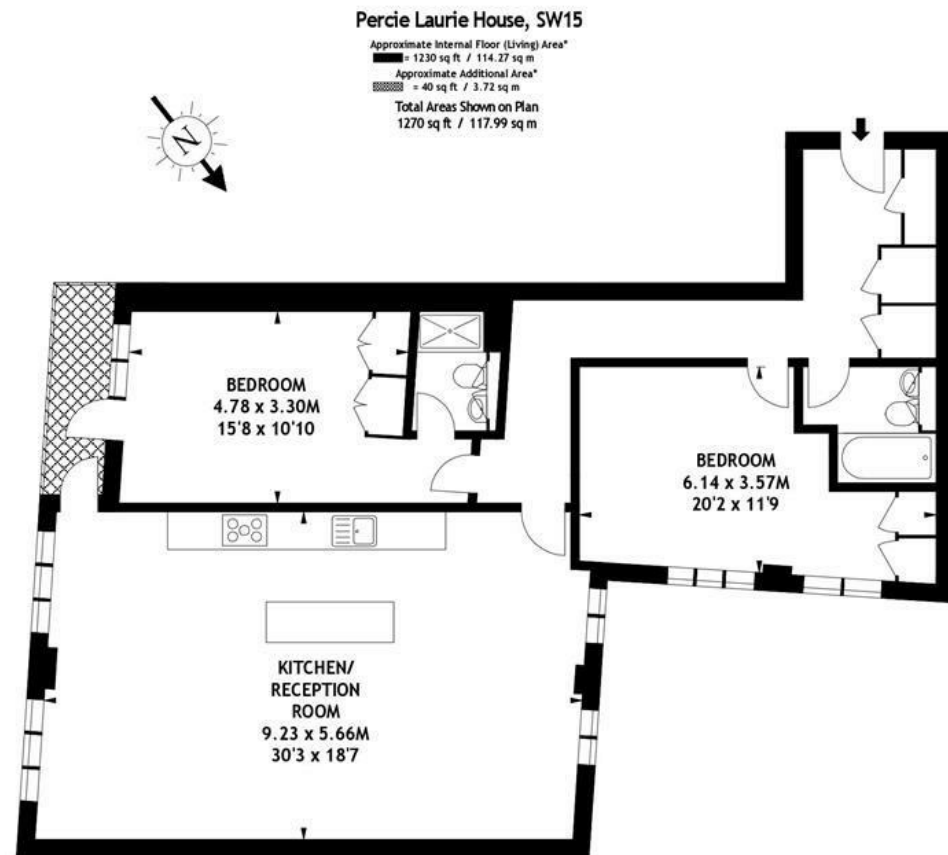

Ground Floor

Illustration for identification purposes only, not to scale
All measurements are maximum, and includes wardrobes and window bays where applicable



- TWO DOUBLE BEDROOMS
- OPEN PLAN KITCHEN
- BATHROOM
- PRIVATE BALCONY
- CONCIERGE
- RECEPTION ROOM
- RAISED GROUND FLOOR
- EN SUITE SHOWER
- UNDERGROUND PARKING
- CENTRAL PUTNEY LOCATION

Guide Price
£875,000
Available



DISCLAIMER•These particulars are intended to give a fair and substantially correct overall description for the guidance of intending purchasers and do not constitute an offer or part of a contract. Prospective purchasers and/or lessees ought to seek their own professional advice.
•All descriptions, dimensions, areas, references to condition and necessary permissions for use and occupation and other details are given in good faith and are believed to be correct, but any intending purchasers should not rely on them as statements or representations of fact, but must satisfy themselves by inspection or otherwise as to the correctness of each of them.
•All measurements are approximate.

