



1 Tidal Basin Road
Royal Victoria Dock, London, E16 1US
£2,995 Per Calendar Month



MADISON BROOK
INTERNATIONAL

1 Tidal Basin Road, Royal Victoria Dock, London, E16 1US

This outstanding 21st floor, three bedroom, two bathroom, 1,000 +Sq. Ft. apartment is available on a furnished basis and has beautiful views over The River Thames, Canary Wharf, O2 Arena & Royal Victoria Dock.

Featuring floor-to-ceiling windows to the open-plan lounge/kitchen, with integrated appliances, three double bedrooms, master bathroom & additional en-suite, utility cupboard & sizeable private terrace running around the entire apartment This development also boasts a private residents gymnasium & 24hr concierge.

The property also features Air conditioning and under floor heating in addition to an in built water filtration system to provide fresh water and reduce limescale.

The Hoolla Development is located in the stunning surrounds of Excel Marina, just moments from the Emirates Cable Car, City Hall & O2 Arena. Royal Victoria (DLR), Custom House (Elizabeth Line) & Canning Town (Jubilee) are within easy reach, connecting to the City of London, Canary Wharf and beyond.



These particulars, whilst believed to be accurate are set out as a general outline only for guidance and do not constitute any part of an offer or contract. Intending purchasers should not rely on them as statements of representation of fact, but must satisfy themselves by inspection or otherwise as to their accuracy. No person in this firm's employment has the authority to make or give any representation or warranty in respect of the property.

20 Western Gateway, Royal Victoria Dock, London, E16 1BS
 Tel: 020 3946 6000 Email: docklands@madisonbrook.com <https://madisonbrook.com/>

Floor Plan

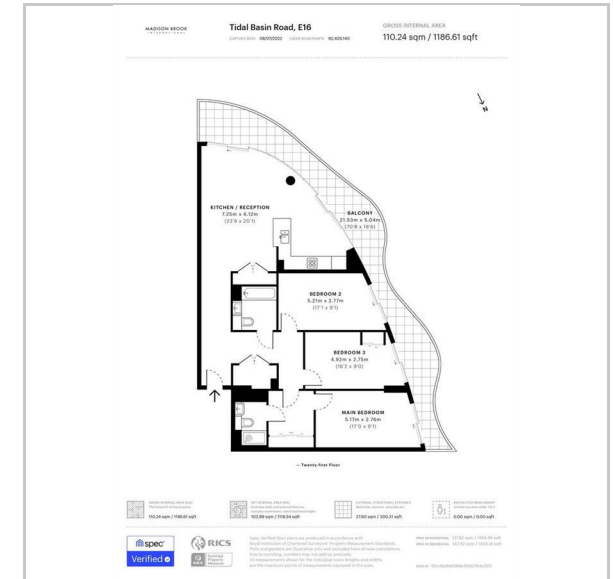

Area Map

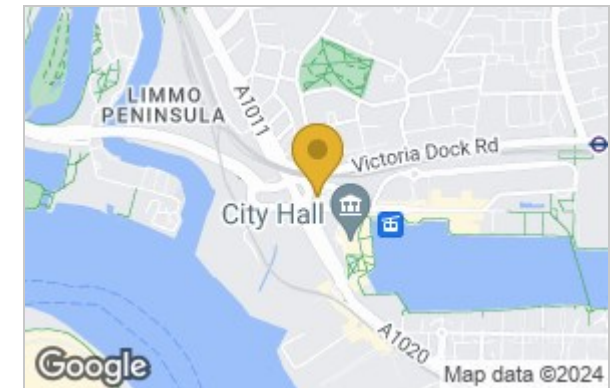

Energy Efficiency Graph

