



Living
made
better

Ellipse House
Royal Victoria Dock, E16 1BA



2



2



1



B

Asking Price £600,000

Ellipse House, Royal Victoria Dock, E16 1BA

Madison Brook

Property Summary

A beautifully finished two bedroom, two bathroom apartment set on the 5th floor of the prestigious Royal Eden Docks development, offering bright open-plan living, a private balcony and access to exceptional on-site amenities, all moments from excellent transport links.

Service charge: £4,629 pa | Ground rent: £475 pa | Lease: 173 years remaining

Floorplan

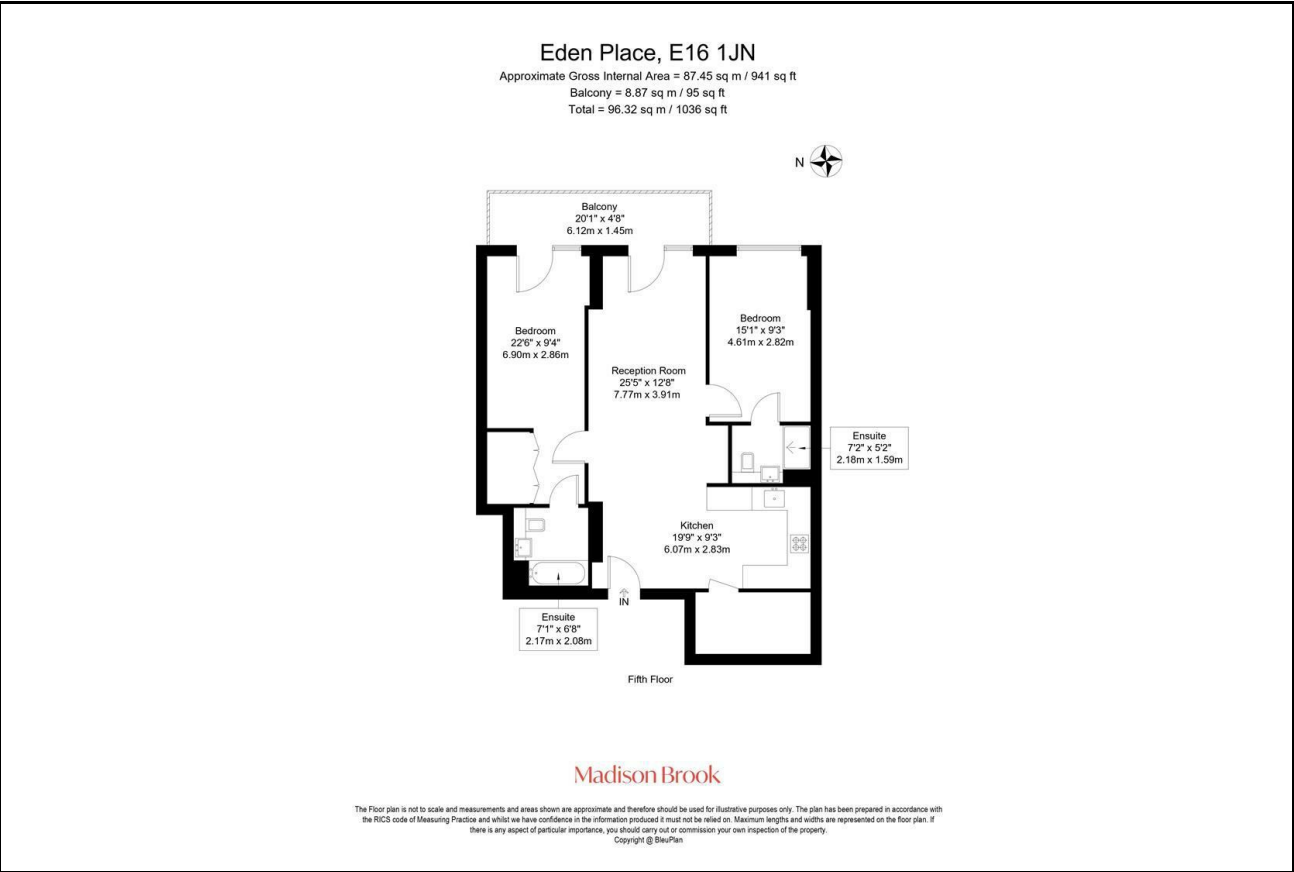

Area Map

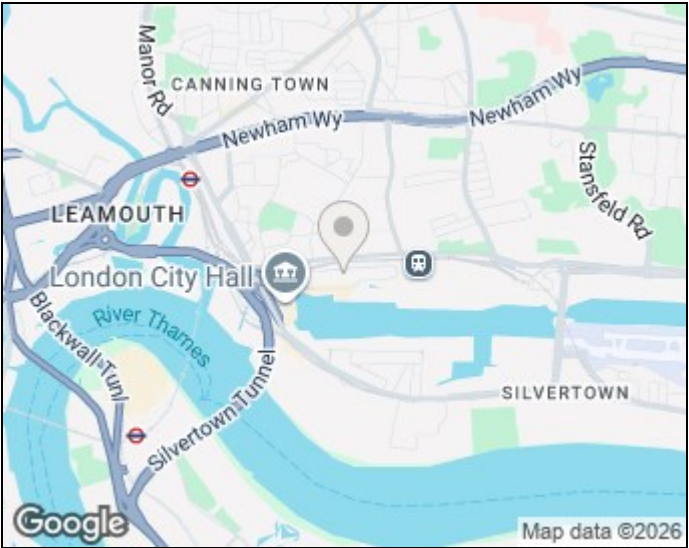

Energy Efficiency Graph

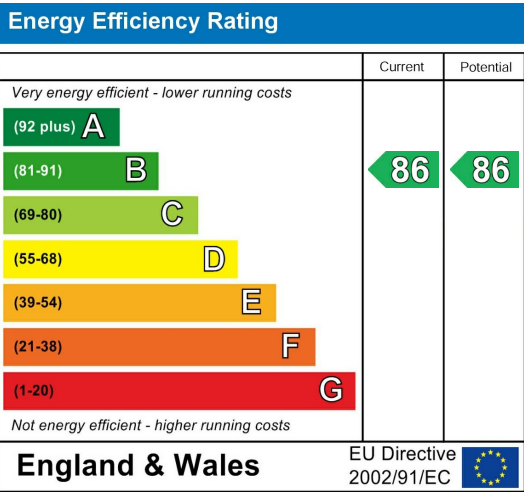

These particulars, whilst believed to be accurate are set out as a general outline only for guidance and do not constitute any part of an offer or contract. Intending purchasers should not rely on them as statements of representation of fact, but must satisfy themselves by inspection or otherwise as to their accuracy. No person in this firms employment has the authority to make or give any representation or warranty in respect of the property.

Unit B 20 Western Gateway, Royal Victoria
Dock, London, E16 1BS
Tel: 020 3946 6000 Email:
docklands@madisonbrook.com
<https://madisonbrook.com/>