

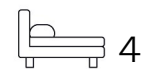

Living
made
better

The Square
Loughton, IG10 3FE



£2,650 PCM

The Square, Loughton, IG10 3FE

Madison Brook

Property Summary

A modernised four-bedroom family home arranged over three floors and located in a popular area of Loughton, Essex. The property has been refurbished throughout and offers flexible accommodation including a reception room, contemporary kitchen, four bedrooms, two bathrooms and a guest WC. Additional benefits include a private rear garden and off-street parking.

Ideally located close to local amenities, shops, cafes and restaurants. Offered furnished and available from 22nd January 2026.

Floorplan

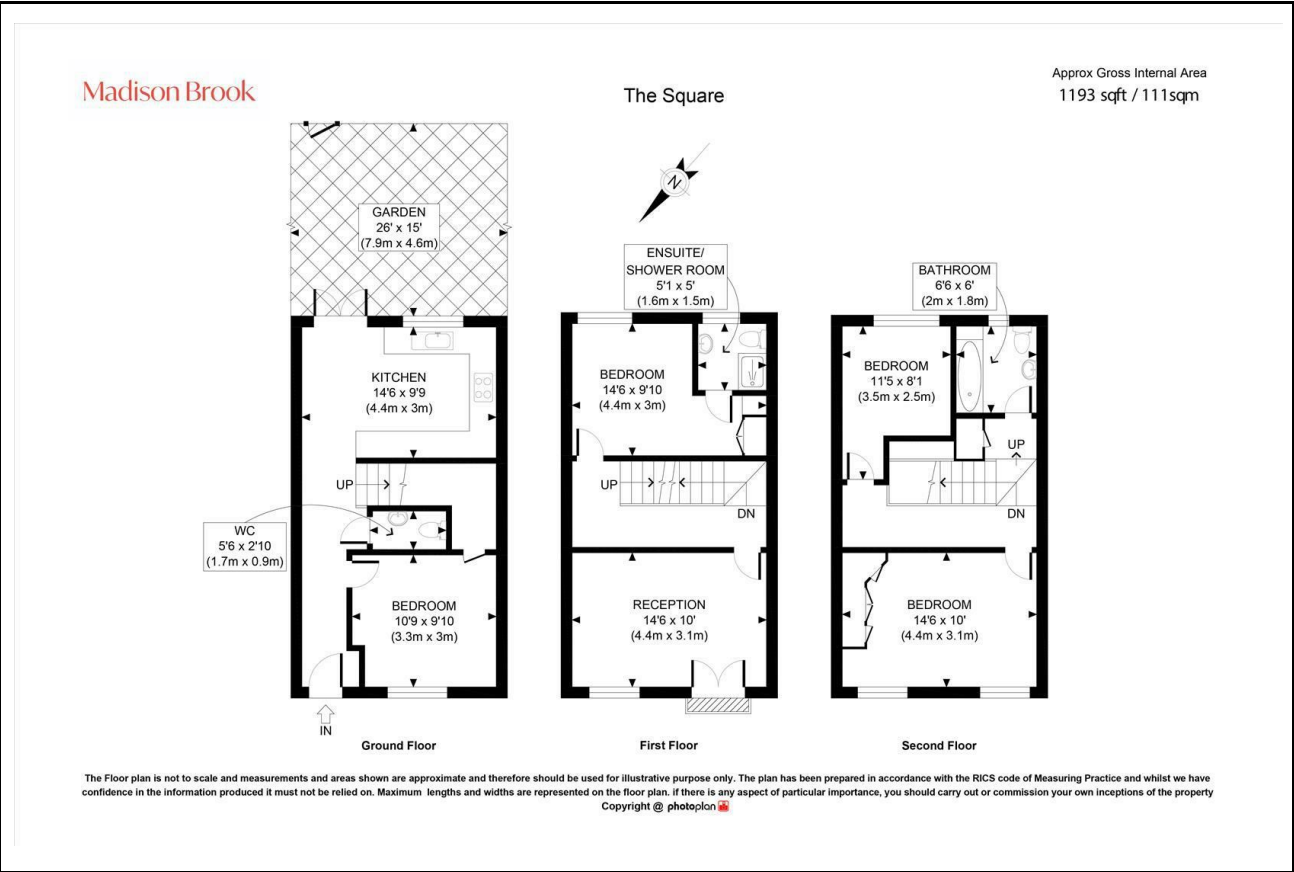

Area Map

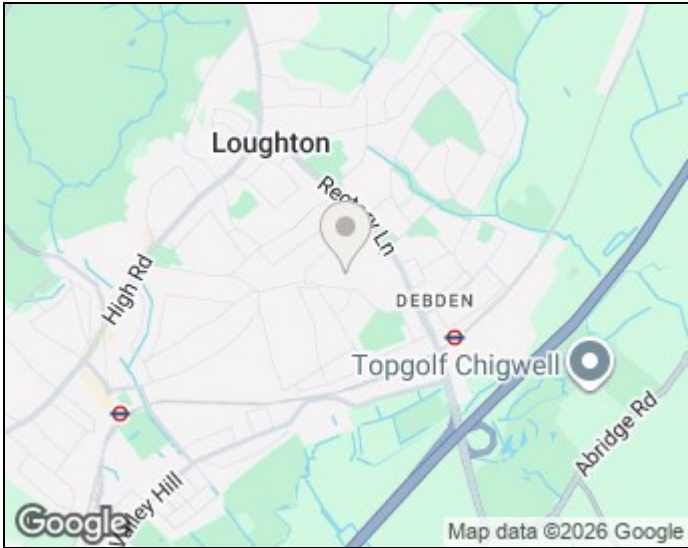

Energy Efficiency Graph

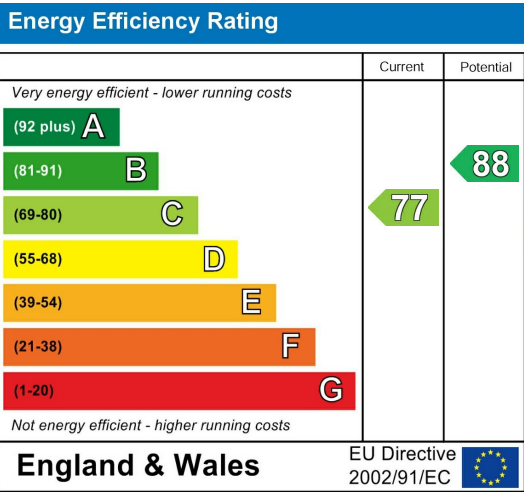

These particulars, whilst believed to be accurate are set out as a general outline only for guidance and do not constitute any part of an offer or contract. Intending purchasers should not rely on them as statements of representation of fact, but must satisfy themselves by inspection or otherwise as to their accuracy. No person in this firm's employment has the authority to make or give any representation or warranty in respect of the property.

Unit B 20 Western Gateway, Royal Victoria
Dock, London, E16 1BS
Tel: 020 3946 6000 Email:
docklands@madisonbrook.com
<https://madisonbrook.com/>