

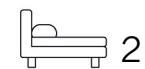

Living  
made  
better

## Meadow Court

Royal Victoria Dock, E16 2FW



£2,500 Per Calendar Month



# Meadow Court, Royal Victoria Dock, E16 2FW

Madison Brook

## Property Summary

Located in the desirable Waterside Park development, this modern two-bedroom maisonette offers flexible living across two floors, with the added benefit of dual private entrances. The ground floor features a spacious open-plan reception and kitchen area with integrated appliances, a movable island, and a guest WC. The upper level comprises a generous principal bedroom with en-suite and private balcony, a second double bedroom, and a stylish family bathroom.

With a private front garden, rear patio, and an additional first-floor balcony, the property offers excellent outdoor space. Residents also benefit from a 24-hour concierge, access to a residents' gym, and close proximity to Thames Barrier Park, Pontoon Dock DLR, and Custom House Elizabeth Line.

## Floorplan

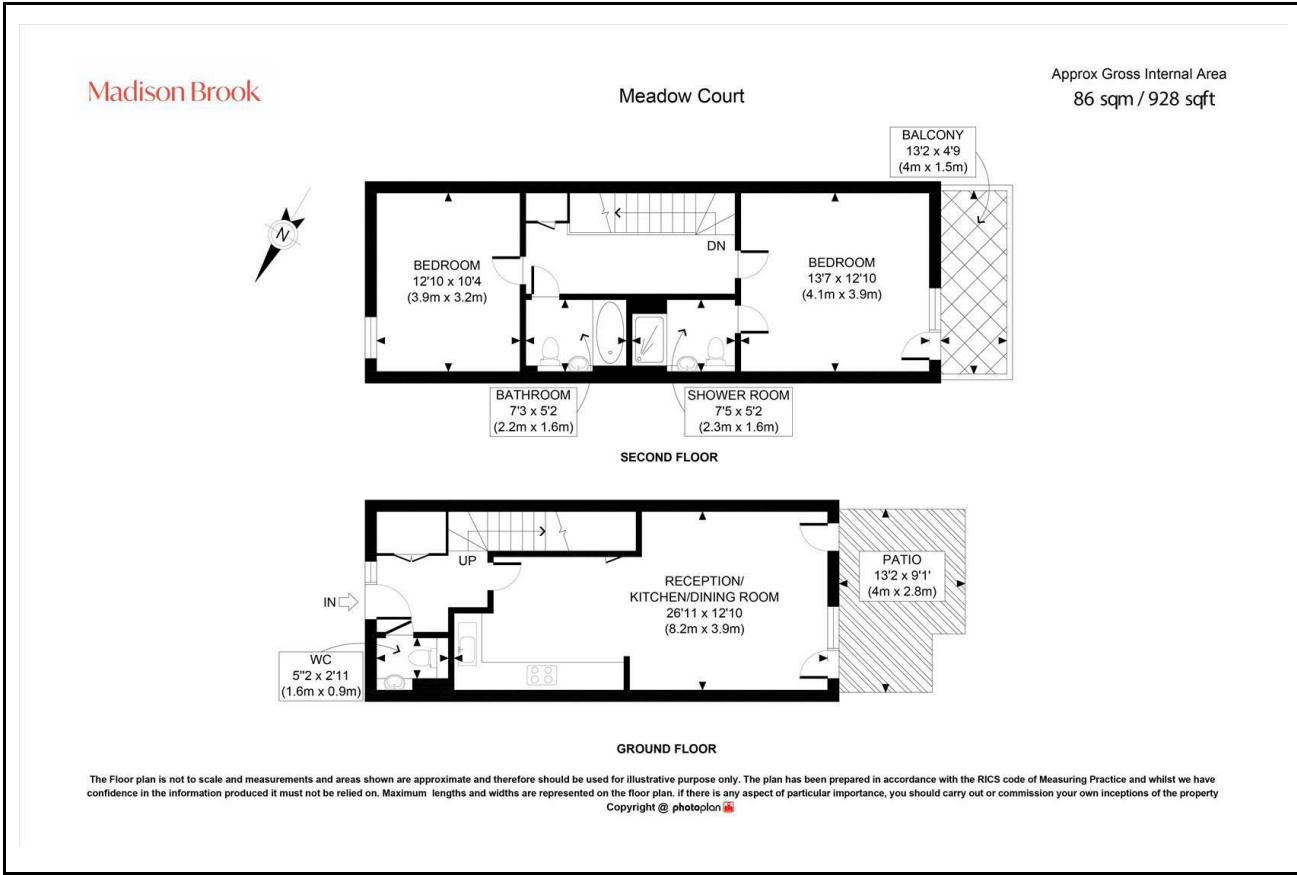

## Area Map

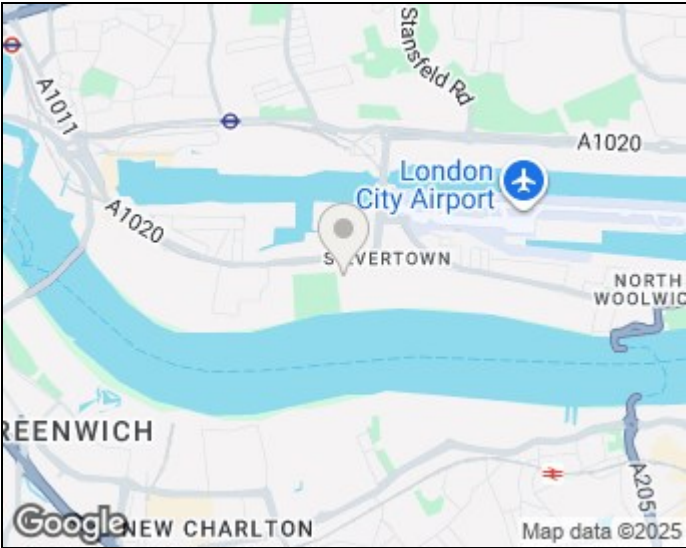

## Energy Efficiency Graph

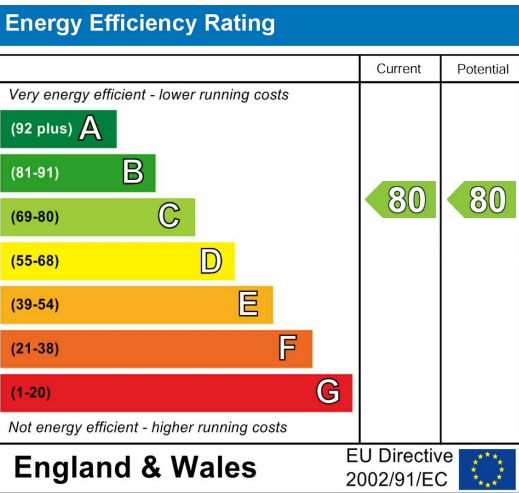

These particulars, whilst believed to be accurate are set out as a general outline only for guidance and do not constitute any part of an offer or contract. Intending purchasers should not rely on them as statements of representation of fact, but must satisfy themselves by inspection or otherwise as to their accuracy. No person in this firm's employment has the authority to make or give any representation or warranty in respect of the property.

Unit B 20 Western Gateway, Royal Victoria  
Dock, London, E16 1BS  
Tel: 020 3946 6000 Email:  
docklands@madisonbrook.com  
<https://madisonbrook.com/>