



Living
made
better

Fathom Court
Gallions Reach, E16 2FF



Asking Price £475,000

Fathom Court, Gallions Reach, E16 2FF

Madison Brook

Property Summary

Located on the sixth floor of a luxury dockside development, this two-bedroom, two-bathroom apartment offers spacious living with sweeping water views and a private balcony. The property has been recently refurbished with Amtico flooring in the living space and new carpets in the bedrooms. The open-plan reception and fully integrated L-shaped kitchen are ideal for entertaining, with access to a generous balcony overlooking the marina. The principal bedroom features an en-suite shower room and built-in wardrobes, while the second double bedroom is served by a modern family bathroom.

Additional benefits include a large storage cupboard, secure underground parking, and access to a 24-hour concierge, communal gardens, and on-site amenities. Moments from Gallions Reach DLR with fast links to Canary Wharf and the City.

Floorplan

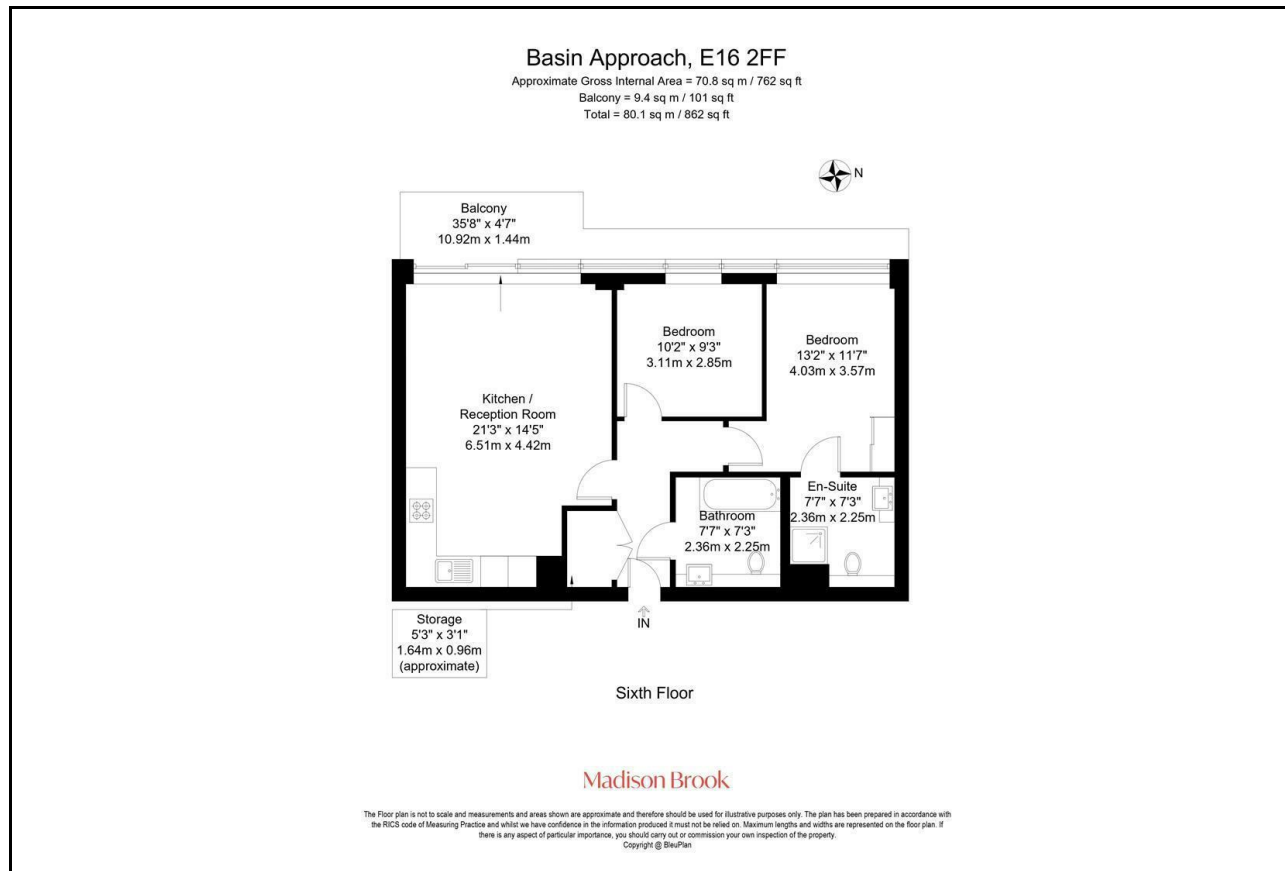

These particulars, whilst believed to be accurate are set out as a general outline only for guidance and do not constitute any part of an offer or contract. Intending purchasers should not rely on them as statements of representation of fact, but must satisfy themselves by inspection or otherwise as to their accuracy. No person in this firm's employment has the authority to make or give any representation or warranty in respect of the property.

Area Map

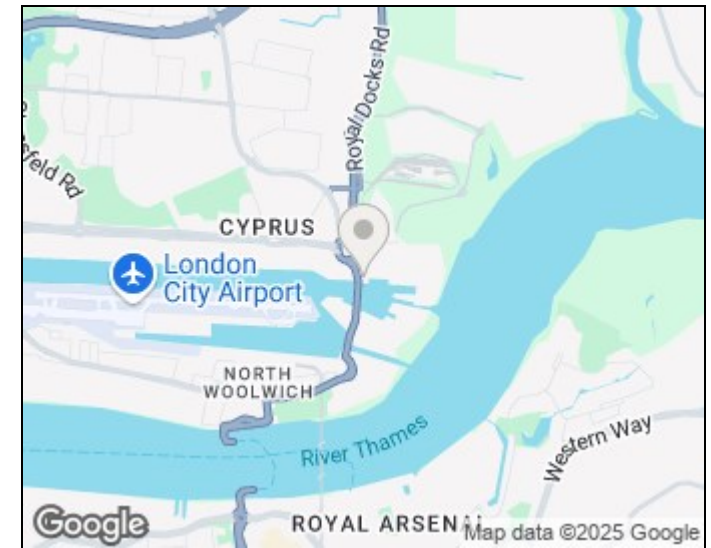

Energy Efficiency Graph

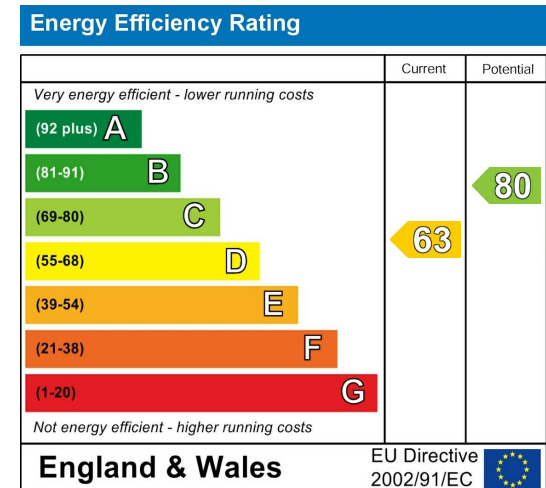

Unit B 20 Western Gateway, Royal Victoria
 Dock, London, E16 1BS
 Tel: 020 3946 6000 Email:
docklands@madisonbrook.com
<https://madisonbrook.com/>