

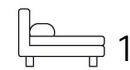

Living  
made  
better

Discovery Tower  
Canning Town, E16 1YH



£1,895 PCM

# Discovery Tower, Canning Town, E16 1YH

Madison Brook

## Property Summary

Set on the 17th floor of Discovery Tower in Hallsville Quarter, this smart one-bedroom apartment features a south-facing private balcony, stylish interiors, and excellent on-site amenities. The bright open-plan layout includes a well-equipped kitchen and spacious lounge leading to the balcony, ideal for relaxing or entertaining.

Just a short walk to Canning Town Station (Jubilee & DLR), the location offers easy access to Canary Wharf and Central London. Ideal for professional tenants seeking contemporary living in a thriving location.

## Floorplan

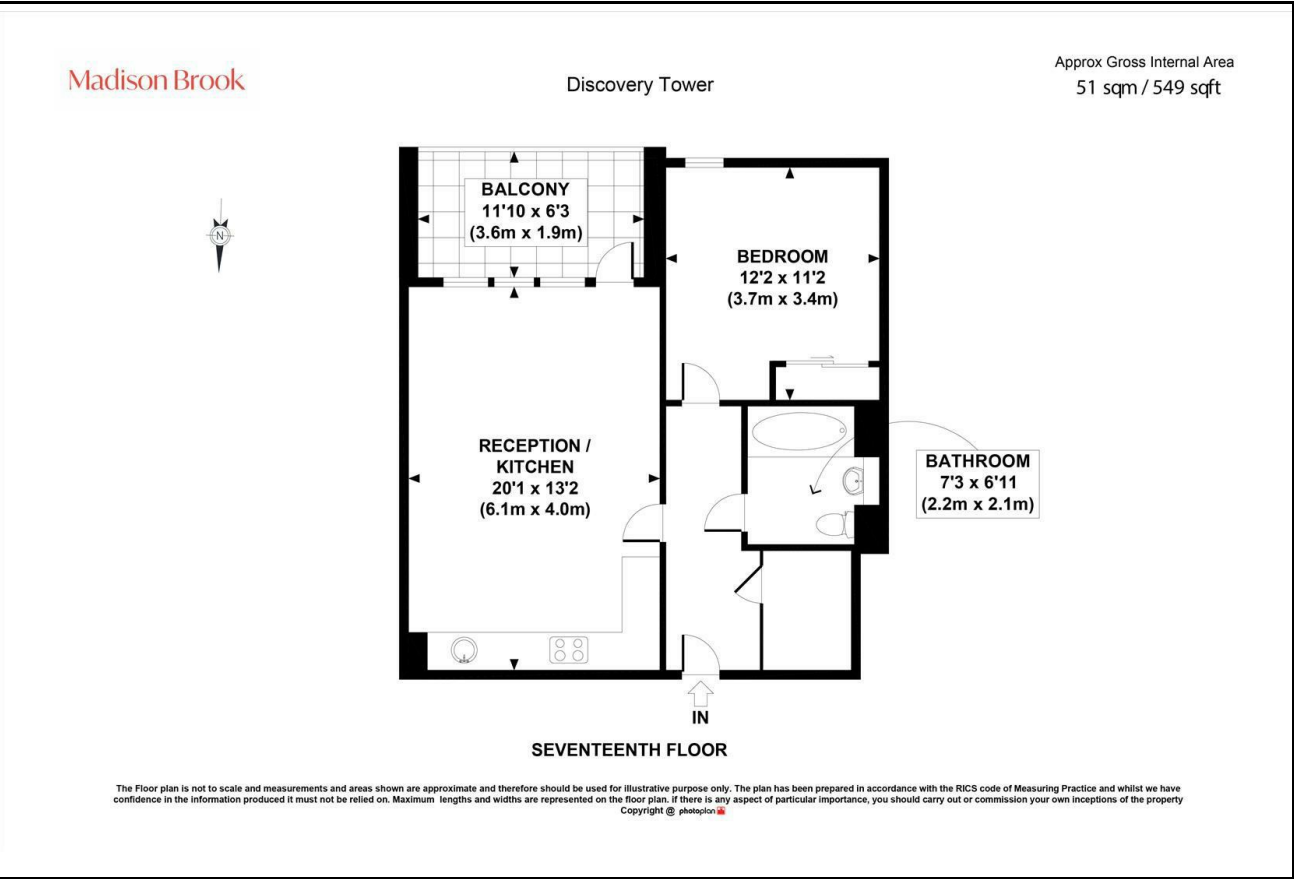

## Area Map

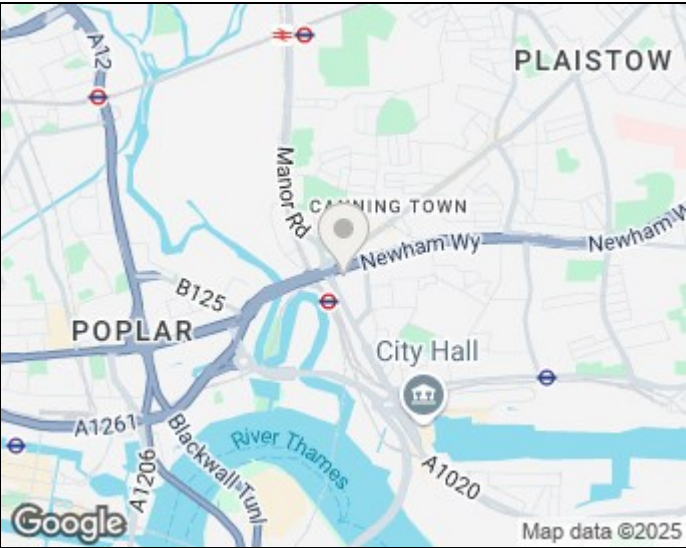

## Energy Efficiency Graph

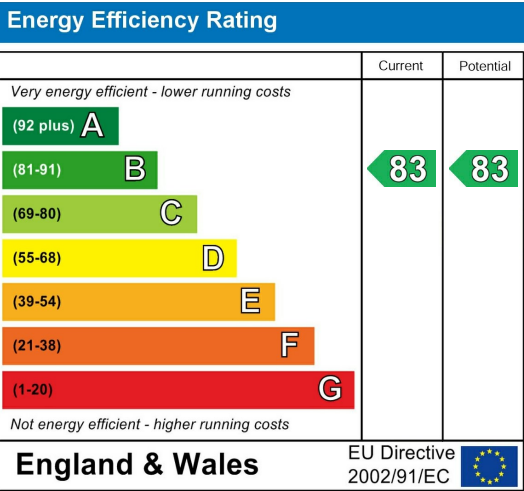

These particulars, whilst believed to be accurate are set out as a general outline only for guidance and do not constitute any part of an offer or contract. Intending purchasers should not rely on them as statements of representation of fact, but must satisfy themselves by inspection or otherwise as to their accuracy. No person in this firm's employment has the authority to make or give any representation or warranty in respect of the property.

Unit B 20 Western Gateway, Royal Victoria  
Dock, London, E16 1BS  
Tel: 020 3946 6000 Email:  
docklands@madisonbrook.com  
<https://madisonbrook.com/>