

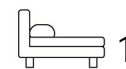

Living
made
better

Luxe Tower
Aldgate, E1 8QU



£2,350 PCM

Luxe Tower, Aldgate, E1 8QU

Madison Brook

Property Summary

This modern one-bedroom apartment is set on the tenth floor of a prestigious development, offering breathtaking City views through its floor-to-ceiling windows. Designed for contemporary living, the apartment features an open-plan kitchen and living area, a spacious bedroom, and high-quality finishes throughout.

Residents enjoy access to a 24-hour concierge service and an onsite gymnasium, ensuring both comfort and convenience. Allocated parking is available, adding to the practicality of this fantastic home.

Floorplan

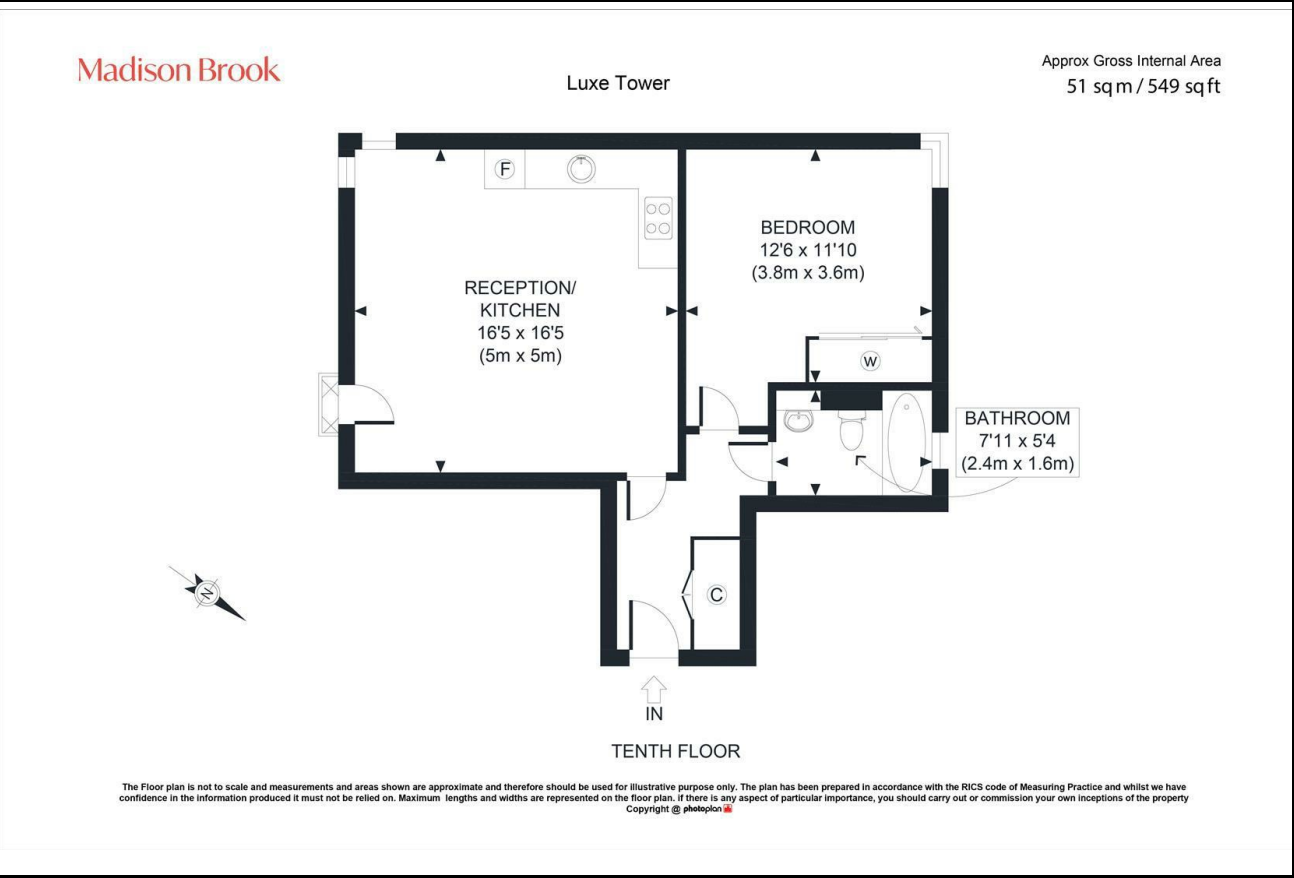

These particulars, whilst believed to be accurate are set out as a general outline only for guidance and do not constitute any part of an offer or contract. Intending purchasers should not rely on them as statements of representation of fact, but must satisfy themselves by inspection or otherwise as to their accuracy. No person in this firm's employment has the authority to make or give any representation or warranty in respect of the property.

Area Map



Energy Efficiency Graph

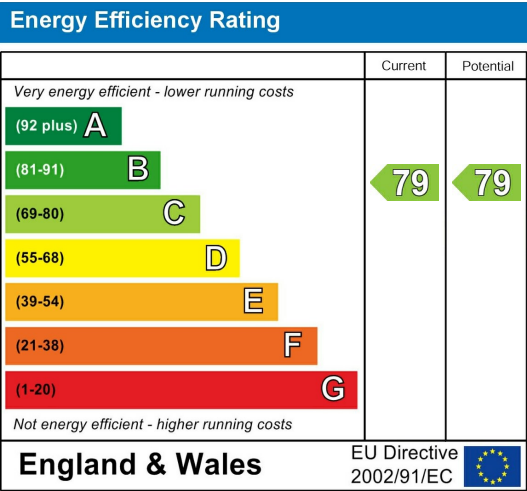

Unit B 20 Western Gateway, Royal Victoria
Dock, London, E16 1BS
Tel: 020 3946 6000 Email:
docklands@madisonbrook.com
<https://madisonbrook.com/>