



Living
made
better

Defoe House
London City Island, E14 0TX



Offers In Excess Of £625,000

Defoe House, London City Island, E14 OTX

Madison Brook

Property Summary

Set on the 17th floor of London City Island’s sought-after Defoe House, this brand-new two-bedroom apartment boasts 844 sq. ft. of contemporary living space, including a private balcony with breathtaking North-Easterly views over The City, Canning Town, and the River Lea.

Designed with a warehouse-inspired aesthetic, the apartment offers open-plan living, premium finishes, and industrial loft-style details. The bespoke kitchen features integrated appliances and ample storage, while both double bedrooms provide a peaceful retreat, with the principal bedroom enjoying an en-suite bathroom.

Floorplan

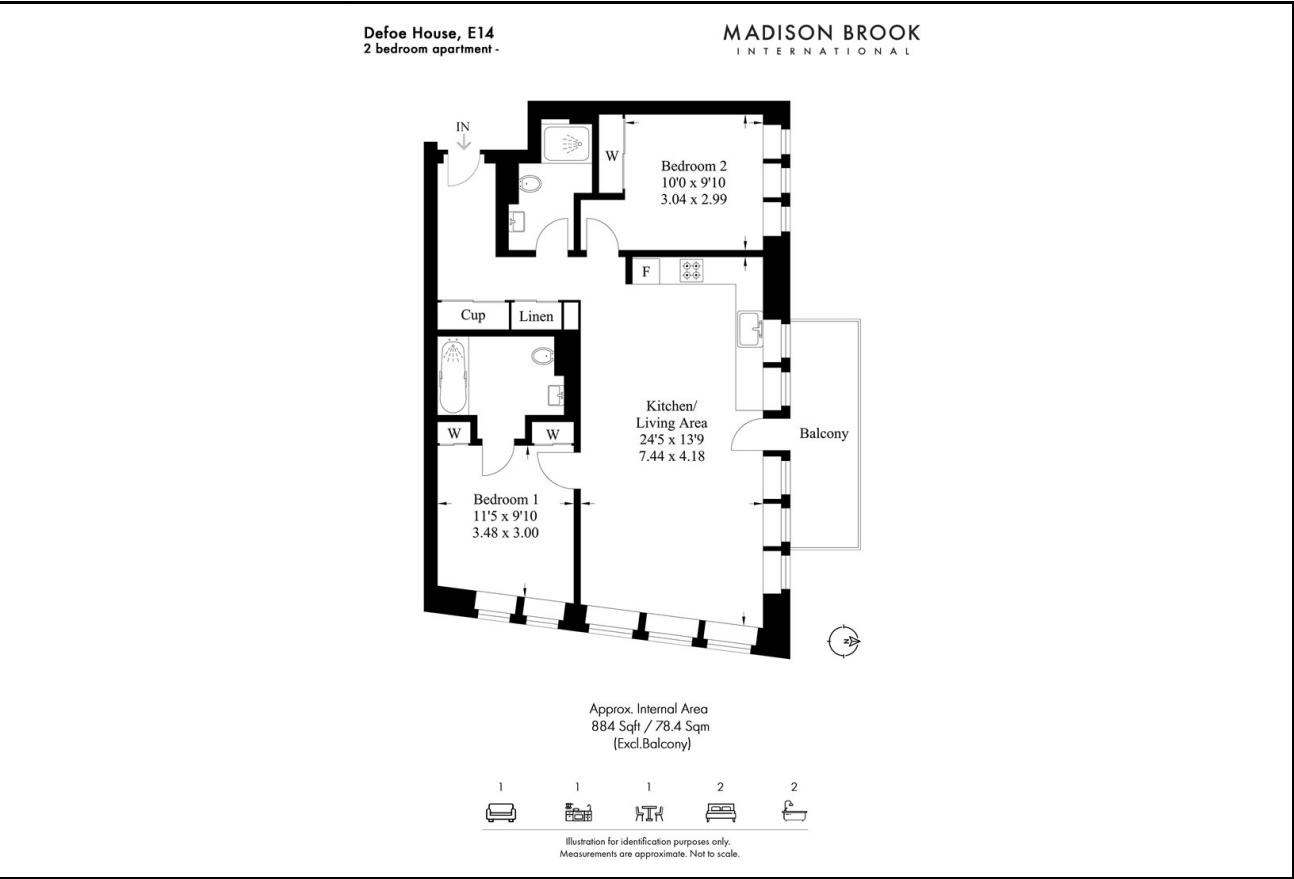

Area Map

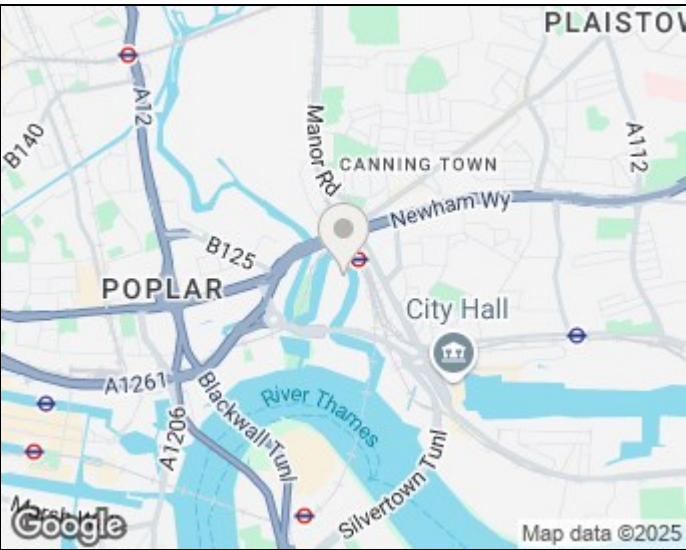

Energy Efficiency Graph

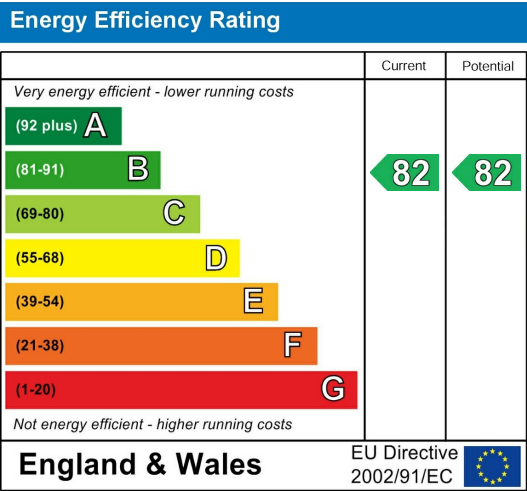

These particulars, whilst believed to be accurate are set out as a general outline only for guidance and do not constitute any part of an offer or contract. Intending purchasers should not rely on them as statements of representation of fact, but must satisfy themselves by inspection or otherwise as to their accuracy. No person in this firm's employment has the authority to make or give any representation or warranty in respect of the property.

Unit B 20 Western Gateway, Royal Victoria
Dock, London, E16 1BS
Tel: 020 3946 6000 Email:
docklands@madisonbrook.com
<https://madisonbrook.com/>