

Living
made
better

Corson House
London City Island, E14 0TP

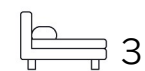

Asking Price £995,000

Corson House, London City Island, E14 OTP

Madison Brook

Property Summary

Welcome to this luxury three-bedroom home on the 21st floor of Corson House, London City Island. Meticulously renovated, the property offers panoramic views of Canary Wharf, the River Thames, and West London from two private balconies.

Included with this exceptional home is secure parking and access to exclusive resident amenities including a gym, swimming pool, cinema, and landscaped gardens. Well-connected by the DLR and Elizabeth Line, with easy access to Canary Wharf and central London.

Floorplan

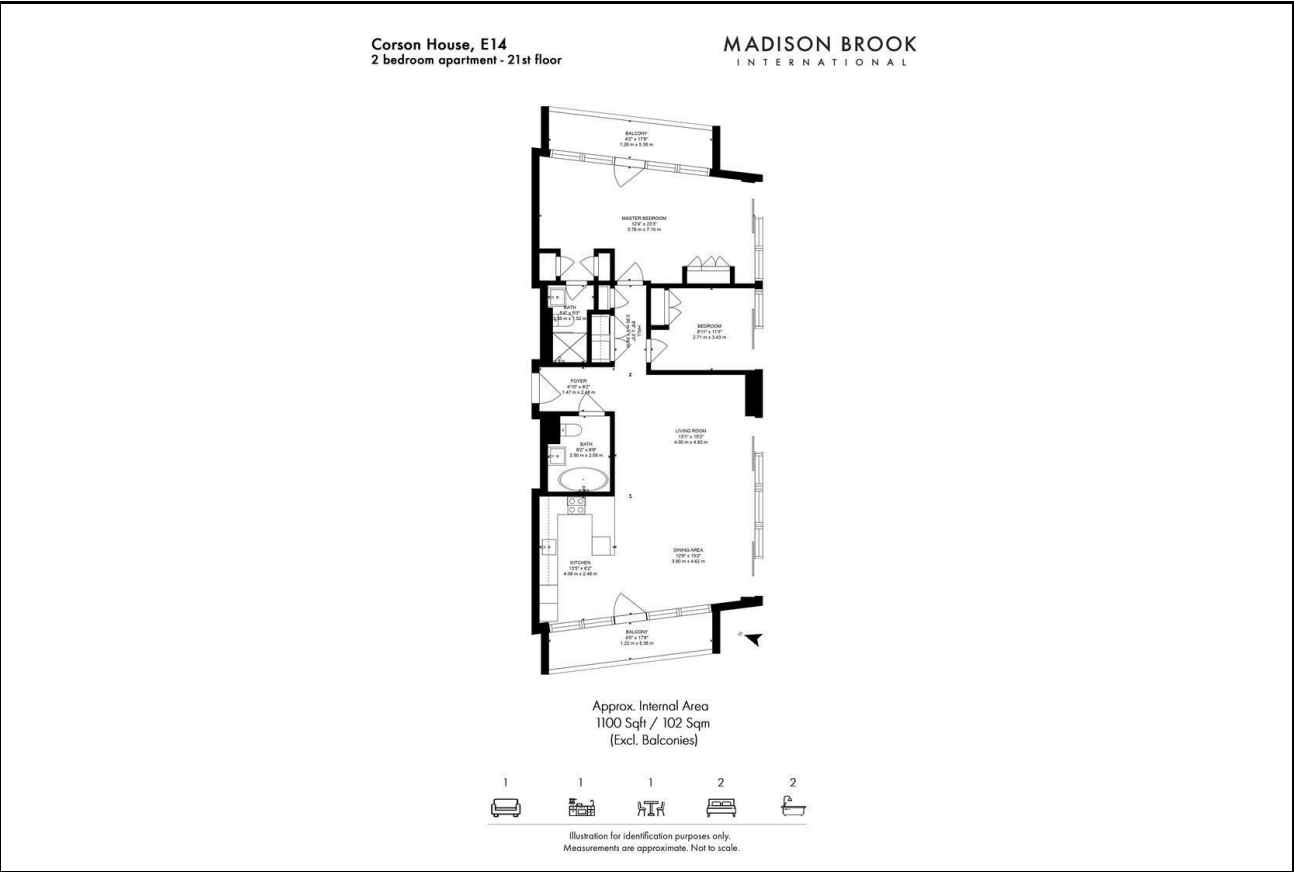

These particulars, whilst believed to be accurate are set out as a general outline only for guidance and do not constitute any part of an offer or contract. Intending purchasers should not rely on them as statements of representation of fact, but must satisfy themselves by inspection or otherwise as to their accuracy. No person in this firms employment has the authority to make or give any representation or warranty in respect of the property.

Area Map

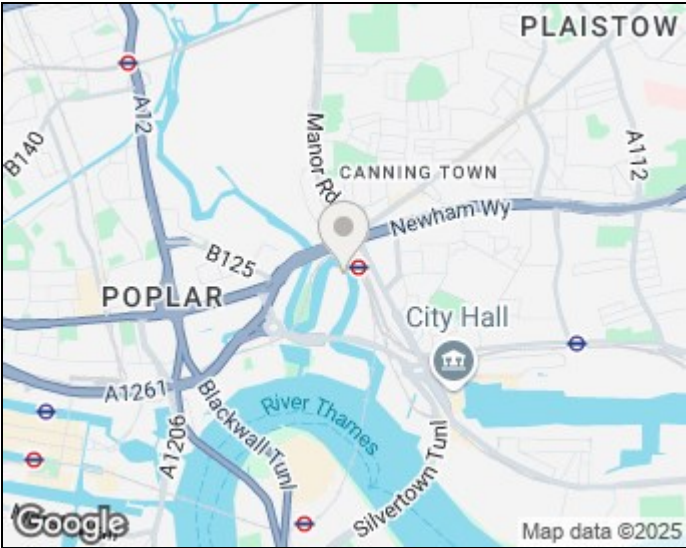

Energy Efficiency Graph

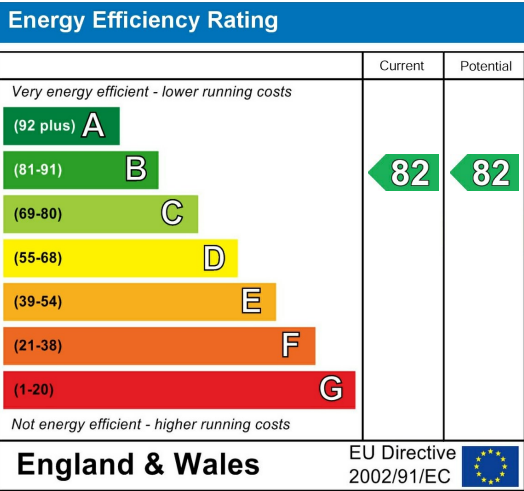

Unit B 20 Western Gateway, Royal Victoria
Dock, London, E16 1BS
Tel: 020 3946 6000 Email:
docklands@madisonbrook.com
<https://madisonbrook.com/>