



Living  
made  
better

Inverness Mews  
North Woolwich, E16 2SP



Offers In Excess Of £350,000

# Inverness Mews, North Woolwich, E16 2SP

Madison Brook

## Property Summary

This stunning two bedroom, two bathroom apartment is located on an enviable raised ground floor and boasts beautiful uninterrupted and tranquil river views.

Situated over 728 Sq. Ft of internal living space, the property offers a bright, open plan, living and kitchen area leading to a private balcony where you enjoy the views of the outdoor spaces and the River Thames.

## Floorplan

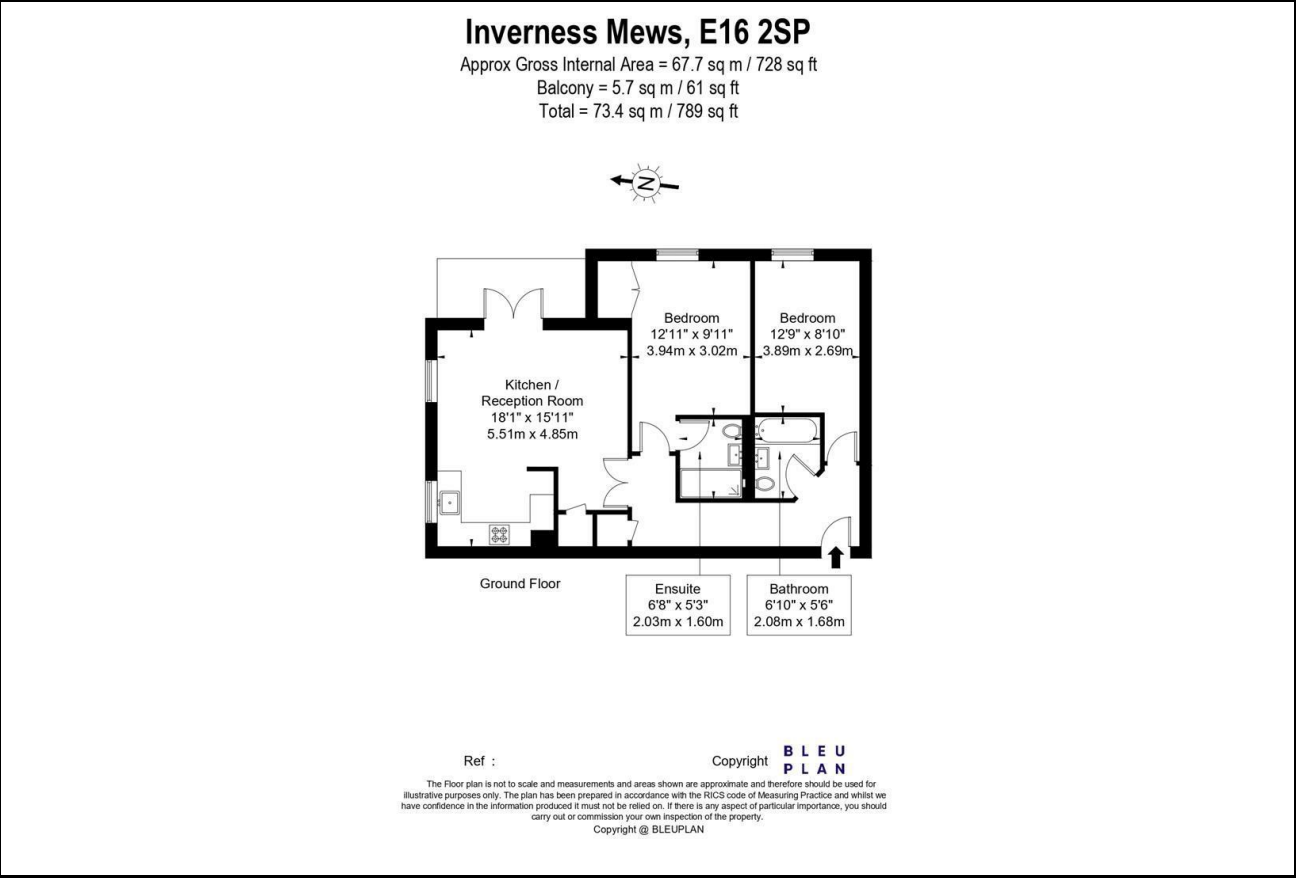

## Area Map

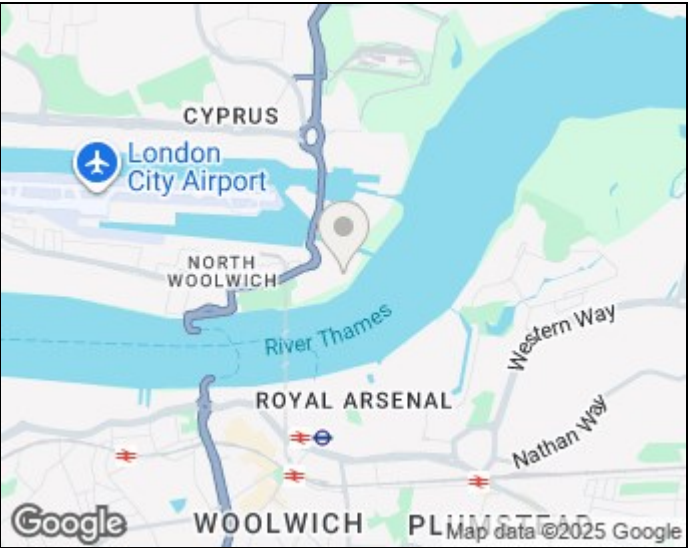

## Energy Efficiency Graph

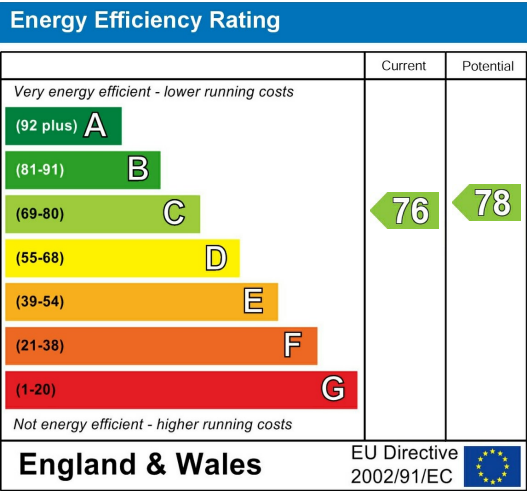

These particulars, whilst believed to be accurate are set out as a general outline only for guidance and do not constitute any part of an offer or contract. Intending purchasers should not rely on them as statements of representation of fact, but must satisfy themselves by inspection or otherwise as to their accuracy. No person in this firms employment has the authority to make or give any representation or warranty in respect of the property.

Unit B 20 Western Gateway, Royal Victoria  
Dock, London, E16 1BS  
Tel: 020 3946 6000 Email:  
docklands@madisonbrook.com  
<https://madisonbrook.com/>