



Maytree Close
Rainham, RM13 8EP
£2,000 PCM



MADISON BROOK
INTERNATIONAL

Maytree Close, Rainham, RM13 8EP

This beautiful, completely refurbished three bedroom ground floor flat is available immediately in Maytree Close, Rainham.

Comprising three double bedrooms, modern fitted grey kitchen with stone worktops, integrated appliances, chic family bathroom and benefitting from a redecorated throughout with allocated parking.

Maytree Close is close to local amenities, Rainham Overground and Dagenham East Station, whilst the Chase Nature Reserve and Beam Parklands are within minutes travel.



These particulars, whilst believed to be accurate are set out as a general outline only for guidance and do not constitute any part of an offer or contract. Intending purchasers should not rely on them as statements of representation of fact, but must satisfy themselves by inspection or otherwise as to their accuracy. No person in this firm's employment has the authority to make or give any representation or warranty in respect of the property.

20 Western Gateway, Royal Victoria Dock, London, E16 1BS

Tel: 020 3946 6000 Email: docklands@madisonbrook.com <https://madisonbrook.com/>

Floor Plan

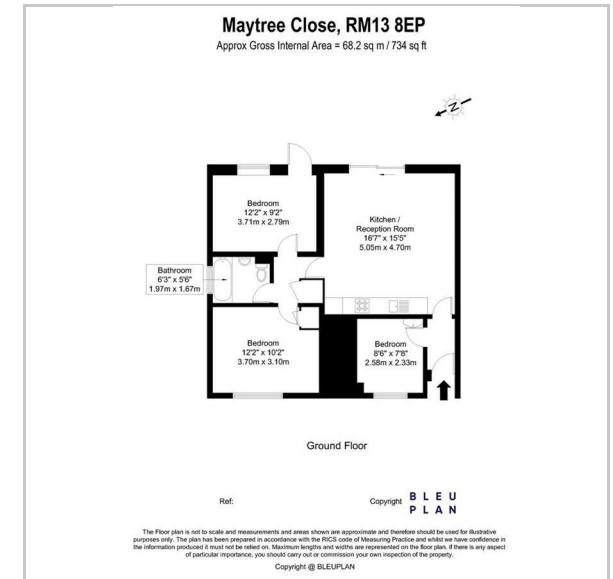

Area Map

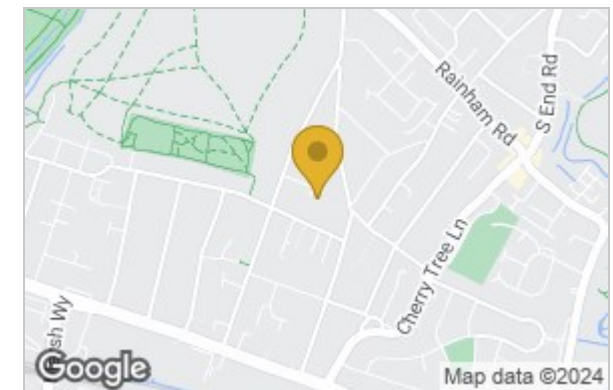

Energy Efficiency Graph

