



The Oxygen

18 Western Gateway, Royal Victoria Dock, E16 1BQ

Offers In The Region Of £775,000



MADISON BROOK
INTERNATIONAL

The Oxygen, 18 Western Gateway, Royal Victoria Dock, E16 1BQ

Flooded with natural light through floor-to-ceiling windows, this contemporary tenth floor, 1050sq ft three bedroomed apartment features a smart open-plan kitchen with a good selection of integrated appliances as well as a private balcony.

The property also comprises stylish reception room, three bright and well proportioned bedrooms, one with access to balcony and the other an en suite shower room and master bathroom. Development features include intercom security systems and concierge.

Oxygen Apartments is perfectly placed for use of the many attractions that can be found in and around the Royal Docks, including local bars, restaurants, the Emirates Cable Car, Siemens Crystal & Excel London Exhibition Centre.

Local transport links include Royal Victoria & Custom House Station (DLR), Canning Town (Jubilee) and a selection of useful A roads for access into the city and Canary Wharf.



These particulars, whilst believed to be accurate are set out as a general outline only for guidance and do not constitute any part of an offer or contract. Intending purchasers should not rely on them as statements of representation of fact, but must satisfy themselves by inspection or otherwise as to their accuracy. No person in this firm's employment has the authority to make or give any representation or warranty in respect of the property.

20 Western Gateway, Royal Victoria Dock, London, E16 1BS

Tel: 020 3946 6000 Email: docklands@madisonbrook.com <https://madisonbrook.com/>

Floor Plan

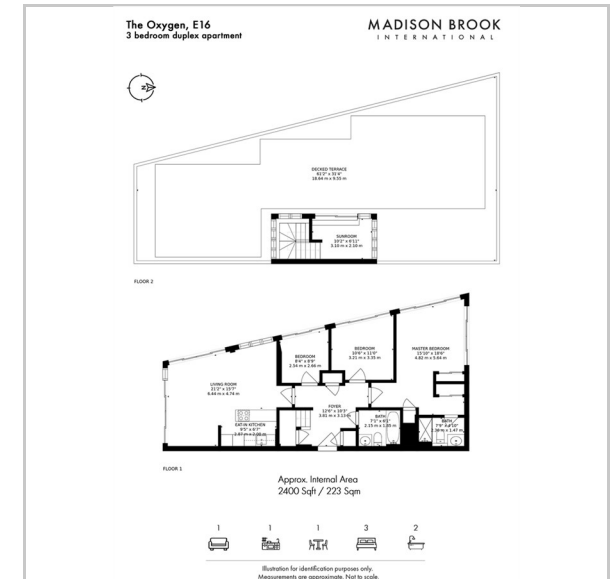

Area Map

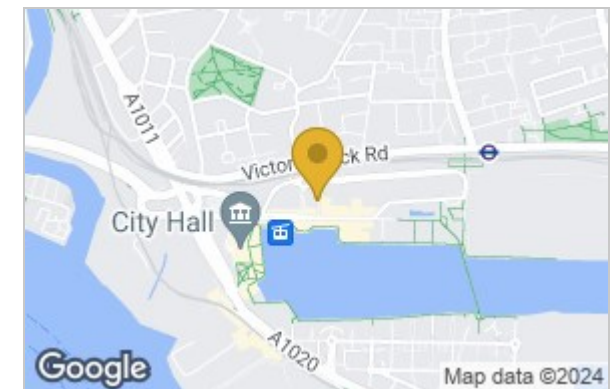

Energy Efficiency Graph

