



## The Oxygen Apartments

18 Western Gateway, Royal Victoria Dock, E16 1BL

£1,700 (From) PCM



**MADISON BROOK**  
INTERNATIONAL

# The Oxygen Apartments, 18 Western Gateway, Royal Victoria Dock, E16 1BL

This stylish one bedroom flat situated on the first floor of a modern dockside development and benefiting from open-plan living with balcony, good-sized bedroom with sizeable built-in storage cupboards and underfloor heating.

This property has been very well cared for & offers modern living with a private terrace with space to dine, whilst both bathroom & kitchen are finished to a modern standard with quality fittings being used throughout.

Conveniently situated to local amenities and transport in the Royal Docks. Close to the cable cars and water sports centre. The shops, bars and restaurants in Canary Wharf are easily reached by public transport.



These particulars, whilst believed to be accurate are set out as a general outline only for guidance and do not constitute any part of an offer or contract. Intending purchasers should not rely on them as statements of representation of fact, but must satisfy themselves by inspection or otherwise as to their accuracy. No person in this firm's employment has the authority to make or give any representation or warranty in respect of the property.

20 Western Gateway, Royal Victoria Dock, London, E16 1BS  
 Tel: 020 3946 6000 Email: docklands@madisonbrook.com <https://madisonbrook.com/>

## Floor Plan

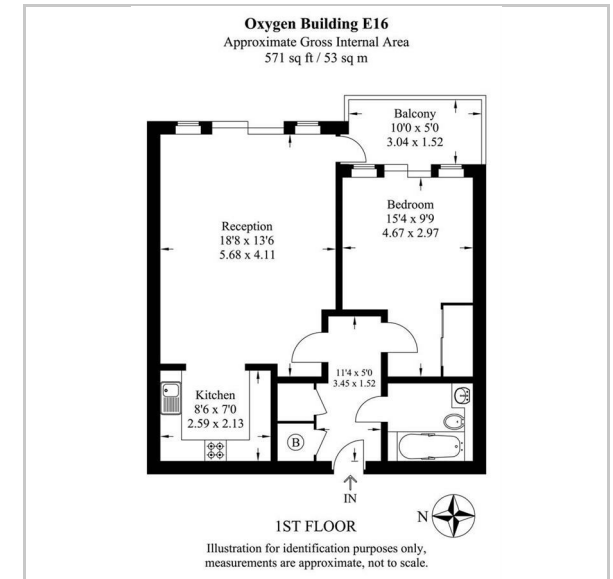

## Area Map

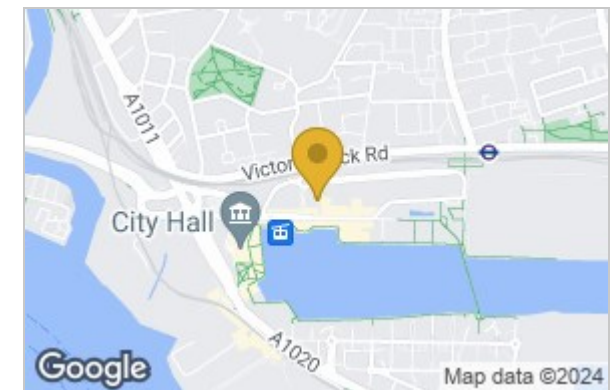

## Energy Efficiency Graph

