



28 Western Gateway
Royal Victoria Dock, London, E16 1YL
Asking Price £425,000



MADISON BROOK
INTERNATIONAL

28 Western Gateway, Royal Victoria Dock, London, E16 1YL

This stunning one bedroom apartment is located on the 6th floor and benefits from a sizeable, private balcony.

Situated over 660 Sq. Ft internally, the property offers a modern, open plan living and kitchen area with integrated appliances, a well proportioned double bedroom with stylish built in wardrobe space and chic, three piece family bathroom. Additionally the apartment has ample storage throughout and a 24 hour concierge.

Gateway Tower is located in the stunning surrounds of Excel Marina, moments from the Emirates Cable Car & O2 Arena. Royal Victoria (DLR), Canning Town (Jubilee) are within easy reach & the new Elizabeth Line will also be moments walk away.



These particulars, whilst believed to be accurate are set out as a general outline only for guidance and do not constitute any part of an offer or contract. Intending purchasers should not rely on them as statements of representation of fact, but must satisfy themselves by inspection or otherwise as to their accuracy. No person in this firm's employment has the authority to make or give any representation or warranty in respect of the property.

20 Western Gateway, Royal Victoria Dock, London, E16 1BS
 Tel: 020 3946 6000 Email: docklands@madisonbrook.com <https://madisonbrook.com/>

Floor Plan

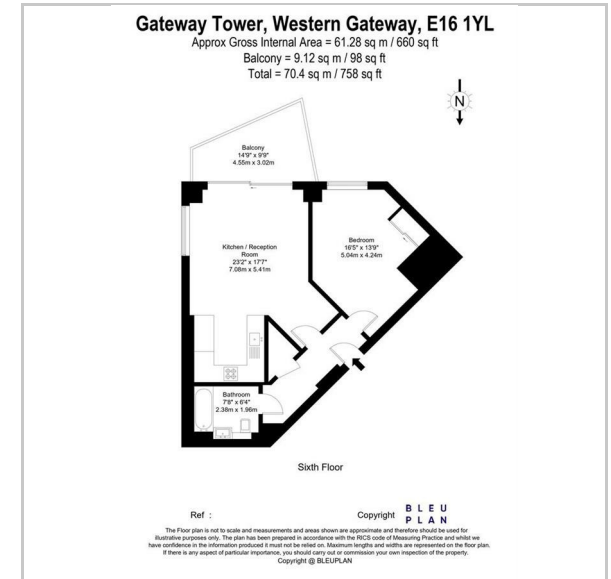

Area Map

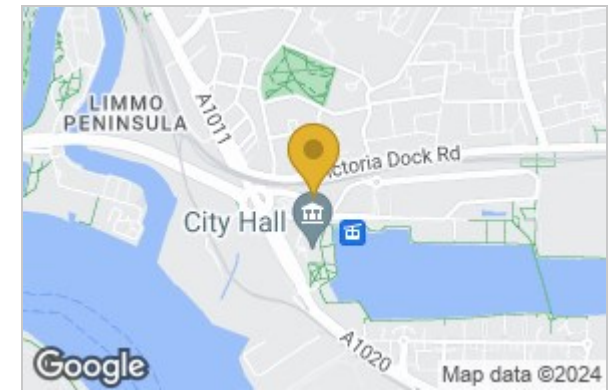

Energy Efficiency Graph

