



Bowes Lyon Hall

1 Wesley Avenue, London, E16 1SW

Guide Price £400,000



MADISON BROOK
INTERNATIONAL

Bowes Lyon Hall, 1 Wesley Avenue, London, E16 1SW

GUIDE PRICE £400,000-£415,000

This tastefully decorated 2 bedroom apartment is located on the 1st floor and benefits from a allocated parking space and a sizable, private terrace.

Situated over 586 Sq. Ft internally, this beautiful property offers two double bedrooms, which both lead out to the private terrace, a chic, well maintained family, bathroom, a bright, spacious living area and a separate, well equipped, modern kitchen.

Bowes Lyon Hall forms part of the Britannia Village development and is perfectly located for use of the many attractions that can be found in and around the Royal Docks, including local bars, restaurants, the Excel centre, while Canary Wharf is within easy reach, and the IFS Cloud Cable Car is just a short walk away, connecting you to the O2 Arena & Thames Clipper. Custom House DLR & Elizabeth Line are also nearby.



These particulars, whilst believed to be accurate are set out as a general outline only for guidance and do not constitute any part of an offer or contract. Intending purchasers should not rely on them as statements of representation of fact, but must satisfy themselves by inspection or otherwise as to their accuracy. No person in this firms employment has the authority to make or give any representation or warranty in respect of the property.

20 Western Gateway, Royal Victoria Dock, London, E16 1BS
 Tel: 020 3946 6000 Email: docklands@madisonbrook.com <https://madisonbrook.com/>

Floor Plan

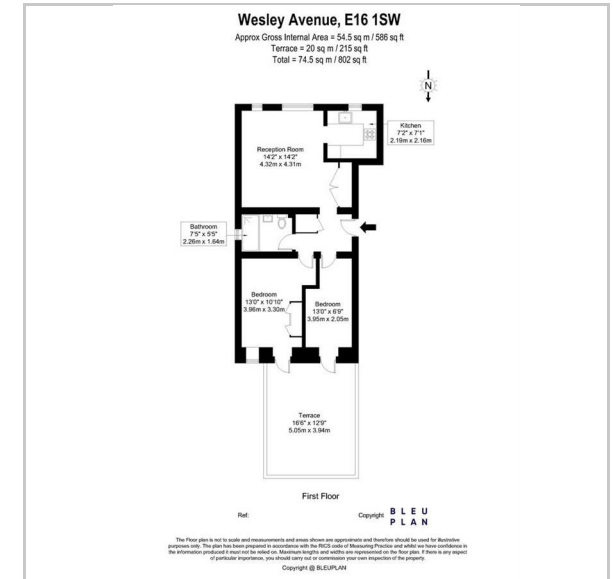

Area Map

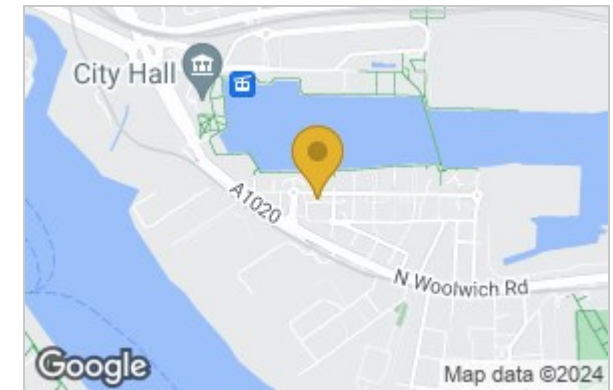

Energy Efficiency Graph

