



Warehouse W

3 Western Gateway, Royal Victoria Dock, E16 1BD

Guide Price £675,000



MADISON BROOK
INTERNATIONAL

Warehouse W, 3 Western Gateway, Royal Victoria Dock, E16 1BD

GUIDE PRICE £675,000-£700,000

This impressive two bedroom, two bathroom apartment is ideally located in a sought-after converted warehouse and offers stylish living space with original features and a modern finish.

Set on the second floor, the property comprises spacious reception room with double height ceiling and a stunning Juliet balcony, open-plan kitchen, sizable master bedroom, luxury en-suite bathroom, separate shower room, mezzanine level office space and one off street parking space.

Warehouse W is perfectly placed for use of the many attractions that can be found in and around the Royal Docks including the Excel centre, local bars, restaurants and a water sports centre.

Local transport links include Custom House Station (DLR) and a selection of useful A roads for access into the City and Canary Wharf.



These particulars, whilst believed to be accurate are set out as a general outline only for guidance and do not constitute any part of an offer or contract. Intending purchasers should not rely on them as statements of representation of fact, but must satisfy themselves by inspection or otherwise as to their accuracy. No person in this firm's employment has the authority to make or give any representation or warranty in respect of the property.

20 Western Gateway, Royal Victoria Dock, London, E16 1BS
 Tel: 020 3946 6000 Email: docklands@madisonbrook.com <https://madisonbrook.com/>

Floor Plan

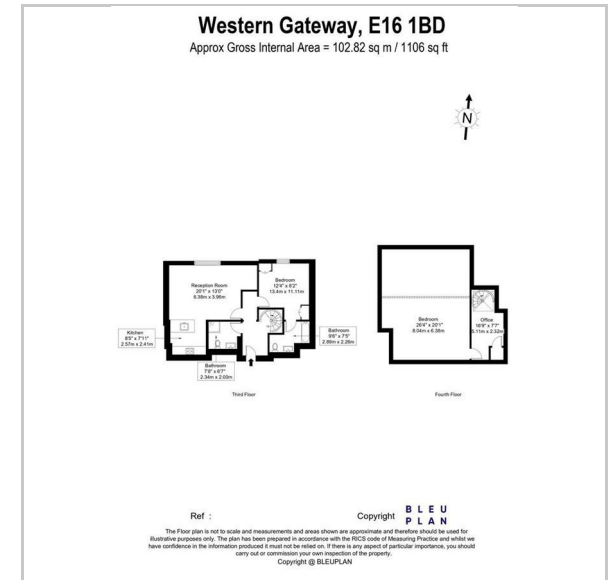

Area Map

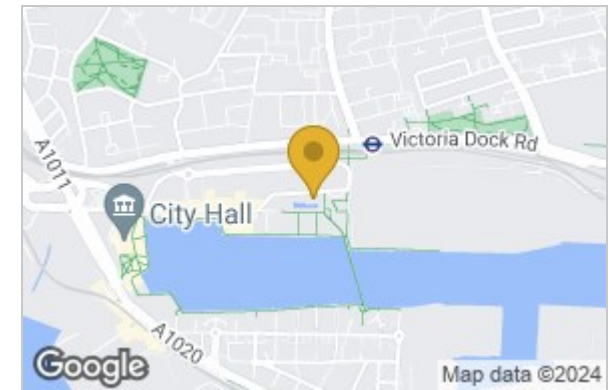

Energy Efficiency Graph

