



Sheerness Mews

, London, E16 2SR

£1,600 Per Calendar Month



MADISON BROOK
INTERNATIONAL

Sheerness Mews, London, E16 2SR

This one bedroom apartment is conveniently located on the dockside development of Sheerness Mews in North Woolwich and boasts over 660 Sq Ft of internal living space.

The apartment comprises of a large living and dining area leading to a private south facing balcony overlooking the Thames. The separate kitchen comes supplied with integrated appliances.

Sheerness Mews is conveniently located in North Woolwich moments away from King George DLR station with easy access into central London and beyond.



These particulars, whilst believed to be accurate are set out as a general outline only for guidance and do not constitute any part of an offer or contract. Intending purchasers should not rely on them as statements of representation of fact, but must satisfy themselves by inspection or otherwise as to their accuracy. No person in this firm's employment has the authority to make or give any representation or warranty in respect of the property.

20 Western Gateway, Royal Victoria Dock, London, E16 1BS
 Tel: 020 3946 6000 Email: docklands@madisonbrook.com <https://madisonbrook.com/>

Floor Plan

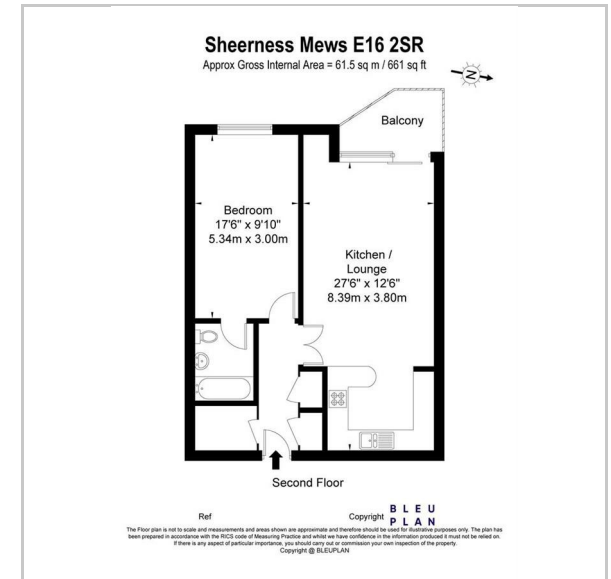

Area Map

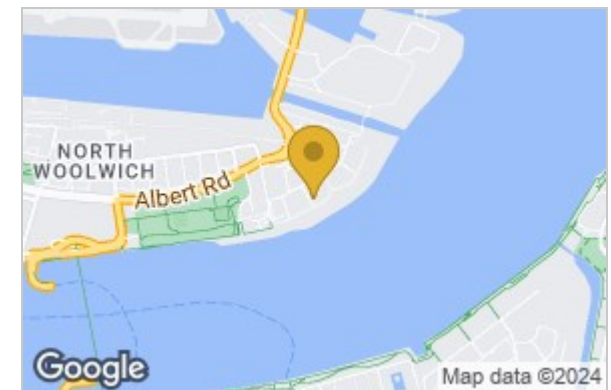

Energy Efficiency Graph

