



St. Annes Street  
London, E14 7QB

Asking Price £285,000



**MADISON BROOK**  
INTERNATIONAL

# St. Annes Street, London, E14 7QB

This well presented studio apartment is located on the 3rd floor of a modern development and is moments from the tranquil, Limehouse Cut.

The property comprises a bright, open plan living/sleeping area and kitchen with stylish, integrated appliances, a sizable double bedroom with access leading to the private balcony and a well maintained, three piece family bathroom. Additionally, the apartment has an onsite concierge and communal areas.

Birkdale House is located moments from Westferry and Limehouse DLR allowing easy access into Canary Wharf where you have many bars, restaurants and shops.



These particulars, whilst believed to be accurate are set out as a general outline only for guidance and do not constitute any part of an offer or contract. Intending purchasers should not rely on them as statements of representation of fact, but must satisfy themselves by inspection or otherwise as to their accuracy. No person in this firm's employment has the authority to make or give any representation or warranty in respect of the property.

20 Western Gateway, Royal Victoria Dock, London, E16 1BS  
 Tel: 020 3946 6000 Email: docklands@madisonbrook.com <https://madisonbrook.com/>

## Floor Plan

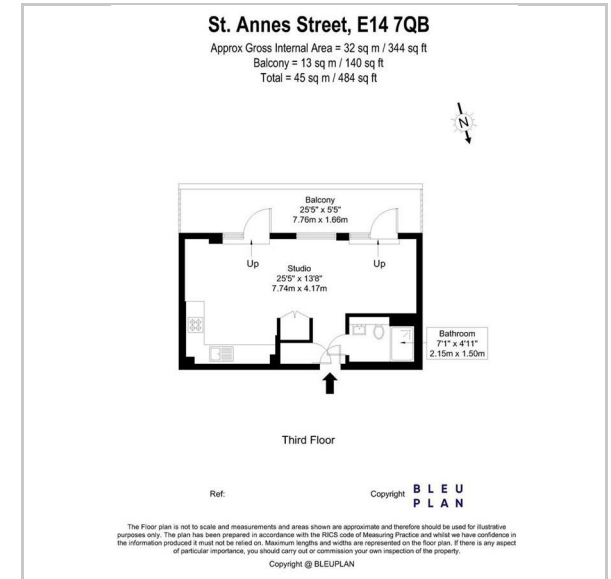

## Area Map

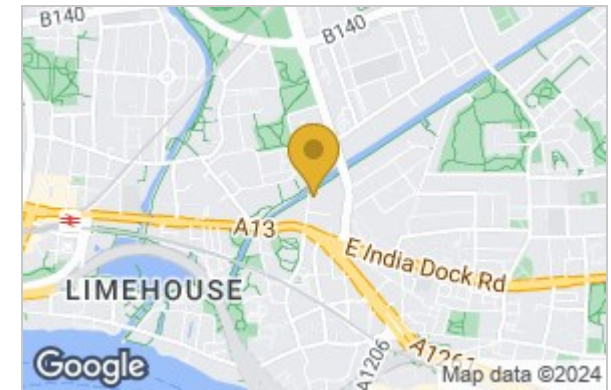

## Energy Efficiency Graph

