



Foundry House
Morris Road, London, E14 6NJ
Asking Price £800,000

2 1 1 C

MADISON BROOK
INTERNATIONAL

Foundry House, Morris Road, London, E14 6NJ

This exceptional, two bedroom penthouse is located on the 4th floor and forms part of the Spratts Factory warehouse conversion.

Boasting over 1,290 Sq Ft of internal living space, the property offers a bright, open plan living and kitchen area with stunning marble effect finishes and integrated appliances, an additional dining area and then a sizable, private terrace allowing beautiful views out to Canary Wharf. The property has two well proportioned double bedrooms, with built in wardrobe space, a stylish family bathroom and exposed brickwork throughout. Additionally, the apartment has an secure and gated parking space.

Foundry House is located moments from Chrisp Street where you can find many local amenities. You are within walking distance of Langdon Park and Devons Road DLR as well as short distance from Bromley-By-Bow.

- *Service Charge- £6,000.00 Per Annum.
- *Ground Rent- £200.00 Per Annum.
- *Lease Length- 970 Years Remaining.



These particulars, whilst believed to be accurate are set out as a general outline only for guidance and do not constitute any part of an offer or contract. Intending purchasers should not rely on them as statements of representation of fact, but must satisfy themselves by inspection or otherwise as to their accuracy. No person in this firm's employment has the authority to make or give any representation or warranty in respect of the property.

20 Western Gateway, Royal Victoria Dock, London, E16 1BS
 Tel: 020 3946 6000 Email: docklands@madisonbrook.com <https://madisonbrook.com/>

Floor Plan

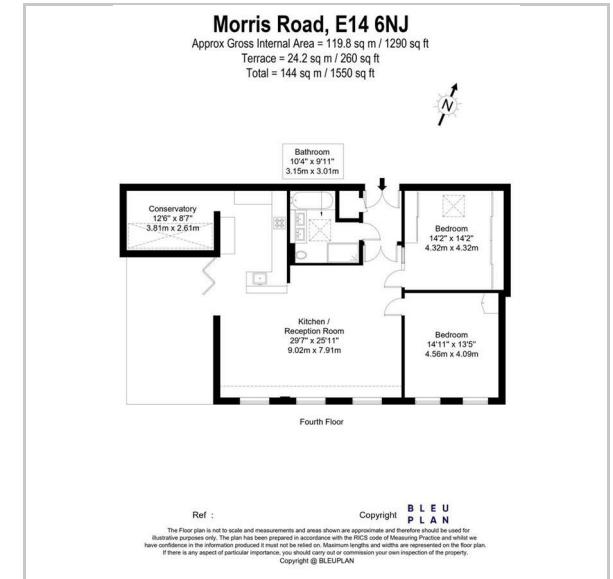

Area Map

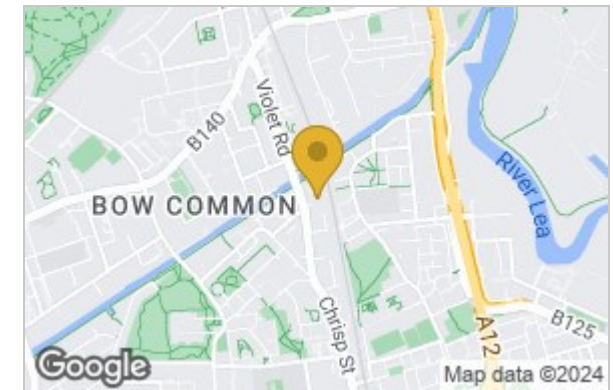

Energy Efficiency Graph

