



Vandome Close  
, London, E16 3NZ

Asking Price £385,000



**MADISON BROOK**  
INTERNATIONAL

# Vandome Close, London, E16 3NZ

Located on the second floor, this bright, two bedroom apartment is pleasantly presented and located moments from the Elizabeth Line.

Situated over 730 Sq. Ft of internal living space, the property comprises two well proportioned double bedrooms, a well maintained family bathroom, a partial open plan living and kitchen area with modern appliances. Additionally, the apartment benefits from a private balcony and built in storage space throughout.

Helena House is located moments from many local amenities, such as, convenience stores, schools and the bars, restaurants that's Royal Victoria Dock has to offer.

For transport, you are within walking distance of Prince Regent Lane & Custom House (DLR & Cross Rail).



These particulars, whilst believed to be accurate are set out as a general outline only for guidance and do not constitute any part of an offer or contract. Intending purchasers should not rely on them as statements of representation of fact, but must satisfy themselves by inspection or otherwise as to their accuracy. No person in this firm's employment has the authority to make or give any representation or warranty in respect of the property.

20 Western Gateway, Royal Victoria Dock, London, E16 1BS

Tel: 020 3946 6000 Email: docklands@madisonbrook.com <https://madisonbrook.com/>

## Floor Plan

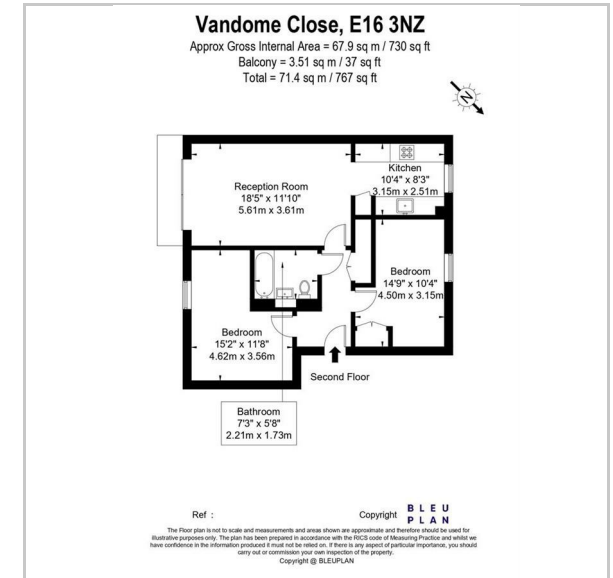

## Area Map

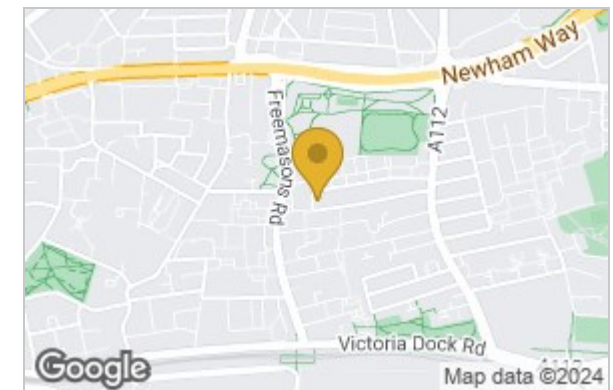

## Energy Efficiency Graph

