



Inverness Mews

North Woolwich, North Woolwich, E16 2SP

Asking Price £415,000

 2  2  1  C

MADISON BROOK
INTERNATIONAL

Inverness Mews, North Woolwich, North Woolwich, E16 2SP

This stunning two bedroom, two bathroom apartment is located on an enviable raised ground floor and boasts beautiful uninterrupted and tranquil river views.

Situated over 728 Sq. Ft of internal living space, the property offers a bright, open plan, living and kitchen area leading to a private balcony where you enjoy the views of the outdoor spaces and the River Thames. The apartment offers two generous sized, double bedrooms with the principle benefiting from a smart, three piece en-suite shower and a further, chic family bathroom. Additionally, the property has ample storage throughout, an allocated secure gated underground parking space and has a share of the freehold.

Inverness Mews is ideally located to many local amenities, along with the large open green space of Royal Victoria Gardens, and is only a short walk away from King George V DLR and the Woolwich Ferry.



These particulars, whilst believed to be accurate are set out as a general outline only for guidance and do not constitute any part of an offer or contract. Intending purchasers should not rely on them as statements of representation of fact, but must satisfy themselves by inspection or otherwise as to their accuracy. No person in this firm's employment has the authority to make or give any representation or warranty in respect of the property.

20 Western Gateway, Royal Victoria Dock, London, E16 1BS
 Tel: 020 3946 6000 Email: docklands@madisonbrook.com <https://madisonbrook.com/>

Floor Plan

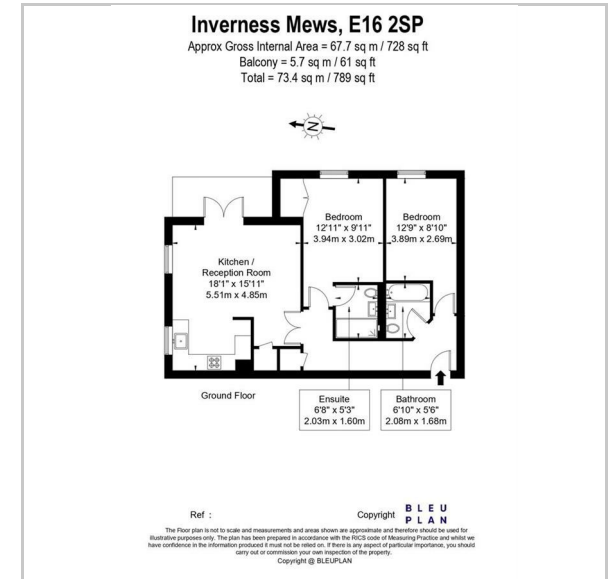

Area Map

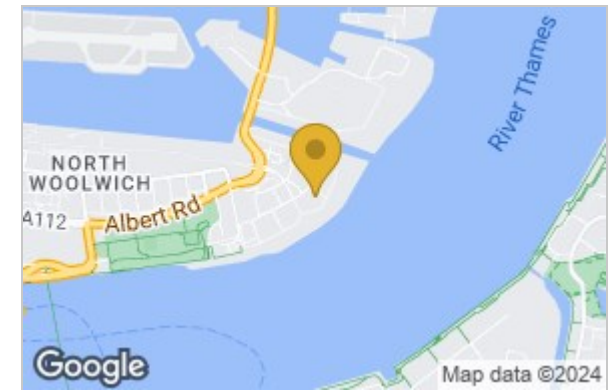

Energy Efficiency Graph

