



The Oxygen Apartments, Royal Victoria
Dock, London, E16 1BL

Offers In The Region Of £525,000

 2  2  1  B

MADISON BROOK
INTERNATIONAL

Floor Plan

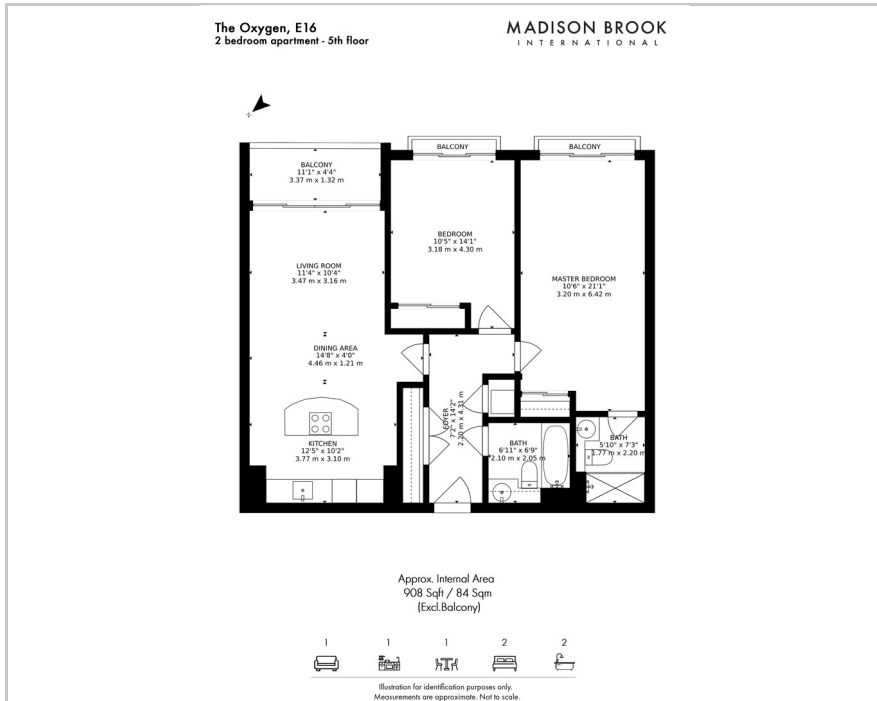

Area Map

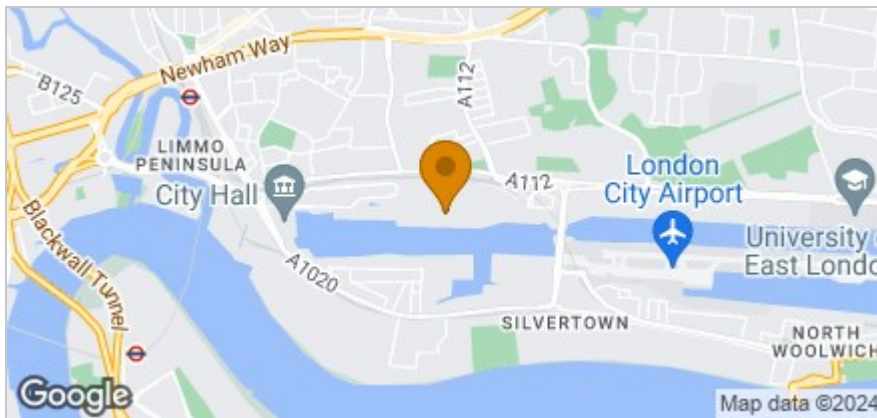

Accommodation

- Two Bedroom Apartment
- 5th Floor Location
- 908 Sq. Ft. Internally
- Stunning Dockside Facing Balcony
- Close to Royal Victoria DLR & The Elizabeth Line
- Service Charge Reviewed Yearly
- Service Charge: £5,000.00 Per Annum
- Ground Rent: £580.00 Per Annum
- Lease Length: 180 Years Remaining
- Council Tax: Band D



Energy Efficiency Graph

Energy Efficiency Rating		Current	Potential
Very energy efficient - lower running costs			
(92 plus) A			
(81-91) B		82	84
(69-80) C			
(55-68) D			
(39-54) E			
(21-38) F			
(1-20) G			
Not energy efficient - higher running costs			
England & Wales		EU Directive 2002/91/EC	

These particulars, whilst believed to be accurate are set out as a general outline only for guidance and do not constitute any part of an offer or contract. Intending purchasers should not rely on them as statements of representation of fact, but must satisfy themselves by inspection or otherwise as to their accuracy. No person in this firm's employment has the authority to make or give any representation or warranty in respect of the property.