



1 Tidal Basin Road  
Royal Victoria Dock, London, E16 1UP  
Offers In Excess Of £380,000



**MADISON BROOK**  
INTERNATIONAL

# 1 Tidal Basin Road, Royal Victoria Dock, London, E16 1UP

Offering a private balcony, resident's gymnasium, 24hr concierge and spacious open plan living, this one bedroom 612 sq. ft. apartment is in the impressive Hoola development.

## The Property

Featuring floor-to-ceiling windows to the open-plan lounge/kitchen, with integrated appliances, double bedroom, chic master bathroom, two utility cupboards & a sizeable private terrace.

## The Development

This development also boasts a private resident's gymnasium & 24hr concierge and is located in the stunning surrounds of Excel Marina, just moments from the Emirates Cable Car, Siemens Crystal & O2 Arena.

## Local Transportation

Royal Victoria (DLR) & Canning Town (Jubilee) are within easy reach, connecting to the City of London & Canary Wharf, whilst the Emirates Cable Car is located opposite the property.



These particulars, whilst believed to be accurate are set out as a general outline only for guidance and do not constitute any part of an offer or contract. Intending purchasers should not rely on them as statements of representation of fact, but must satisfy themselves by inspection or otherwise as to their accuracy. No person in this firm's employment has the authority to make or give any representation or warranty in respect of the property.

20 Western Gateway, Royal Victoria Dock, London, E16 1BS

Tel: 020 3946 6000 Email: docklands@madisonbrook.com <https://madisonbrook.com/>

## Floor Plan

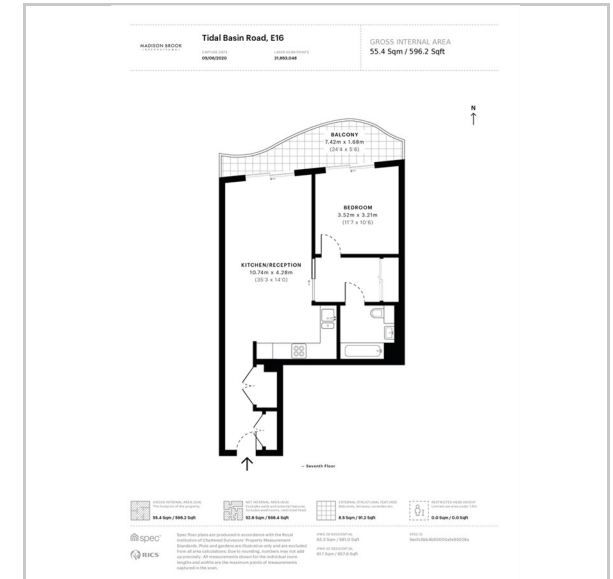

## Area Map

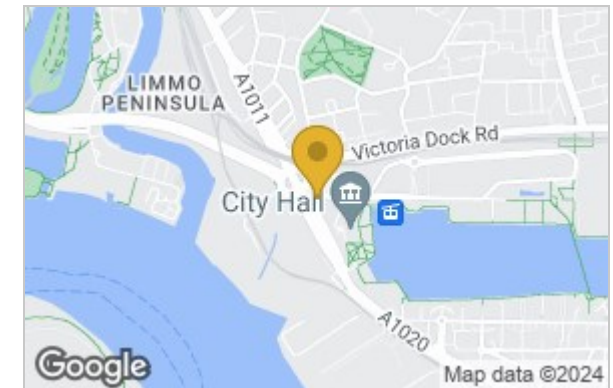

## Energy Efficiency Graph

