



Capital East Apartments

21 Western Gateway, Royal Victoria Dock, E16 1AS

Offers In Excess Of £525,000



MADISON BROOK
INTERNATIONAL

Capital East Apartments, 21 Western Gateway, Royal Victoria Dock, E16 1AS

This superb two-bedroom apartment is located on the 2nd floor & offers a private balcony & superb views out to the Excel Marina & O2 Arena.

Situated over 1,043 sq. ft. internally, the property offers a generous size living area a separate kitchen with modern integrated appliances, two well proportioned double bedrooms with the principal offering an en-suite & a further chic family bathroom. Additionally, the apartment has a secure & gated parking space.

Capital East Apartments is situated perfectly for local bars and restaurants and moments walk from the Emirates Cable Cars and the Excel Exhibition Centre. Additionally, the development has a 24-hour concierge and a residents gym.

Transport links close to the property include The Elizabeth Line (Cross Rail) For the motorist, the property's location provides quick and easy access to the A1020, A12, A13 and Blackwall Tunnel for travel to and from Canary Wharf, the City, and Central London and beyond.



These particulars, whilst believed to be accurate are set out as a general outline only for guidance and do not constitute any part of an offer or contract. Intending purchasers should not rely on them as statements of representation of fact, but must satisfy themselves by inspection or otherwise as to their accuracy. No person in this firm's employment has the authority to make or give any representation or warranty in respect of the property.

20 Western Gateway, Royal Victoria Dock, London, E16 1BS
 Tel: 020 3946 6000 Email: docklands@madisonbrook.com <https://madisonbrook.com/>

Floor Plan

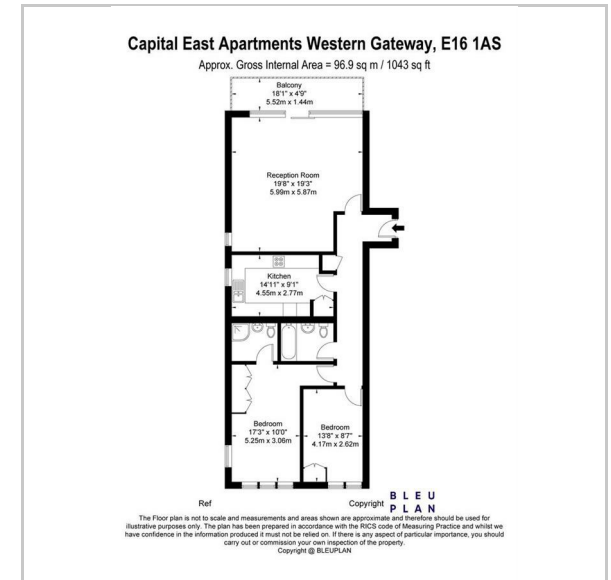

Area Map

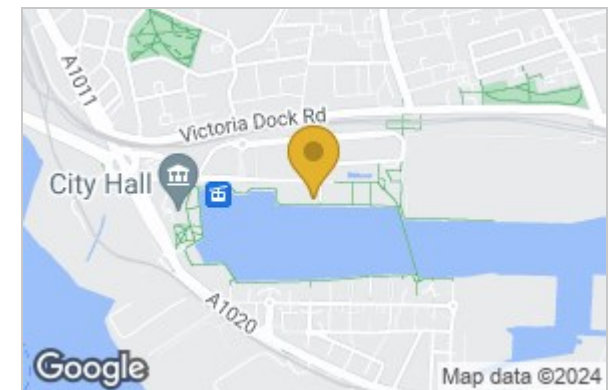

Energy Efficiency Graph

