



## Adriatic Apartments

20 Western Gateway, Royal Victoria Dock, E16 1BU

Offers In Excess Of £625,000



**MADISON BROOK**  
INTERNATIONAL

# Adriatic Apartments, 20 Western Gateway, Royal Victoria Dock, E16 1BU

\*\*GUIDE PRICE £650,00-£675,000\*\*

This stunning two bedroom penthouse apartment boasts a sizable terrace, modern accommodation that is spaciouly arranged over two floors and a luxury specification.

Light and airy throughout and boasting floor-to-ceiling windows the property comprises impressive reception room with access to the generous terrace, top of the range open-plan kitchen with dining room, beautiful principle bedroom with en suite bathroom, second double bedroom, cloakroom, generous entrance hall and landing and views that take in the the dramatic skyline of Canary Wharf, gated off-street parking and 24hr concierge.

Adriatic Apartments is ideally located for enjoyment of the beautiful Thames Barrier Park, the river promenade and the local Royal Docks, while the shops of Canary Wharf are within easy reach.

Local transport links include Royal Victoria & The Elizabeth Line (Cross Rail) The North Woolwich ferry crossing and a variety of useful A roads for those travelling by road.



These particulars, whilst believed to be accurate are set out as a general outline only for guidance and do not constitute any part of an offer or contract. Intending purchasers should not rely on them as statements of representation of fact, but must satisfy themselves by inspection or otherwise as to their accuracy. No person in this firms employment has the authority to make or give any representation or warranty in respect of the property.

20 Western Gateway, Royal Victoria Dock, London, E16 1BS

Tel: 020 3946 6000 Email: docklands@madisonbrook.com <https://madisonbrook.com/>

## Floor Plan

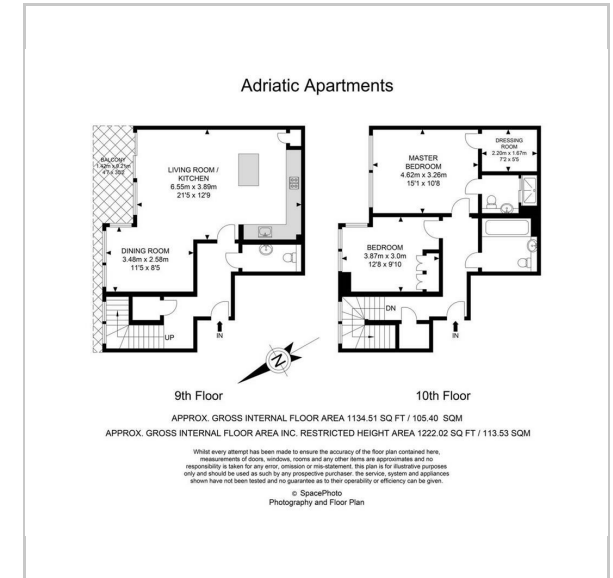

## Area Map

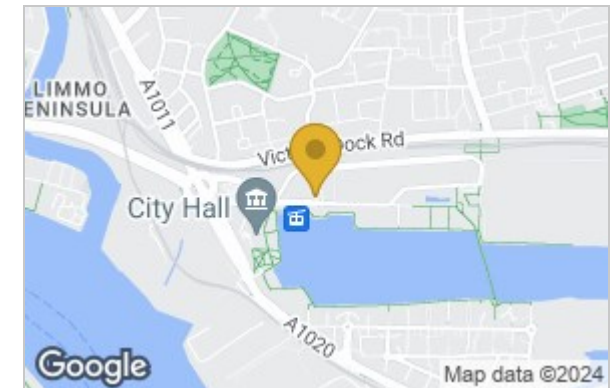

## Energy Efficiency Graph

