



1 Tidal Basin Road
Royal Victoria Dock, London, E16 1US
Offers In Excess Of £400,000



MADISON BROOK
INTERNATIONAL

1 Tidal Basin Road, Royal Victoria Dock, London, E16 1US

This stunning 12th floor, 612 sq. ft. apartment is overlooking Canary Wharf & the City of London & boasts a private balcony.

Featuring floor-to-ceiling windows to the open-plan lounge/kitchen, with integrated appliances, double bedroom, chic master bathroom, two utility cupboards & a sizeable private terrace. This development also boasts a private resident's gymnasium & 24hr concierge.

Hoola Development is located in the stunning surrounds of Excel Marina, just moments from the Emirates Cable Car, Siemens Crystal & O2 Arena. Royal Victoria (DLR) & The Elizabeth Line (Cross Rail) are within easy reach, connecting to the City of London & Canary Wharf.



These particulars, whilst believed to be accurate are set out as a general outline only for guidance and do not constitute any part of an offer or contract. Intending purchasers should not rely on them as statements of representation of fact, but must satisfy themselves by inspection or otherwise as to their accuracy. No person in this firm's employment has the authority to make or give any representation or warranty in respect of the property.

20 Western Gateway, Royal Victoria Dock, London, E16 1BS

Tel: 020 3946 6000 Email: docklands@madisonbrook.com <https://madisonbrook.com/>

Floor Plan

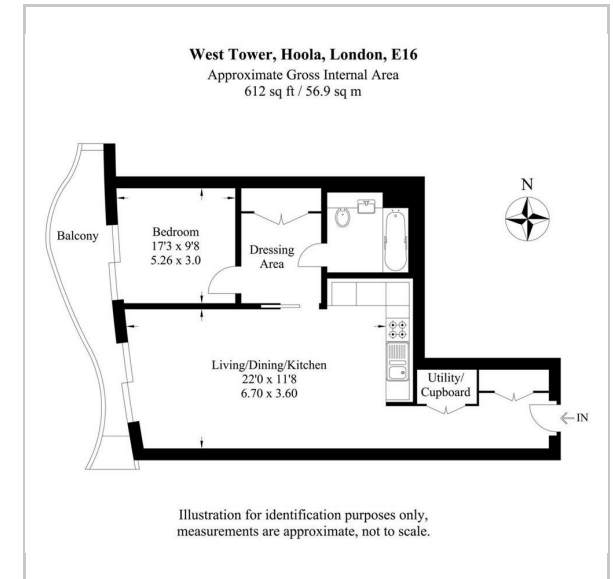

Area Map

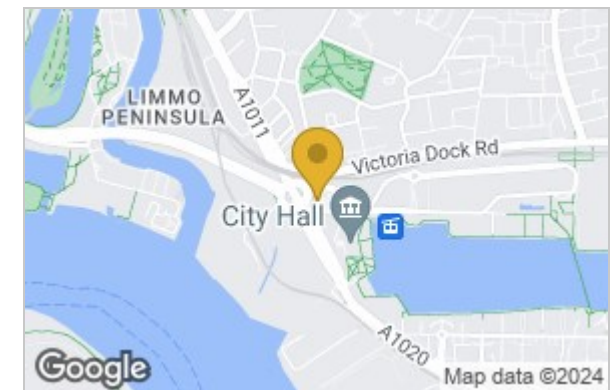

Energy Efficiency Graph

