



## The Reflection

2 Woolwich Manor Way, North Woolwich, E16 2GD

Asking Price £385,000



**MADISON BROOK**  
INTERNATIONAL

# The Reflection, 2 Woolwich Manor Way, North Woolwich, E16 2GD

**\*\*RECENTLY REDUCED\*\***

This exquisite & luxurious three-bedroom, two-bathroom apartment has recently undergone some internal refurbishment and is offered to the market in great condition & benefits from delightful views of the River Thames & Victoria Gardens.

Features include floor to ceiling windows making it bright and airy throughout, an open plan kitchen with a separate island, a spacious lounge with extra high ceilings and equally spacious bedrooms, with the principal offering a chic en suite shower room. The Reflection is a gated development and hosts one secure parking bay whilst also being situated on the River Thames & is within just a minutes walk to the well maintained and picturesque Victoria Gardens.

Conveniently situated for London City Airport, Local transport links also include King George V (DLR) & Gallions Reach (DLR) stations, with a selection of A roads linking The City & the M25 just moments away.



These particulars, whilst believed to be accurate are set out as a general outline only for guidance and do not constitute any part of an offer or contract. Intending purchasers should not rely on them as statements of representation of fact, but must satisfy themselves by inspection or otherwise as to their accuracy. No person in this firm's employment has the authority to make or give any representation or warranty in respect of the property.

20 Western Gateway, Royal Victoria Dock, London, E16 1BS  
 Tel: 020 3946 6000 Email: docklands@madisonbrook.com <https://madisonbrook.com/>

## Floor Plan

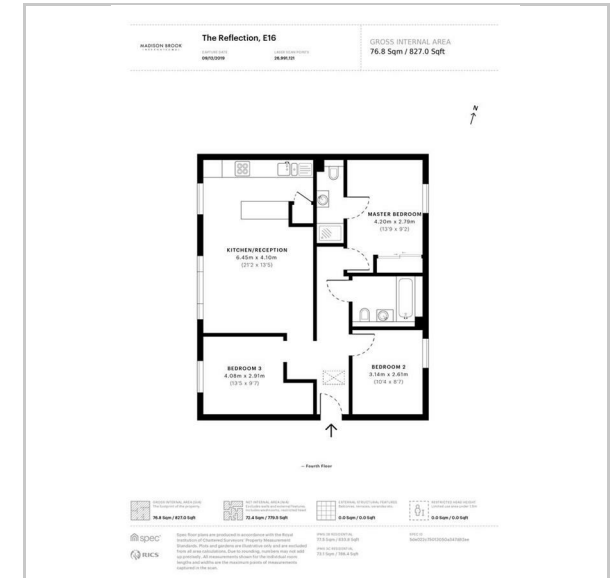

## Area Map

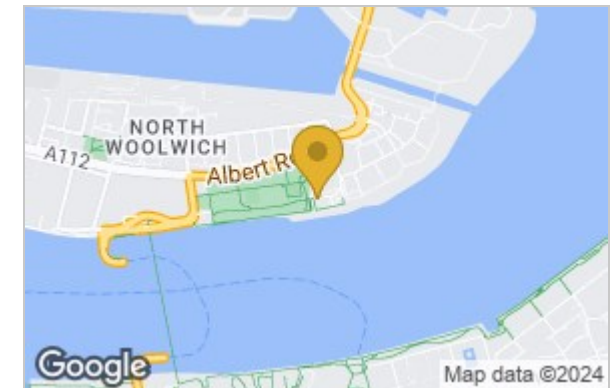

## Energy Efficiency Graph

