



Gorsey Lane, Great Wyrley
Walsall, WS6 6HJ

Offers in the Region Of £150,000

Great Wyrley

Offers in the Region Of £150,000

2  1  1 

Paul Carr Estate Agents are pleased to market this excellent two bedroom property ideal as a first purchase and suitable as a buy-to-let investment. Located in the village of Great Wyrley the property comprises of an entrance porch, modern kitchen and an open plan living/dining room with French doors opening to the decked patio. To the first floor are two double bedrooms and a modern bathroom. The low maintenance rear garden has gates providing parking at the rear and the property has a single garage en-bloc. Viewings are available immediately so contact Paul Carr Great Wyrley today!





Agent's Note:

Every care has been taken with the preparation of these Sales Particulars but they are for general guidance only and complete accuracy cannot be guaranteed. If there is any point which is of particular importance, professional verification should be sought. The mention of any fixtures, fittings and/or appliances does not imply they are in full efficient working order as they have not been tested. All dimensions are approximate. Photographs are reproduced for general information and it cannot be inferred that any item shown is included in the sale. These Sales Particulars do not constitute a contract or part of a contract.
Came on the market: 6th July 2023

Property Specification

Ideal First Purchase
Suitable Buy-to-Let Investment
Close to Schools and Shops in the Village
Close to Landywood Train Station
Rear Garden with Gated Access for Parking

Viewer's Note:

Services connected:
Council tax band: A
Tenure: Leasehold years remaining, lease from
Ground Rent: £0
Service Charge: £0
Restrictions:

Floor Plan

This floor plan is not drawn to scale and is for illustration purposes only

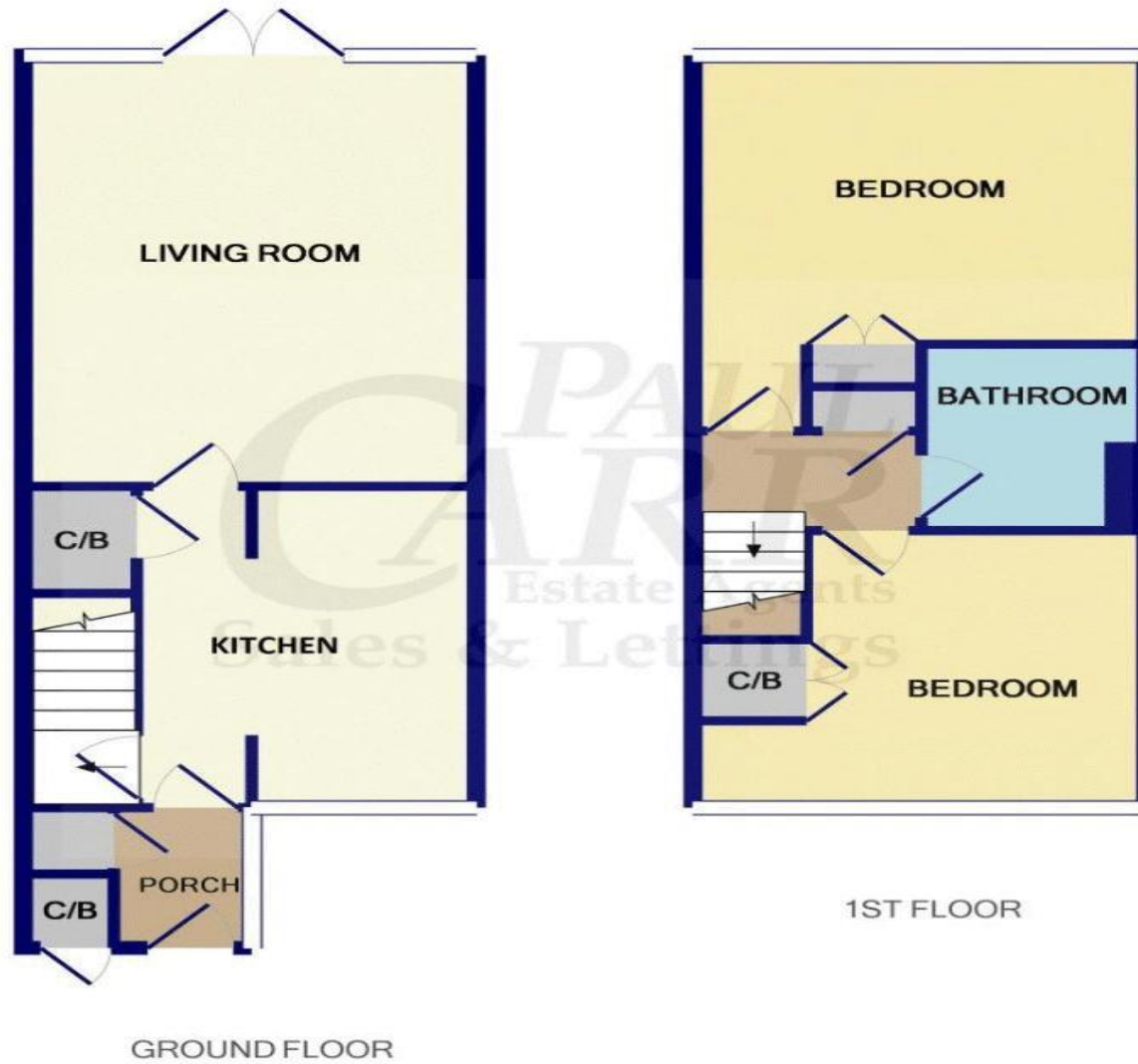

Energy Efficiency Rating

Score	Energy rating	Current	Potential
92+	A		
81-91	B		89 B
69-80	C	75 C	
55-68	D		
39-54	E		
21-38	F		
1-20	G		

Map Location